

**FITS DOORS 1-3/4" THICK • BACKSET 2-3/4"**

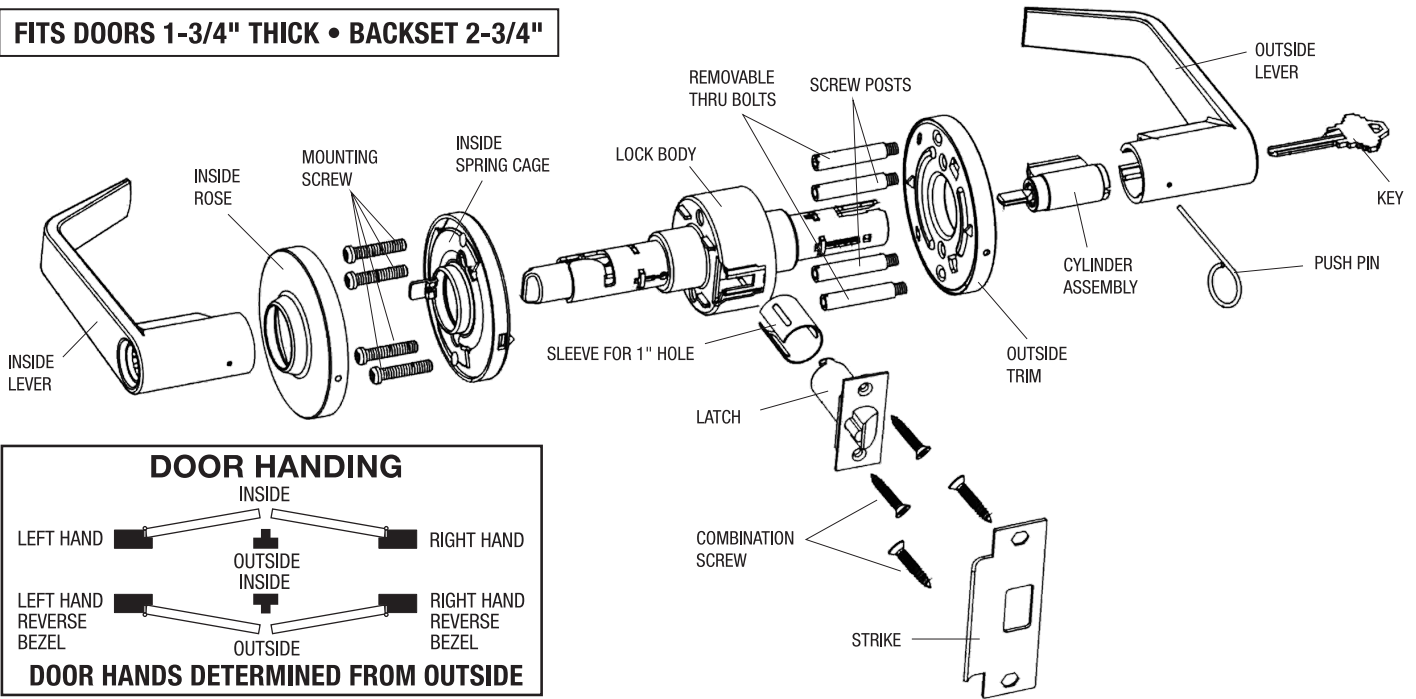

**DOOR HANDING**

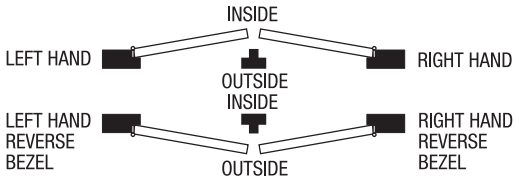

**NEW DOOR PREPARATION**

1. Fold template on edge of door and mark holes.
2. Drill a 2-1/8" hole.
3. Drill two 3/8" thru bolt holes through face of door. (only if the thru bolts are being used).
4. Drill a 1" hole in edge of door.
5. Cut 5/32" notches on 2-1/8" hole on both sides of door. (very important if not using thru bolts)
6. Mortise door edge 2-1/4" x 1-1/8" x 1/8" for 2-3/4" backset or 2-1/4" x 1" x 1/8" for the optional 2-3/8" backset.

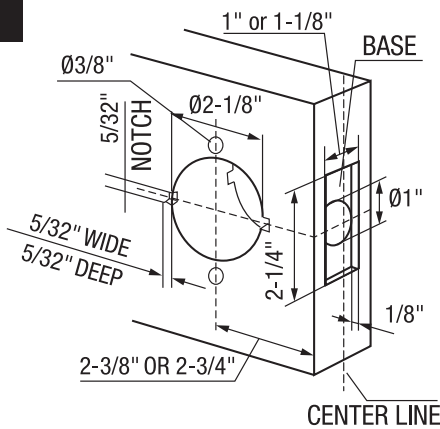

**1 DISASSEMBLE INSIDE LEVER**

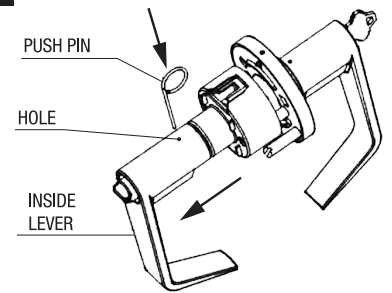

**1A:** Insert push pin into hole to depress catch and remove the lever.

**2 INSTALL LEVERSET TO DOOR**

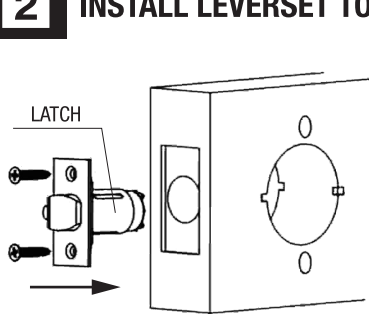

**2A:** Insert latchbolt and secure with combination screws.

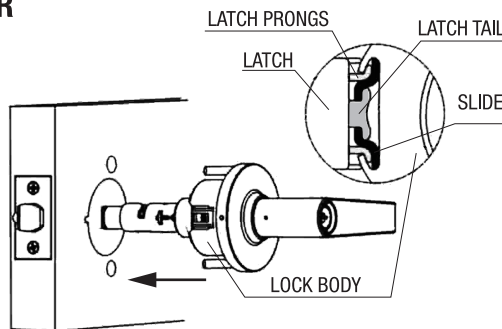

**2B:** Place lock body into position. Make sure the latch prongs engage chassis in housing, and slide engages latch tail.

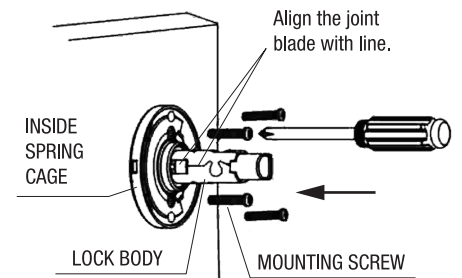

**2C:** Install inside spring cage and tighten screws.

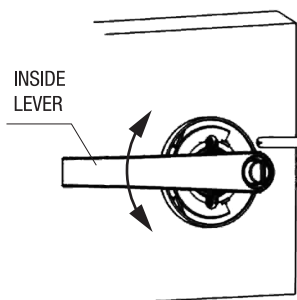

**2D:** Slide inside lever onto spindle and check to see if the rotation is smooth. Adjust the radial clearance between inside spring cage and inside lever if necessary.

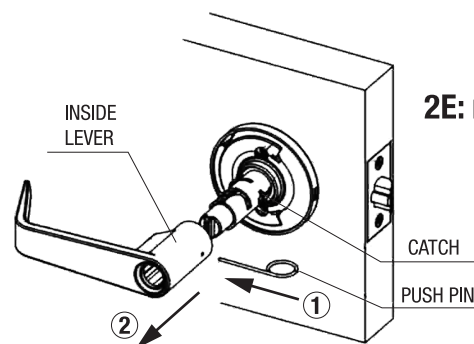

**2E:** Remove inside lever using push pin.

## 2 INSTALL LEVERSET TO DOOR (Continued)

Align dimples on rose with rectangular hole in spring cage. Push rose until dimples snap into rectangular hole.

INSIDE SPRING CAGE

### IMPORTANT!

If the door is thicker than 2", the catch will be covered by inside rose. Do not install inside lever and lock.

CATCH

INSIDE ROSE

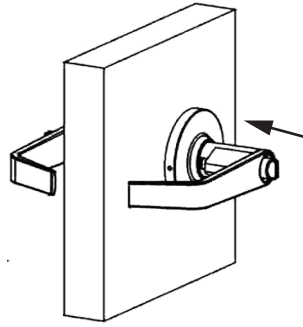

**2G:** Slide lever onto spindle. Push lever completely into place. (Pull on lever to make sure that catch is fully engaged.)

**2F:** Install inside rose and make sure inside rose and inside spring cage are tightened.

## 3 INSTALL STRIKE

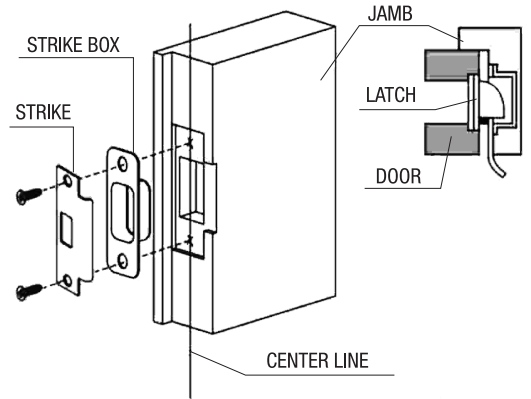

## 4 INSTRUCTIONS FOR REMOVING AN INSTALLED LOCK FROM THE DOOR

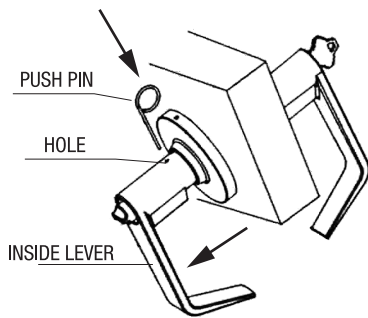

**4A:** Insert push pin into hole to depress catch and remove lever.

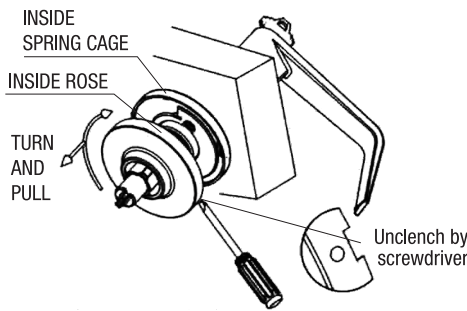

**4B:** Remove inside rose by turning and pulling off.

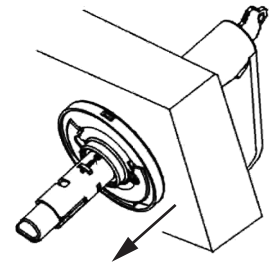

**4C:** Remove mounting screw with screwdriver and inside spring cage.

## 5 INSTRUCTIONS FOR ADJUSTING LOCK TO FIT DOOR THICKNESS OTHER THAN 1-3/4"

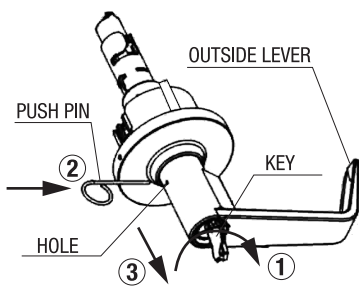

**5A:** Turn key 75° clockwise. Insert push pin into hole in outside lever to depress catch. Remove the outside lever.

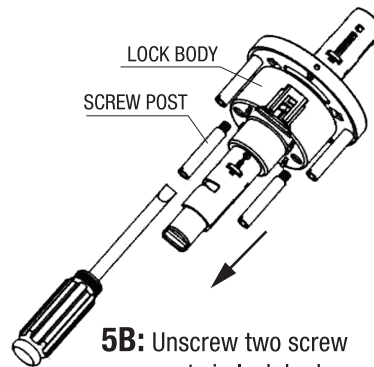

**5B:** Unscrew two screw posts in lock body with screwdriver.

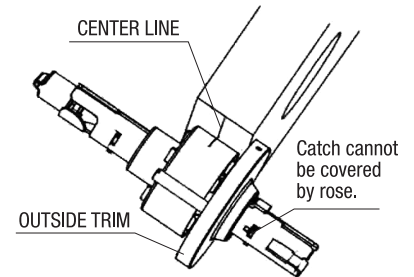

**5C:** Adjust outside trim according to the door thickness. Make sure the lock body at both sides is symmetrical.

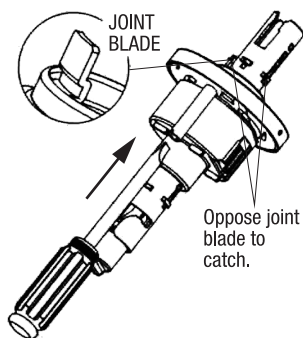

**5D:** Tighten screw posts again so they hold the outside rose tightly.

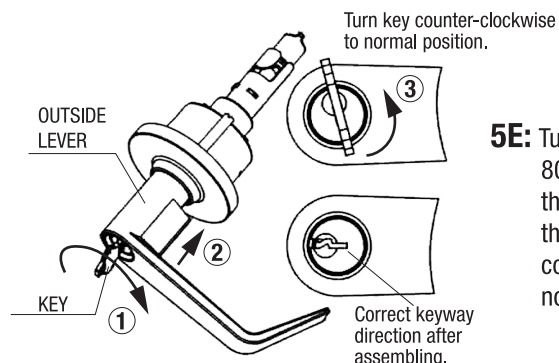

**5E:** Turn key approximately 80° clockwise and push the lever all the way onto the spindle. Turn key counter-clockwise to normal position.