

# INSTALLATION INSTRUCTIONS — HEAVY DUTY DOOR CLOSER & FLEXPLATE®

**CAUTION!** An incorrectly installed or improperly adjusted door closer can cause property damage or personal injury. These instructions should be followed to avoid the possibility of misapplication or misadjustment.

**Sizes 1-6**

## Tools You Will Need:

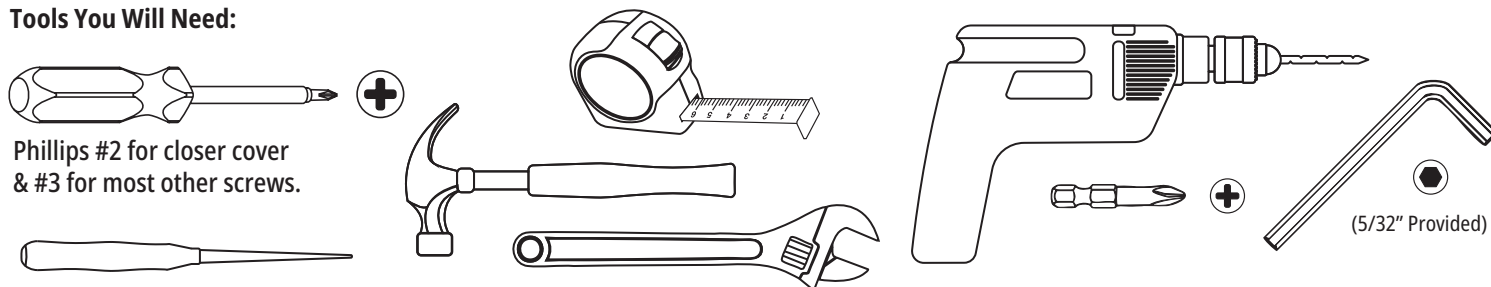

## Important Notes:

- It is recommended that the door be hung on ball bearing type hinges so door swings freely.
- Door and frame must be properly reinforced or through bolts used to prevent the mounting screws from pulling out.

## Parts List:

**A** - Closer Body

**B** - Door Closer Cover

**C** - Flexplate (refer to separate instructions for use)

**C2** - Mounting Sliders

**D** - Closer Arm Assembly

**H** - Parallel Arm Plate

**F** - Screw & Washer Packs

## Includes:

- F1** - Flat Hd Self-Tapping Screw #14 1-1/4" (x4) **F7** - Flat Hd Machine Screw M4-.07x5/16" (x2)  
**F2** - Flat Hd Machine Screw 1/4-20 x 3/4" (x4) **F8** - Through Bolt 1/4-20x1-11/16" (x4)  
**F3** - Oval Hd Machine Screw 1/4-20 x 7/16" (x4) **F9** - Hex Hd Machine Screw/Washer 1/4-20x5/8" (x4)  
**F4** - Pan Hd Machine Screw 1/4-20 x 7/8" (x4) **F10** - 1/4" ID Washer Ø .709 (18mm)x.080" (x1)  
**F5** - Pan Hd Self-Tapping Screw #14 1-1/4" (x8) **F11** - 1/4" ID Washer Ø .630(16mm)x.080" (x1)  
**F6** - Pan Hd Machine Screw 1/4-20 x 7/8" (x4) **F12** - 1/4" ID Lock Washer Ø .630 (x1)

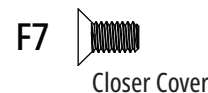
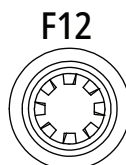
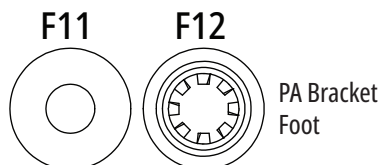
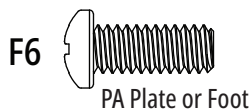
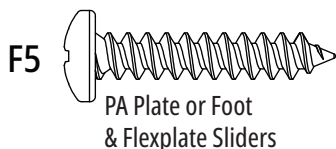
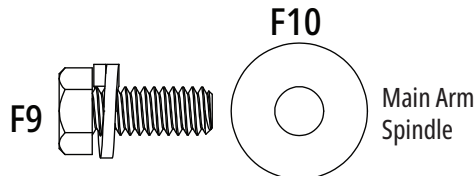
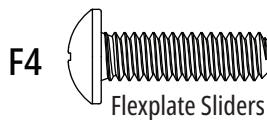
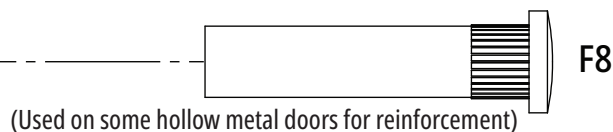
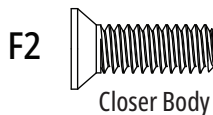
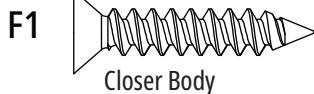
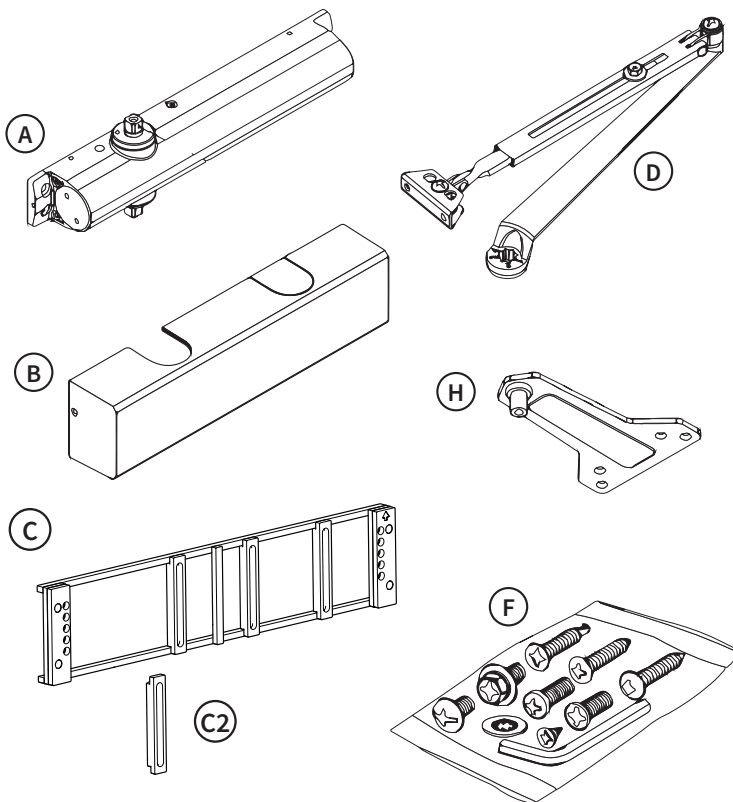

## Closer Mounting Position Selection & Preparation

If replacing old closer, it is recommended that the same mounting position be used, if the hole pattern matches and is in correct location.

**Use mounting holes on new closer to check hole locations, and verify with diagram on selected mounting page. Pages shown below.**

**Note:** Flexplate may be used to avoid drilling new holes. Use provided instructions to install Flexplate, if needed.

### Regular Arm Installation

continue to **Page 3**

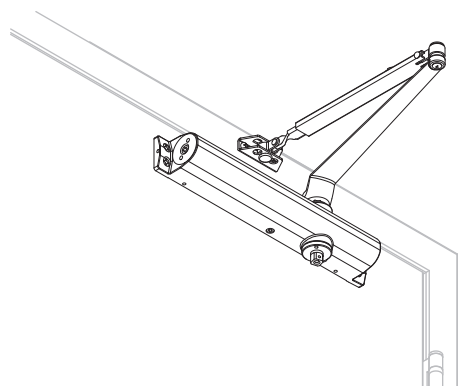

(Left hand door shown)

Closer mounts on hinge side of door  
(pull side)

### Top Jamb Installation

continue to **Page 5**

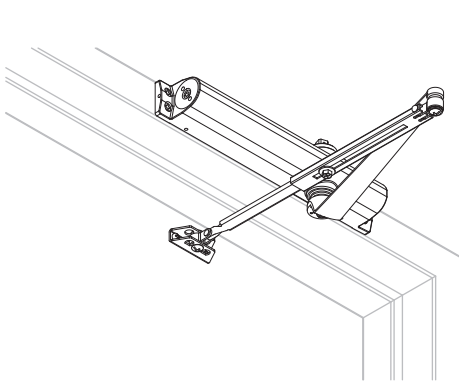

(Right hand door shown)

Closer mounts on frame, opposite hinge side of door  
(push side)

### Parallel Arm Installation

continue **Below** to remove Foot

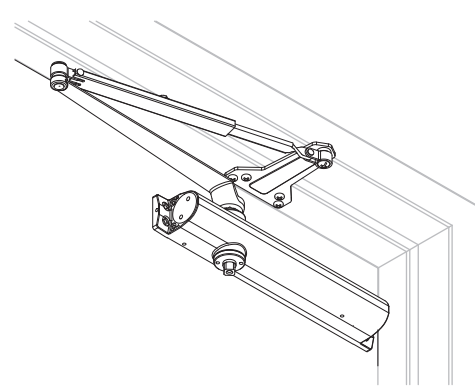

(Right hand door shown)

Closer mounts on door, opposite hinge side of door  
(push side)

## Fastener Preparation Guide

Door or Frame Type	Application	Fastener	Drill Bit Size	Drill Depth
Hollow Metal or Aluminum	Closer & Parallel Arm Plate / Foot	#14 Self-Tapping Screw	3/16" Drill Bit	Only one side
		1/4"-20 Machine Screw	#7 (.201") Drill Bit & 1/4"-20 Tap	
Hollow Metal or Aluminum	Closer Only	1/4"-20 Machine Screw with Through Bolt	Closer Side 9/32" Drill Bit	9/32" Through Door 3/8" 1-5/8" Deep
Wood			Opposite Side 3/8" Drill Bit	
Wood	Closer & Parallel Arm Plate / Foot	#14 Self-Tapping Screw	1/8" Drill Bit - Soft Wood	1-1/4"
			3/16" Drill Bit - Hard Wood	

## Parallel Arm Preparation

Follow steps below to remove forearm mounting foot, and then proceed to **Page 7** to finish Parallel Arm mount installation.

**1**

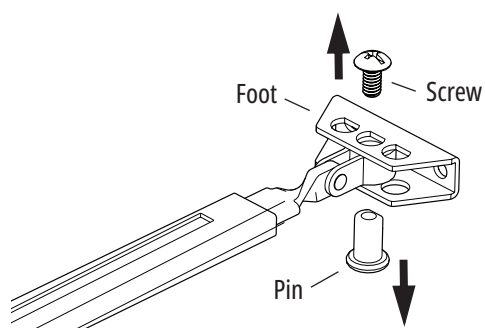

- Remove forearm foot screw and pin.

**Note: DO NOT DISCARD.** Screw will be used to finish installation.

**2**

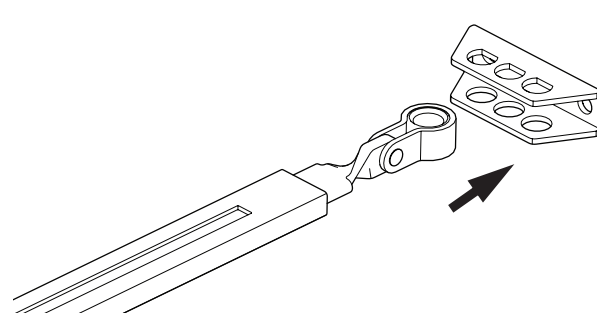

- Slide foot off of forearm.
- Proceed to **Page 7** to finish Parallel Arm installation.

# Regular Arm Mounting Instructions

**Note:** Closer mounts on hinge side of door (pull side).

**For Adjustments and Troubleshooting issues, please refer to pages 9 & 10.**

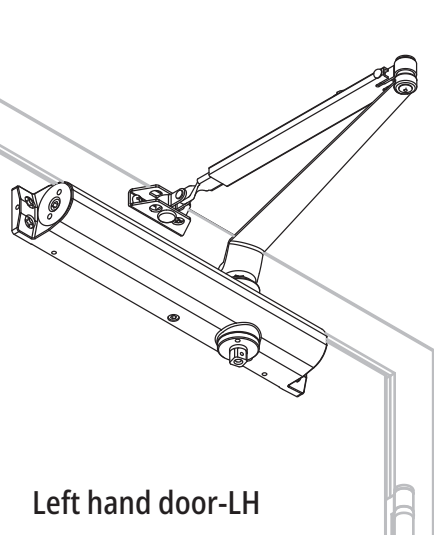

Left hand door-LH

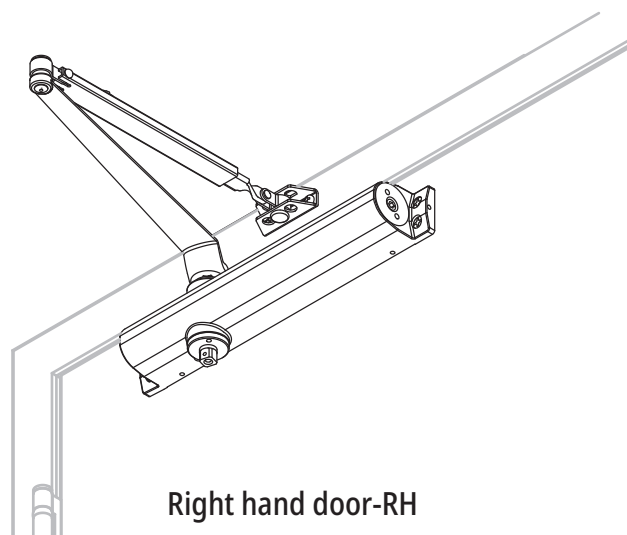

Right hand door-RH

## Location Measurements & Power Adjustments

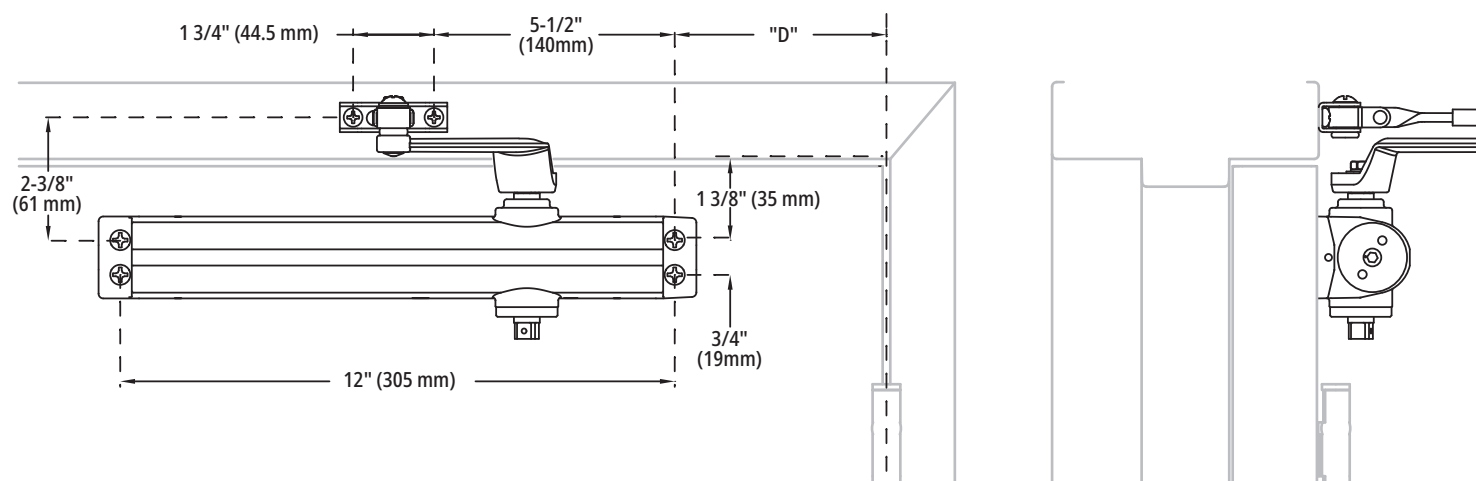

**Note:** Closer is preset with 11 turns of power adjustment, and has a maximum of 26 turns for power adjustment.

Door Width		Opening	Dimension (D) From Center Line of Hinge	Power Adjustment Turns		Power Adjustment Turns	
Interior	Exterior			Size		Size	
UP TO 60" (1524mm)	UP TO 48" (1219mm)	TO 100°	7-1/2" (191mm)	6	+12	3	0
				5	+9	2	-5
				4	+4	1	-9
UP TO 60" (1524mm)	UP TO 48" (1219mm)	TO 130°	6" (152mm)	6	+14	3	0
				5	+10	2	-4
				4	+5	1	-9
UP TO 54" (1321mm)	UP TO 42" (1067mm)	TO 180°	4-1/2" (114mm)	5	+10	3	0
				4	+5	2	-5
						⚠	-10/-11

## Regular Arm Mounting Instructions Continued

For new installation, begin with step 1 below. For replacement installation, ensure you follow separate Flexplate instructions, then proceed to Step 2 below.

1

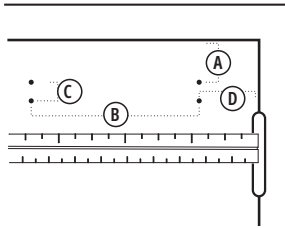

- A) 1-3/8" (35mm)
- B) 12" (305mm)
- C) 3/4" (19mm)
- D) 4-1/2" (114mm)  
6" (152mm)  
7-1/2" (191mm)

- Using diagram and chart on page 3, locate closer mounting hole positions on door.
- Note:** (D) is the distance from the center line of the hinge, determined by door's opening degree.
- Using proper drill bit and depth from Fastener Preparation Guide (Page 2), drill hole locations.

2

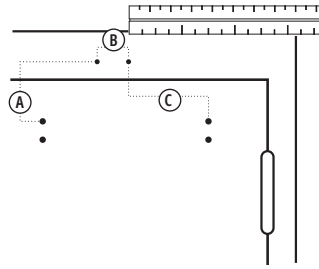

- A) 2-3/8" (61mm)
- B) 1-3/4" (44.5mm)
- C) 5-1/2" (140mm)

- Using diagram and chart on page 3, locate foot mounting hole positions on frame.
- Using proper drill bit and depth from Fastener Preparation Guide (Page 2), drill hole locations.

3

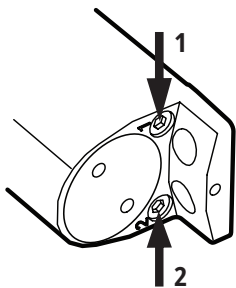

- Locate speed regulating valves on closer labeled 1 and 2.

4

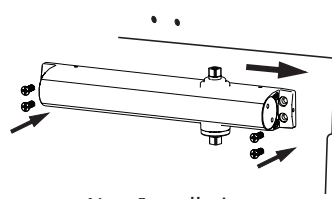

New Installation

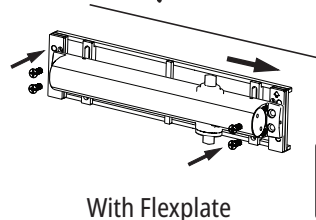

With Flexplate

- Install closer, with speed regulating valves facing door hinges, using prepared holes on door, with 4 flathead screws (**F1**, **F2** or **F2** & **F8**). Reference fastener preparation.
- If using Flexplate:** Install closer to holes that align with hole locations specified in step 1, using 4 machine screws (**F3** or **F3** & **F8**) provided.

5

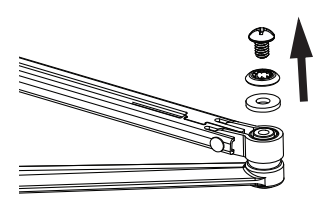

- Remove main arm elbow screw, lockwasher and washer.
- Separate main arm from forearm.

6

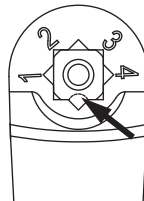
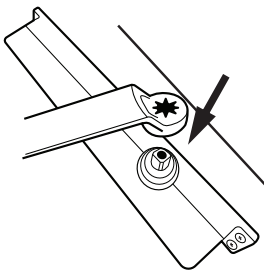

- Install closer's main arm onto top spindle of closer body.
- Note:** Ensure pinion dimple is aligned as shown above.

7

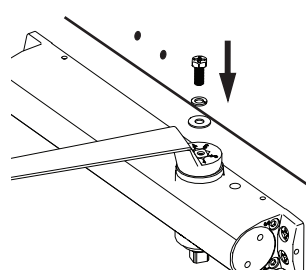

- Secure main arm into place using a main arm screw with lock washer (**F9**) and flat washer (**F10**).

8

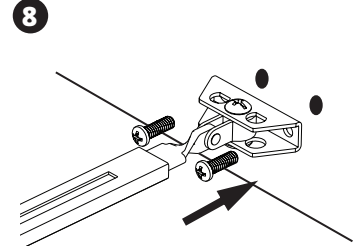

- Install foot to prepared holes in frame using 2 provided pan head screws. (**F5** or **F6**) Reference door preparation.

9

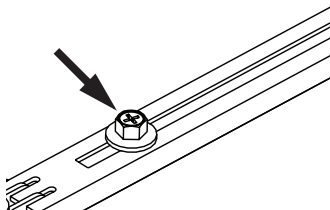

- Loosen arm adjustment screw.

10

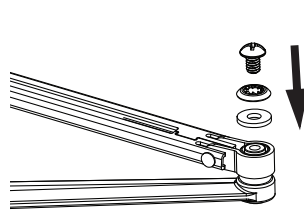

- Re-attach main arm to forearm and install main arm screw/washer set.

11

Left Hand Swing Shown

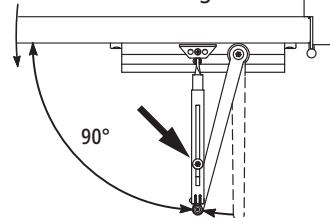

- Adjust arm into position.
- Note:** Forearm should form a 90° angle with door.
- Tighten arm adjustment screw.

12

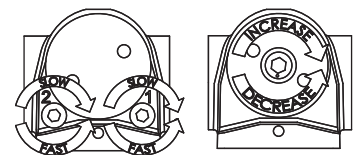

- Proceed to Adjustments and Final Steps section on **Page 9**.

## Top Jamb Mounting Instructions

**Note:** Closer mounts on frame, opposite hinge side of door (push side).  
**For Adjustments and Troubleshooting issues, please refer to pages 9 & 10.**

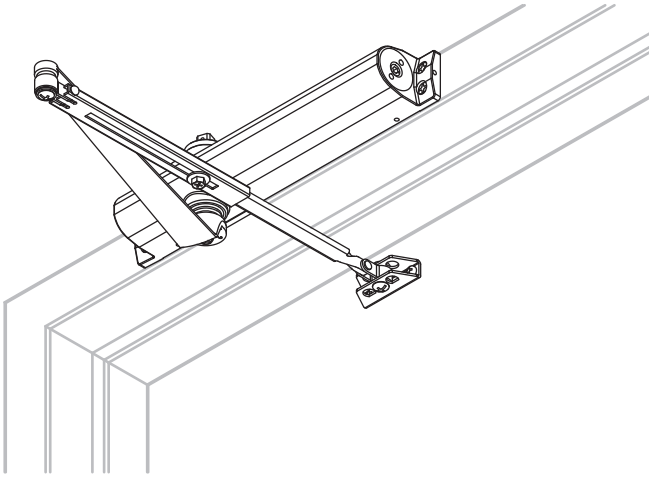

Left hand door-LH

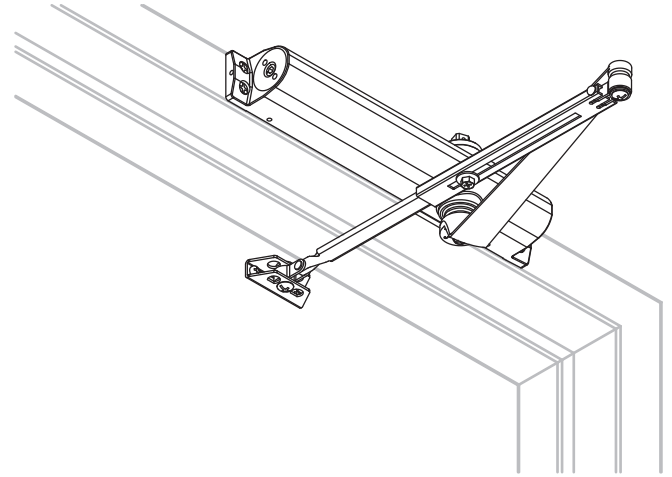

Right hand door-RH

## Location Measurements & Power Adjustments

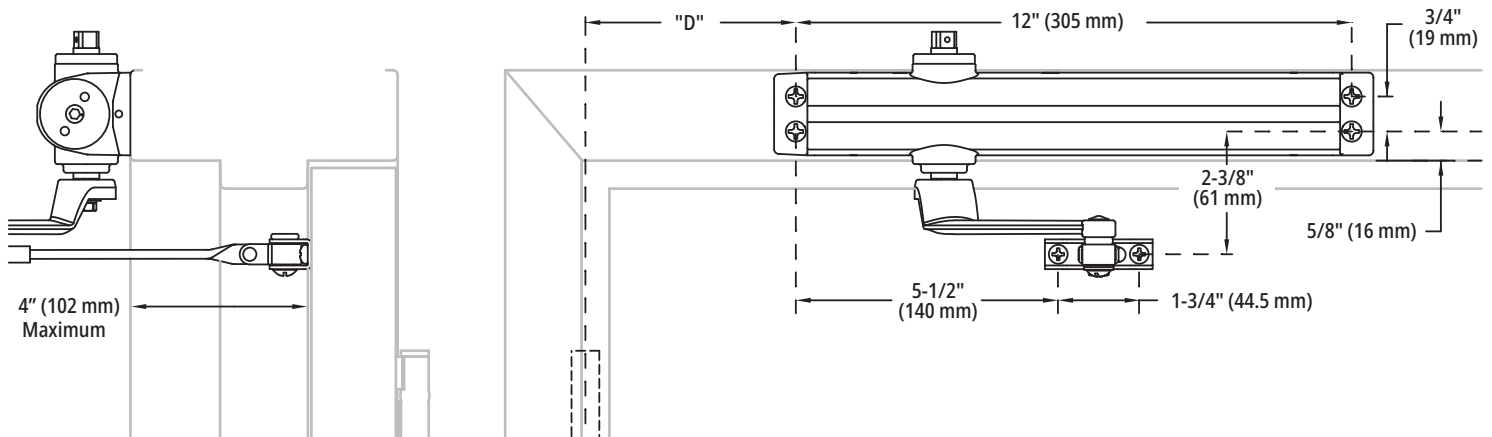

**Note:** Closer is preset with 11 turns of power adjustment, and has a maximum of 26 turns for power adjustment.

Door Width		Opening	Dimension (D) From Center Line of Hinge	Power Adjustment Turns		Power Adjustment Turns	
Interior	Exterior			Size		Size	
UP TO 60" (1524mm)	UP TO 48" (1219mm)	TO 100°	7-1/2" (191mm)	6	+12	3	0
				5	+9	2	-5
				4	+4	1	-9
UP TO 60" (1524mm)	UP TO 48" (1219mm)	TO 130°	6" (152mm)	6	+14	3	0
				5	+10	2	-4
				4	+5	1	-9
UP TO 54" (1321mm)	UP TO 42" (1067mm)	TO 180°	4-1/2" (114mm)	5	+10	3	0
						2	-5
				4	+5	⚠	-10/-11

## Top Jamb Mounting Instructions Continued

For new installation, begin with step 1 below.

**Note:** The Flexplate is not recommended for Top Jamb installations. It is meant for door installations and hole relocation, not for use on frames.

1

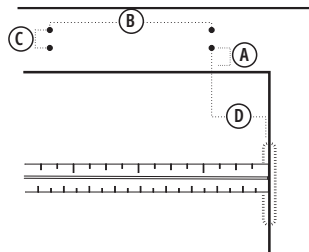

- A) 5/8" (16mm)
- B) 12" (305mm)
- C) 3/4" (19mm)
- D) 4-1/2" (114mm)
- 6" (152mm)
- 7-1/2" (191)

- Using diagram and chart on page 5, locate closer mounting hole positions on frame.

**Note:** (D) is the distance from the center line of the hinge, determined by door's opening degree.

- Using proper drill bit and depth from Fastener Preparation Guide (Page 2), drill hole locations.

2

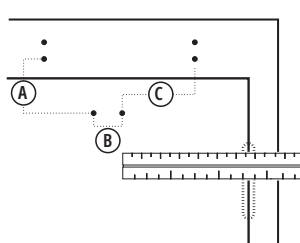

- A) 2-3/8" (61mm)
- B) 1-3/4" (44.5mm)
- C) 5-1/2" (140mm)

- Using diagram and chart on page 5, locate foot mounting hole positions on door.
- Using proper drill bit and depth from Fastener Preparation Guide (Page 2), drill hole locations.

3

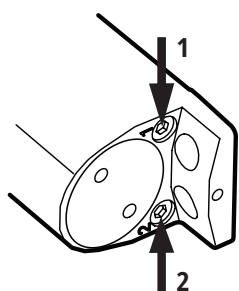

- Locate speed regulating valves on closer labeled 1 and 2.

4

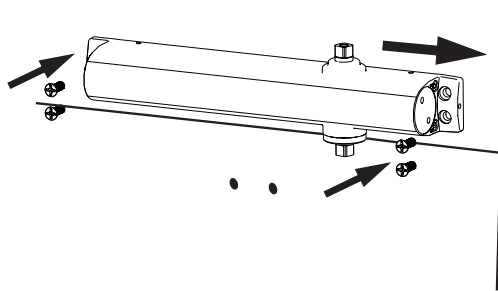

- Install closer, with speed regulating valves facing door hinge edge of door, using prepared holes on door frame, with 4 flathead screws (**F1** or **F2**). Reference fastener preparation.

5

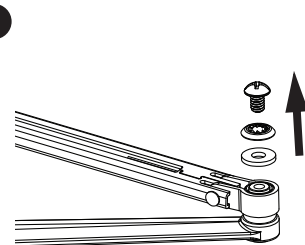

- Remove main arm elbow screw, lockwasher and washer.
- Separate main arm from forearm.

6

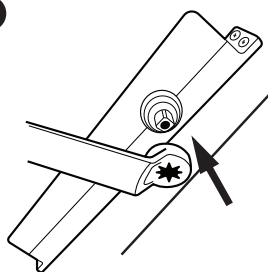

- Install closer's main arm onto top spindle of closer.

**Note:** Ensure pinion dimple is aligned as shown above.

7

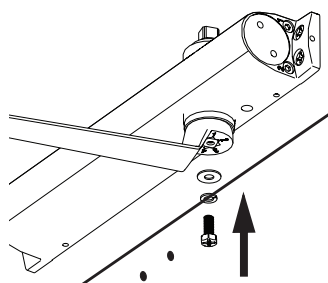

- Secure main arm into place using a main arm screw with lock washer (**F9**) and flat washer (**F10**).

8

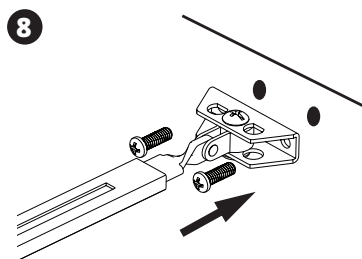

- Install foot to prepared holes in frame using 2 provided screws (**F5, F6 or F6 & F8**). Reference fastener preparation.

9

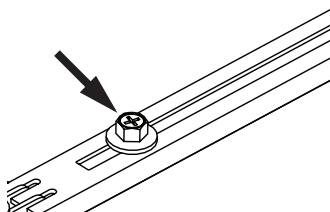

- Loosen arm adjustment screw.

10

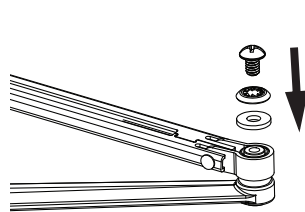

- Re-attach main arm to forearm and install main arm screw/washer set.

11

Right Hand Swing Shown

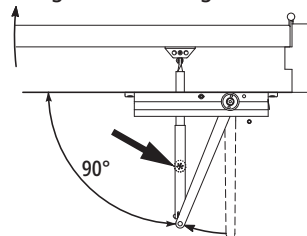

- Adjust arm into position.
- Note:** Forearm should form a 90° angle with door.
- Tighten arm adjustment screw.

12

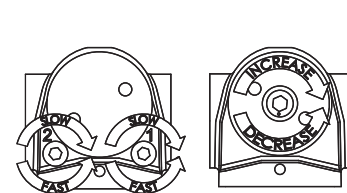

- Proceed to Adjustments and Final Steps section on **Page 9**.

# Parallel Arm Mounting Instructions

**Note:** Closer mounts on door, opposite hinge side (push side).  
**For Adjustments and Troubleshooting issues, please refer to pages 9 & 10.**

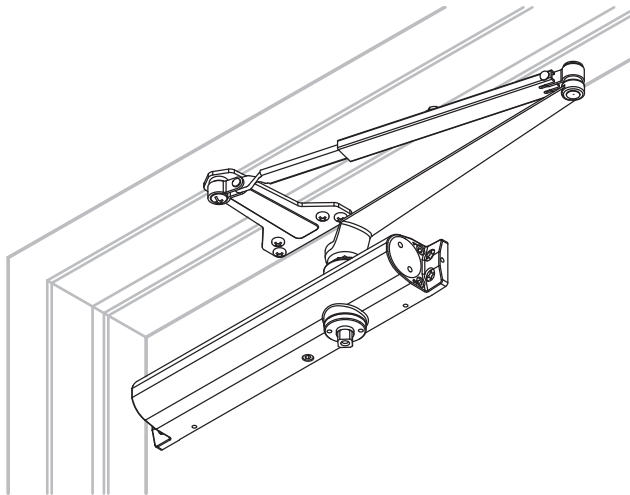

Left hand door-LH

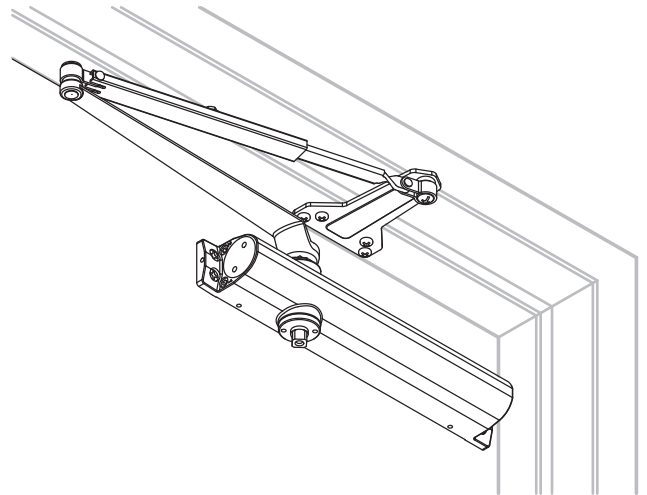

Right hand door-RH

## Location Measurements & Power Adjustments

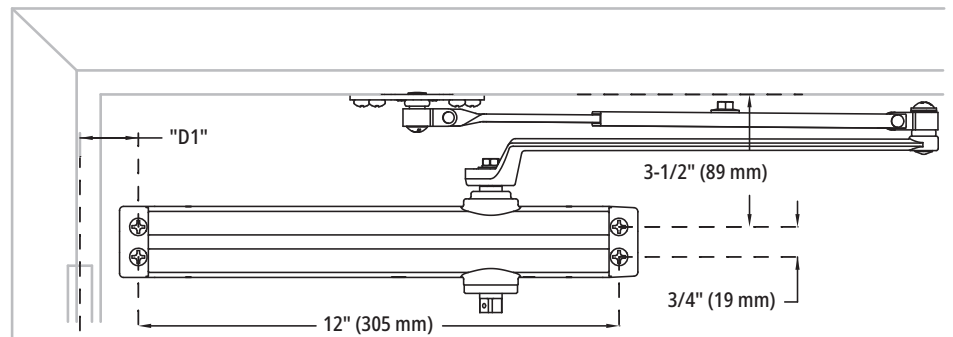
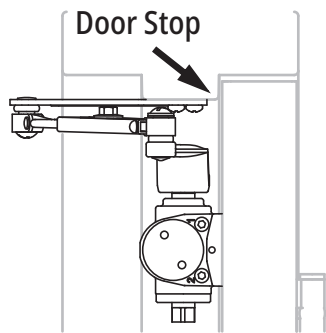

### Spindle Pre-Load (Step 7 Reference)

Left Hand Door shown - Reverse for Right Hand Swing.

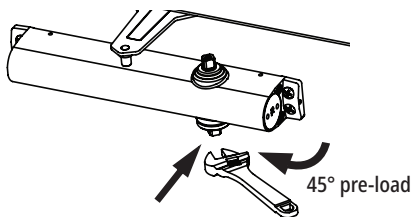

- Using an adjustable wrench, pre-load spindle at 45°, prior to installing arm in step 7.

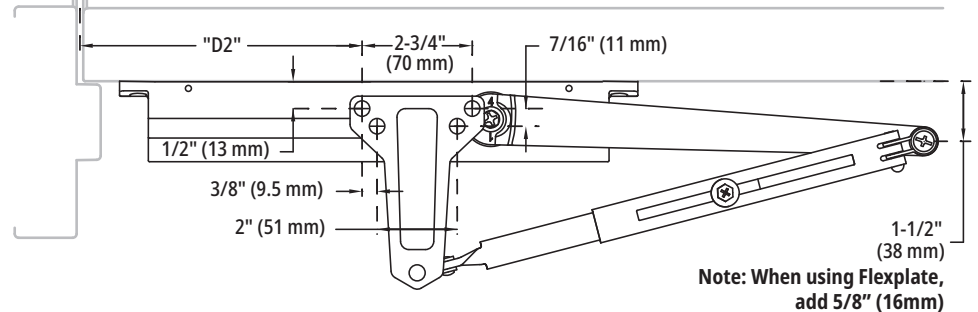

**Note:** When using Flexplate, add 5/8" (16mm)

**Note:** Closer is preset with 11 turns of power adjustment, and has a maximum of 26 turns for power adjustment.

Door Width		Opening	Dimension (D) From Center Line of Hinge	Power Adjustment Turns		Power Adjustment Turns	
Interior	Exterior			Size		Size	
UP TO 54" (1321mm)	UP TO 42" (1067mm)	TO 120°	D1) 3-3/4" (95mm) D2) 9-1/2" (241mm)	5	+12	2	-5
				4	+6	1	-11
				3	0		
UP TO 54" (1321mm)	UP TO 42" (1067mm)	TO 180°	D1) 1-1/4" (32mm) D2) 7" (178mm)	5	+13	2	-4
				4	+7	⚠	-10
				3	0		



## Parallel Arm Mounting Instructions Continued

For new installation, begin with step 1 below. For replacement installation, ensure you follow separate Flexplate instructions, then proceed to Step 2 below.

**1**

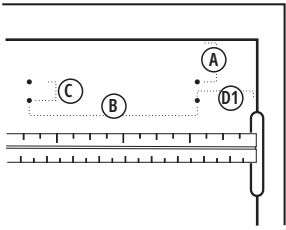

- A) 3-1/2" (89mm)
- B) 12" (305mm)
- C) 3/4" (19mm)
- D1) 3-3/4" (95mm)  
1-1/4" (32mm)

- Using diagram and chart on page 7, locate closer mounting hole positions on door.
- Note:** (D1) is the distance from centerline of hinge, determined by door's opening degree.
- Using proper drill bit and depth from Fastener Preparation Guide (Page 2), drill hole locations.

**2**

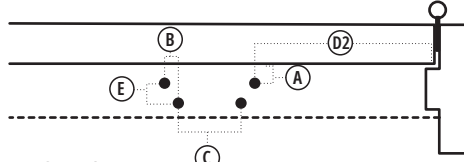

- A) 1/2" (13mm)
- B) 3/8" (9.5mm)
- C) 2" (51mm)
- E) 7/16" (11mm)
- D2) 9-1/2" (241mm)  
7" (178mm)

- Using diagram and chart page 7, locate mounting hole positions on frame.
- Using proper drill bit and depth from Fastener Preparation Guide (Page 2), drill hole locations.
- Note:** Parallel mounting bracket may be used as template to check hole locations.

**3**

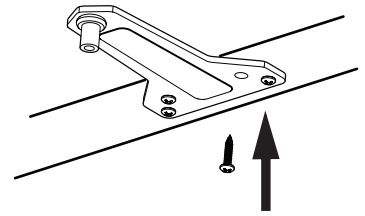

- Align parallel arm plate to prepared holes on jamb.
- Secure using 4 pan head screws (**F5** or **F6**). Reference Fastener preparation.

**4**

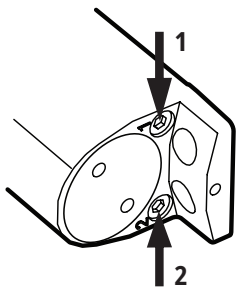

- Locate speed regulating valves on closer Labeled 1 and 2.

**5**

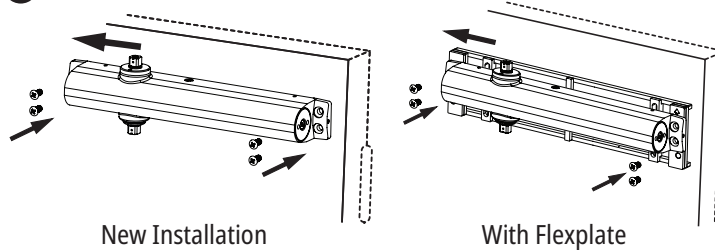

- Install closer on exterior of door, with speed regulating valves facing away from door hinge edge, using prepared holes on door, with 4 flathead screws (**F1**, **F2** or **F2 & F8**). Reference fastener preparation.
- Note:** If using Flexplate, install closer to holes that align with hole locations specified in step 1, using 4 machine screws (**F3** or **F3 & F8**).

**6**

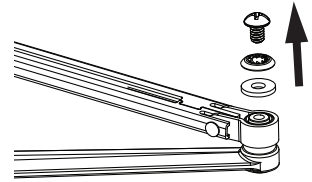

- Remove main arm elbow screw, lockwasher and washer.
- Separate main arm from forearm.

**7**

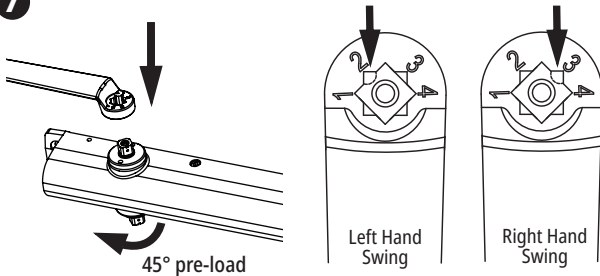

- Prior to arm install, pre-load spindle as shown on Page 7.
- Install main arm onto top spindle of closer.
- Note:** Ensure pinion dimple is aligned as shown above.

**8**

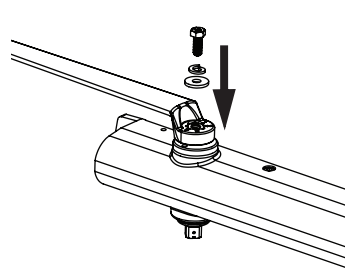

- Secure main arm into place using a main arm screw with lock washer (**F9**) and flat washer (**F10**).

**9**

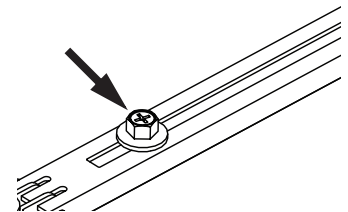

- Loosen arm adjustment screw.

**10**

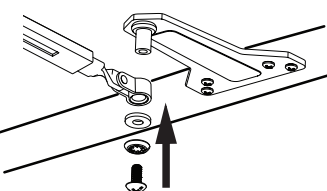

- Attach forearm to parallel arm plate using screw removed in Parallel Arm conversion on page 2. (**Washers F11 & F12 need to be added to screw**)

**11**

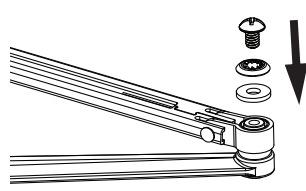

- Re-attach main arm to forearm and install main arm screw/washer set.

**12**

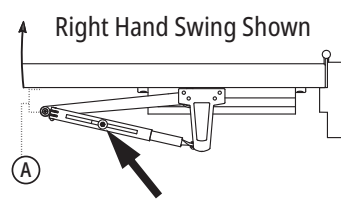

- Adjust arm into position.
- Note:** Arm's elbow screw should be: **A)** 1-1/2" (38mm) from door. If using Flexplate, add 5/8" (16mm).
- Tighten arm adjustment screw.

**13**

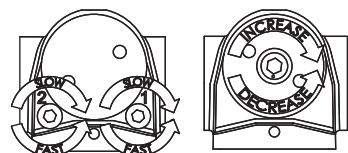

- Proceed to Adjustments and Final Steps section on **Page 9**.



## Adjustments | Finalization & Troubleshooting

**Important ADA Note:** Per ANSI/ICC A117.1, the time required for a door to close from 90 to 12 degrees is a minimum of 5 seconds. The allowable opening force of an interior door is 5 lbs. Check with your local AHJ for rules concerning exterior and fire exit doors.

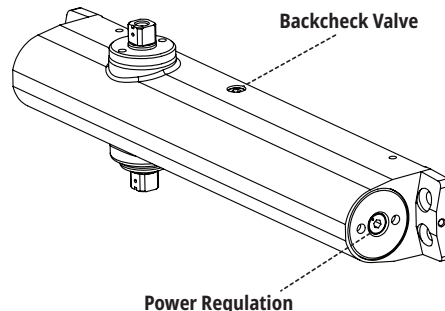
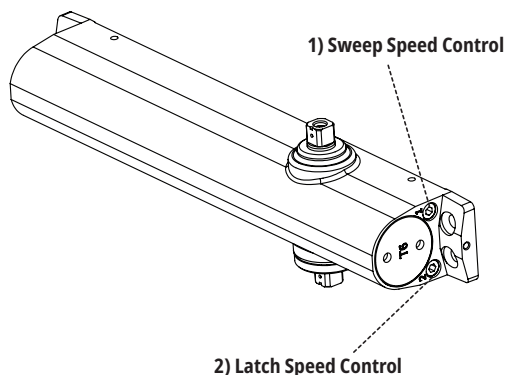

### Door Cycle Adjustments

#### Door closer speed controls

Valve 1 - Controls sweep range

Valve 2 - Controls latch range

#### Closing Cycle

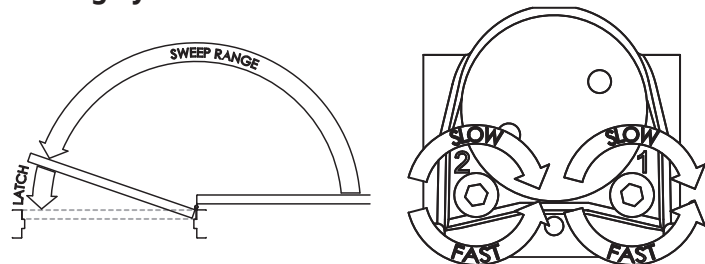

- Using the provided Allen wrench, adjust speed by turning valves 1 & 2.

**Note:** Never open or close valves completely.

#### Opening Cycle

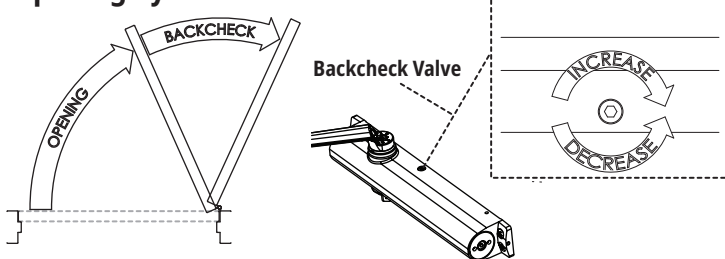

- Using the provided Allen wrench, adjust backcheck of opening cycle by turning Backcheck valve.

**Note:** Never open or close valve completely.

Backcheck Valve is intended for opening resistance, not to provide a stop position.

### Closer Power Adjustment

#### Exterior Door Width to Size Conversion

Door Width	24" (610mm)	30" (762mm)	36" (914mm)	42" (1087mm)	48" (1219mm)
Regular & Top Jamb Sizes	3	3 - 4	4 - 5	5 - 6	6
Parallel Arm Sizes	3	3 - 4	4 - 5	5	N/A

#### Interior Door Width to Size Conversion

Door Width	24" (610mm)	30" (762mm)	34" (865mm)	38" (965mm)	48" (1219mm)	54" (1372mm)	60" (1524mm)
Regular & Top Jamb Sizes	1	1 - 2	2 - 3	3 - 4	4 - 5	5 - 6	6
Parallel Arm Sizes	1	1 - 2	2 - 3	3 - 4	4 - 5	5	N/A

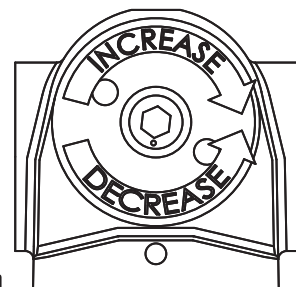

- Adjust spring power by turning the power adjustment control, referencing chart above and chart for installation type & mounting position.

**Note:** Spring power is preset with 11 turns. Do not exceed a maximum of 26 turns.

## Cover Installation

**Note:** Window on cover can be relocated, if needed.  
**Cover will not be flush with door if Flexplate is used.**

- 1**

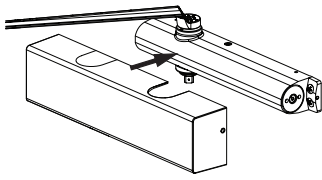
  - Place cover over closer to ensure opening in cover and closer arm align.

**Note:** If correct, proceed to step 3 to install cover. If window interferes, proceed to step 2.
- 2**

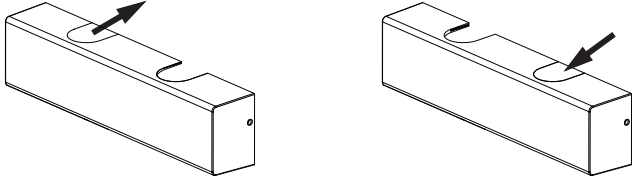
  - Slide window out of hole needed.
  - Slide window into hole not needed.

- 3**

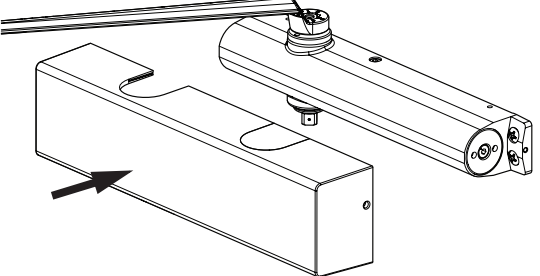
  - Install cover over closer.

**Note:** If using Flexplate is used, cover will not sit flush to door.
- 4**

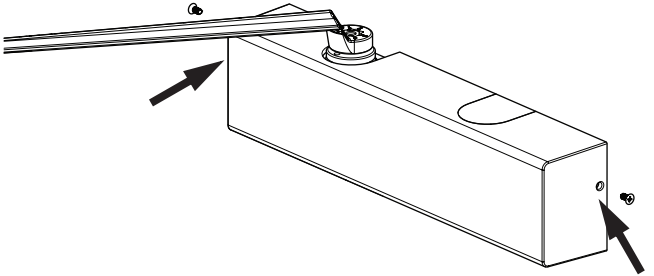
  - Secure cover to closer using 2 provided machine screws (F7).

**Note:** When cover is installed, it will not be centered on closer, and will sit slightly lower.

## Troubleshooting

Issue	Resolution
1 - The power is reduced, and the existing hole pattern or FlexPlate moves the closer body towards the hinge center line.	Often remedied by increasing the power adjustment one or two turns. Always adjust power incrementally and check closer function between each adjustment.
2 - The closer arm is hitting the top of the door jamb.	When measuring the location of the closer on the door, ensure the distance is measured from the correct surface. For Regular Arm and Top Jamb installations, measure from the top jamb surface. For Parallel Arm installations, measure from the door stop surface (where the PA plate is installed).
3 - The closer is not pulling the door to a completely closed position.	Check the position of the arm on step 11 for Regular Arm and Top Jamb installation, or step 12 for Parallel Arm installation. Check forearm screw tightness. Screw may loosen over time.
4 - Opening force greater or less than desired.	Refer to closer power adjustment on page 11 to increase or decrease the spring power as needed. Always adjust incrementally and check function between each adjustment.
5 - If door is subjected to strong winds.	It is recommend to increase power adjustment to ensure the door fully closes, without slamming. Refer to closer adjustment on page 11. To slow door's opening motion, adjust backcheck. This will help prevent door from being thrown open. Double check forearm screw for tightness. Screw may loosen over time. Always make incremental adjustments and check function between each adjustment.



**Need Help? Give us a call / ¿Necesita ayuda? Llámenos : 866-LOCK-PRO (1-866-562-5776)**  
Hampton Products International Corp • hamptonproducts.com • 50 Icon, Foothill Ranch, CA 92610-3000 ©2025 Hampton Products International Corp.

**FULL TEN YEAR WARRANTY** - For warranty details or to make a warranty claim for repair or replacement, please visit hamptonproducts.com or call 866-LOCK-PRO (1-866-562-5776). Return of defective product and receipt may be required for warranty claims.

**GARANTÍA COMPLETA DE DIEZ AÑOS** - para obtener detalles de la garantía o para hacer un reclamo de reparación o de reemplazo bajo la garantía, sírvase acceder a nuestro sitio Web: hamptonproducts.com, o llame al 866-LOCK-PRO (1-866-562-5776). Para reclamos bajo la garantía podrá requerirse el retorno del producto defectuoso y del recibo.

# INSTALLATION INSTRUCTIONS — FLEXPLATE®

**CAUTION!** An incorrectly installed or improperly adjusted door closer can cause property damage or personal injury. These instructions should be followed to avoid the possibility of misapplication or mis-adjustment. Flexplate is NOT to be used as a reinforcement plate.

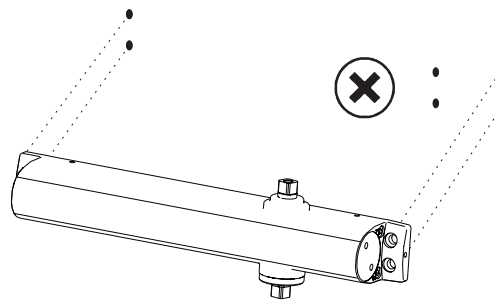
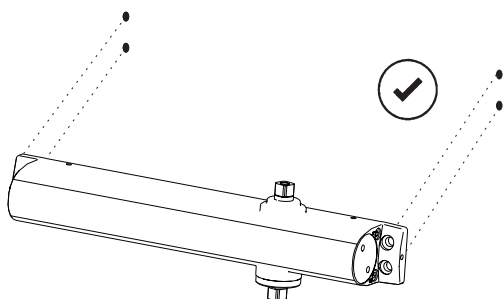

**Note:** The Flexplate is generally used when replacing existing door closers with a non 12" x 3/4" closer body hole pattern, and is not recommended for Top Jamb Installation. After verifying existing holes do not align with new closer, as shown above, proceed with mounting plate installation below (Regular Arm position shown). If holes do align, the Flexplate may not be needed. Verify mounting hole locations using diagram on corresponding mounting positions page.

**Note:** The FlexPlate cannot be used for a 12" x 3/4" hole pattern, but it is likely that the 407X closer can be installed directly. Compare the position of the existing hole pattern to the correct location for the 407X to ensure it is compatible.

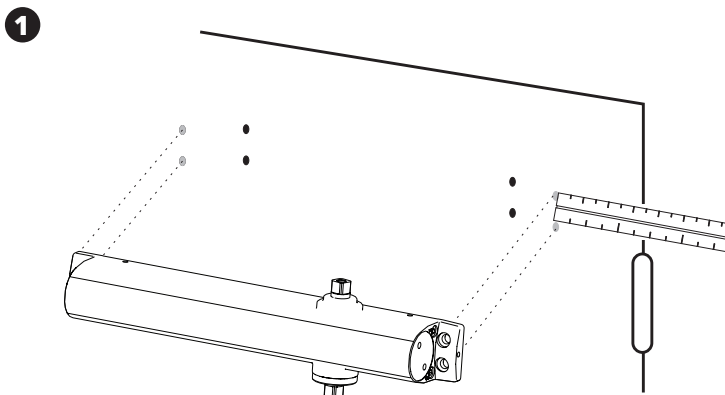

- Using the positioning chart on your mounting positions page, place closer body on door in recommended position, and mark hole locations.

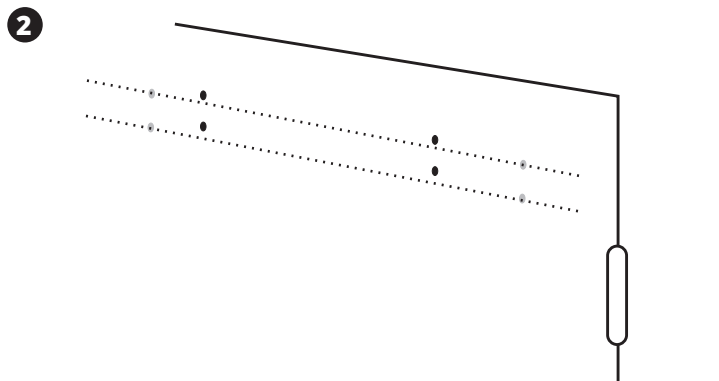

- It is recommended to then draw straight extending parallel lines between marked hole locations, for easy visibility.

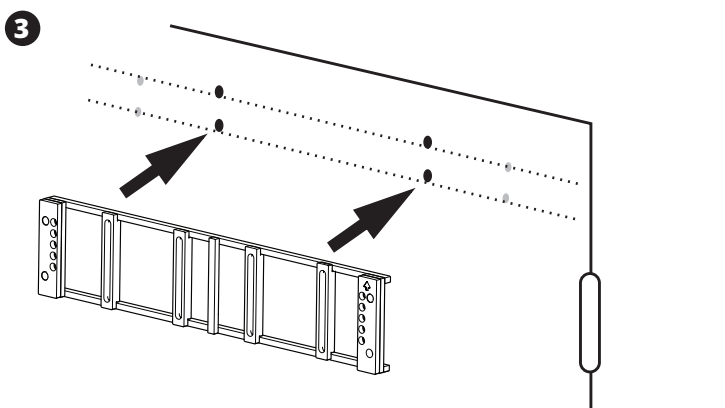

- Place Flexplate with sliders against door.
- Note:** Ensure arrow on mounting plate is pointing towards top of door.

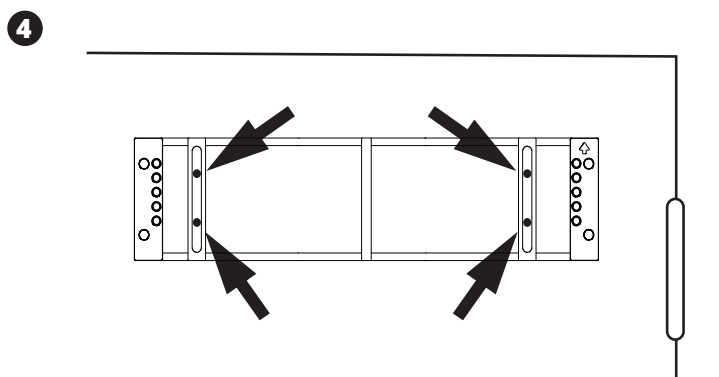

- Adjust position of sliders and plate to align with existing holes.
- Note:** All sliders may not be needed. Usually 2 or 4 sliders will be needed, but on rare occasions 3 may be used.

## Flexplate Instructions Continued

5

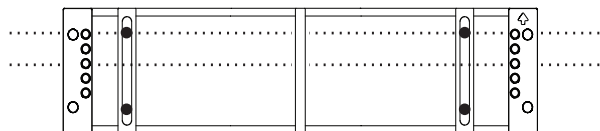

**Regular Arm Installation**  
continue to **Page 3**  
of closer instructions for location.

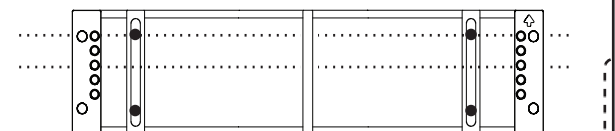

**Parallel Arm Installation**  
continue to **Page 7**  
of closer instructions for location.

- Adjust mounting plate so holes at the ends align with hole locations needed for mounting position.

6

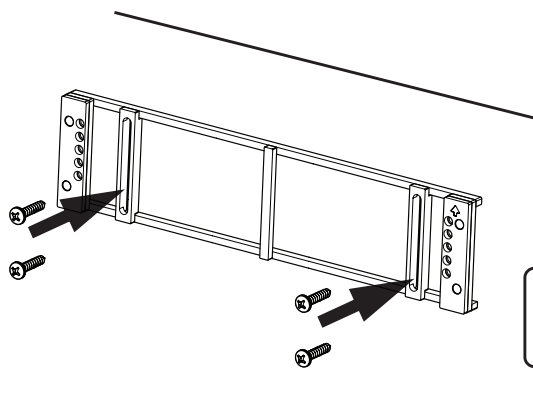

- Insert, but do not fully tighten screws through mounting plate sliders and into existing holes (**F4 or F5**). Reference fastener preparation.

7

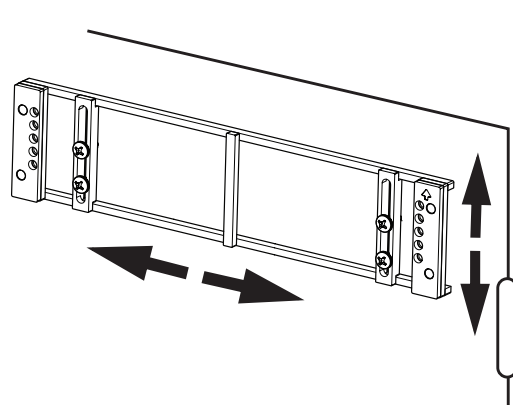

- Using diagram on correct mounting positions page and marked hole locations, double check location of bracket.

8

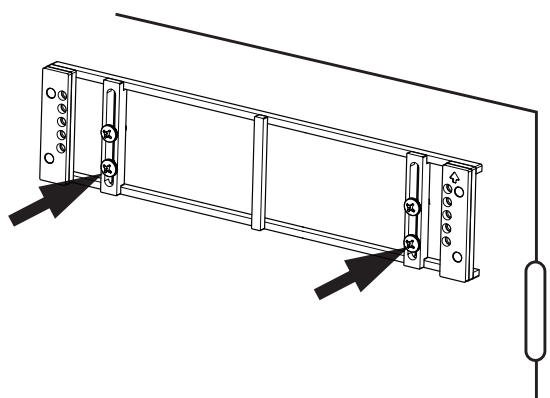

- Once proper position is achieved, tighten screws to secure in place.

9

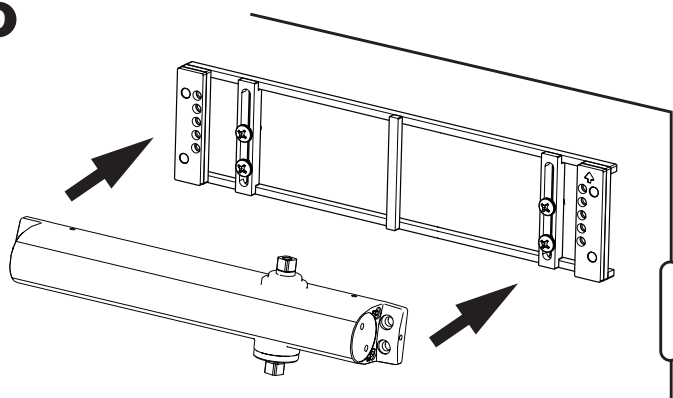

- Proceed to correct mounting position for door closer installation instructions.  
**Regular Arm Installation** continue to **Page 3**  
**Parallel Arm Installation** continue to **Page 7**



**Need Help? Give us a call / ¿Necesita ayuda? Llámenos : 866-LOCK-PRO (1-866-562-5776)**

Hampton Products International Corp • hamptonproducts.com • 50 Icon, Foothill Ranch, CA 92610-3000 ©2025 Hampton Products International Corp.

**FULL TEN YEAR WARRANTY** - For warranty details or to make a warranty claim for repair or replacement, please visit hamptonproducts.com or call 866-LOCK-PRO (1-866-562-5776). Return of defective product and receipt may be required for warranty claims.

**GARANTÍA COMPLETA DE DIEZ AÑOS** - para obtener detalles de la garantía o para hacer un reclamo de reparación o de reemplazo bajo la garantía, sírvase acceder a nuestro sitio Web: hamptonproducts.com, o llame al 866-LOCK-PRO (1-866-562-5776). Para reclamos bajo la garantía podrá requerirse el retorno del producto defectuoso y del recibo.