



Product Guide Mechanical Door Hardware

***Proven Quality Hardware From
One of the Most Trusted Names in Security***

brinkscommercial.com / 1-866-LOCK-PRO (1-866-562-5776)

About us

High-Quality, True Commercial Hardware

Brinks, one of the most trusted names in security, delivers superior quality commercial door hardware and custom ordering options for professionals. We offer a breadth of door closers, Grade 2 levers & knobs, Grade 1 deadbolts and accessories that can be found in areas such as office buildings, small businesses, warehouses and more.

At Brinks we take commercial hardware seriously. Our team of engineers apply their technical fortitude to develop products that exceed customer and industry expectations. Our industry experience led to innovative breakthroughs like our patented Universal Mounting Plate, which provides quick and easy door closer replacement. This allows our customers to save time and money while providing them peace of mind knowing their facilities are in good hands.

Above all, we remain focused on our customers and building long-term partnerships. Our Customer Care Team is ready to provide expert knowledge and technical support and we proudly stand behind our products with a competitive warranty.



PROGRAM OVERVIEW



**Keying Services &
Order Prep**



**Comprehensive
Commercial Hardware
Program**



Dedicated Service Reps

Need Help?

Our staff is ready to help:

- Live chat from 7:00 am to 4:00 pm PST at **brinkcommercial.com**
- By phone from 7:00 am to 4:00 pm PST at **866-LOCK-PRO**

Product specifications and installation videos available at **brinkcommercial.com**

Your One-Stop-Shop for All Things Multifamily and MRO

Facility Managers Maintenance Technicians Locksmiths Handymen Contractors

Complement office or interior doors with these great accessories!

Great choice for closets, hallway doors, bedrooms or bathrooms!

Ball Bearing Door Hinges

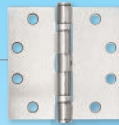

Floor Mounted Door Stop



Floor Mounted Door Stop with Holder



Pull Plate 16"



Push Plate 16"



Light Duty Passage Lever



Light Duty Privacy Lever

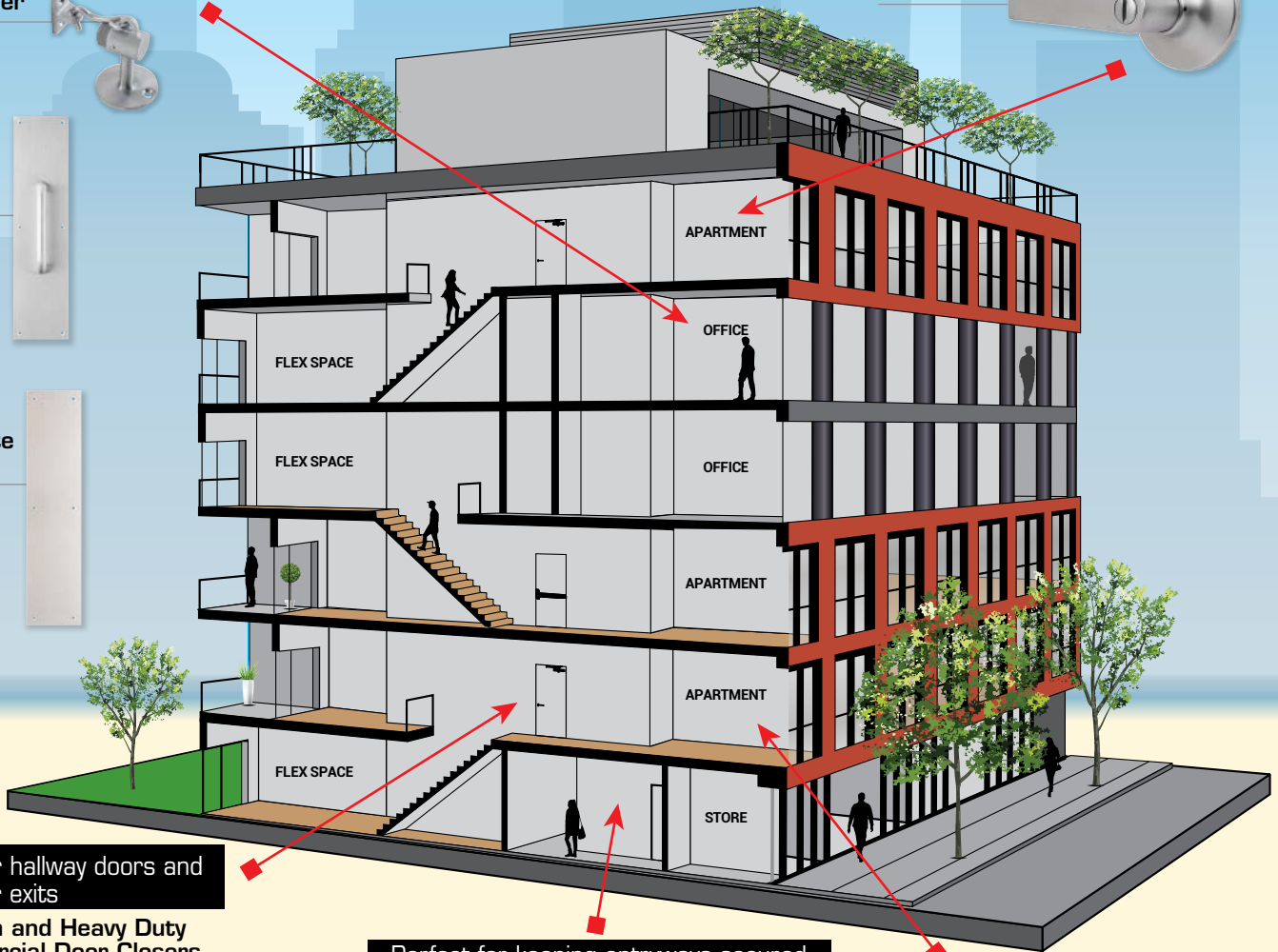

Ideal for hallway doors and corridor exits

Medium and Heavy Duty Commercial Door Closers

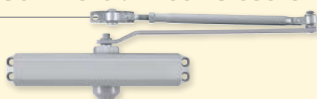

Exit/Panic Device



Pull Plate with Cylinder Hole



Perfect for keeping entryways secured

Single Cylinder Deadbolt



Heavy Duty Keyed Entry Lever



Heavy Duty Commercial Door Closer

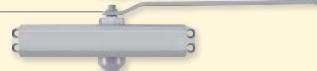

Perfect solution for unit entry doors or utility closets

Single Cylinder Deadbolt



Light Duty Keyed Entry Lever



Table of Contents

Closers (surface mounted)	5
Commercial Closers	6
Residential Closers	10
Locksets	12
Lever/Knob Functions	13
Levers	14
Knobs	16
Knob & Deadbolt Combo	17
Deadbolt	18
Exit Device (and accessories).....	19
Exit Device (push bar).....	20
Exit Device Trim (pull handle)	21
Flat Goods & Accessories	22
Dome Floor Stop	23
Floor Stop with Holder.....	23
Kick Down Floor Stop	23
Pull Plates	24
Push Plates	24
Privacy Door Latch.....	25
4½" Ball Bearing Door Hinge.....	25
ASA Strike.....	25
Door Silencers.....	25
Door Handles	26
"C" Style Pull Handle	27
"H" Style Pull Handle	27



Closers (surface mounted)



(BC4061)

Brinks Commercial Universal Mounting Plate Fits Most Installations

U.S. Pat. 7,698,796

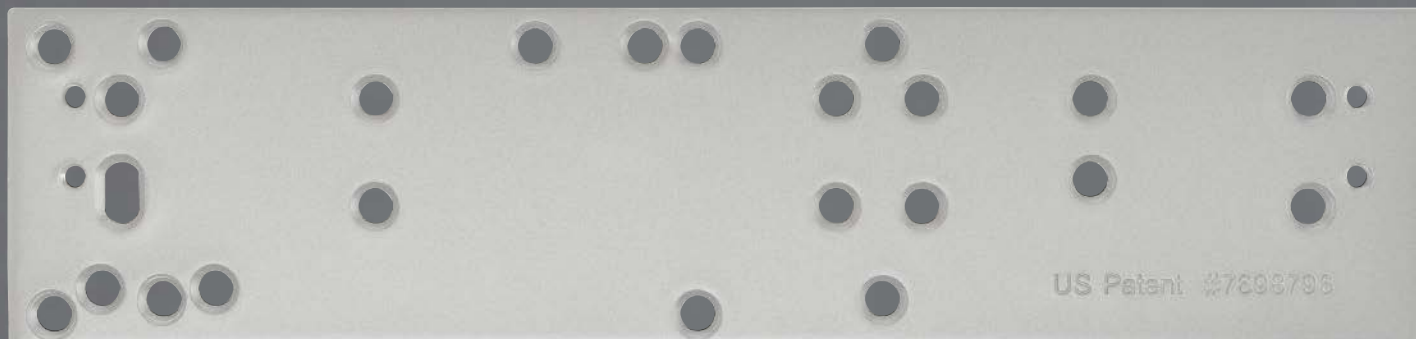

Brinks Commercial offers a closer for any commercial door, but our patented universal mounting plate is what sets us apart in closer installation. This mounting plate has holes that match the hole patterns of most closers in the market. Replace a broken closer without drilling new holes in an expensive or fire-rated door.

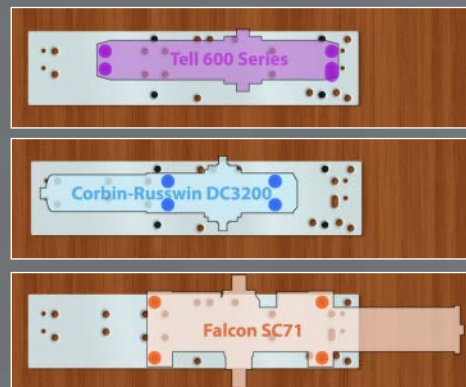

Scan and see why the All-In-One closer is the PRO's choice for retrofit applications.



	Description	All-In-One Heavy Duty Commercial Door Closer	Heavy Duty Commercial Door Closer	Medium Duty Commercial Door Closer	Heavy Duty Residential Door Closer	Light Duty Residential Hold Open Door Closer
Mounting	Case Pack Quantity	3	3	3	3	3
	Replacement or New Install	Replacement or New Installation	Replacement or New Installation	Replacement or New Installation	Replacement or New Installation	Replacement or New Installation
	Traffic Level	High Traffic	High Traffic	Medium Traffic	Medium Traffic	Low Traffic
Finish	Standard (Pull)	✓	✓	✓	✓	N/A
	Top Jamb (Push)	✓	✓	✓	✓	N/A
	Parallel Arm (Push)	✓	✓	✓	N/A	✓
Specs	Finish	Aluminum/Bronze/Matte Black	Aluminum/Bronze/Matte Black	Aluminum/Bronze/Matte Black	White Matte Black	White Matte Black
	Body Cover	Plastic	N/A	N/A	Plastic	Plastic
	Hold Open Engagement	N/A	N/A	N/A	N/A	80°
	Universal Mounting Plate	✓	N/A	N/A	N/A	N/A
	Body Material	Aluminum	Aluminum	Aluminum	Aluminum	Aluminum
	Adjustability	Adjustable closing, latching and backcheck speeds	Adjustable closing, latching and backcheck speeds	Adjustable closing and latching speeds	Adjustable closing speed	Adjustable closing speed
	ADA Compliant	✓	✓	N/A	N/A	✓
	Warranty	10 Year Limited	10 Year Limited	10 Year Limited	5 Year Limited	5 Year Limited
	UL 10C	3-Hour Fire	3-Hour Fire	3-Hour Fire	3-Hour Fire	N/A
	ANSI Grade	Grade 1	Grade 1			
	Closer Size	Adjustable 1 through 6	Adjustable 1 through 5	3	3	1
	Opening Range	180°	180°	180°	155°	180°
	Exterior Door Size	Up to 48"	Up to 42"	Up to 30"	Up to 30"	N/A
	Interior Door Size	Up to 60"	Up to 54"	Up to 38"	Up to 38"	Up to 30"

Closer Mounting Options

STANDARD MOUNT



PARALLEL MOUNT



TOP JAMB MOUNT





All-In-One Heavy Duty Commercial Closer



**3 HOUR
FIRE
RATED**



BC4061
Aluminum Finish



BC4062
Bronze Finish



BC4063
Matte Black Finish



Specifications:

ANSI Grade 1

UL 3-Hour Fire Rated

Body: Aluminum (plastic cover)

Finishes: Aluminum (BC4061), Bronze (BC4062), Matte Black (BC4063)

Closer Size: Adjustable 1 through 6

Opening Range: 180°

Exterior Door Size: Up to 48"

Interior Door Size: Up to 60"

Parallel Arm (Push Side) Mounting

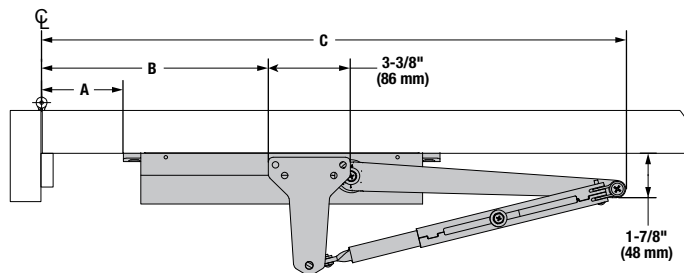

Universal
Mounting Plate
included

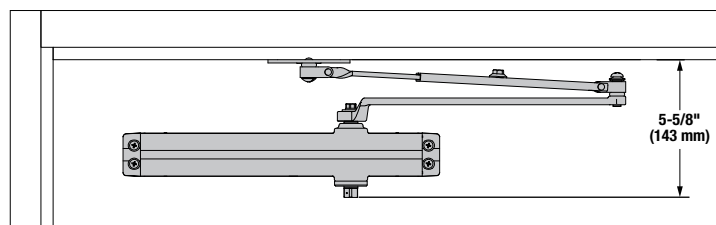

Opening Angle	A		B		C	
	in	mm	in	mm	in	mm
120°	3-5/16	84	9-3/16	233	23-3/4	603
180°	13/16	21	6-11/16	170	21-5/16	541

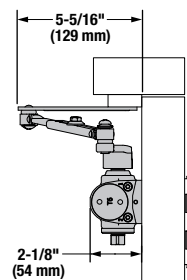

Dimensions for additional mounting options can be found at: www.brinkscommercial.com



Heavy Duty Commercial Closer



**3 HOUR
FIRE
RATED**



BC4031
Aluminum Finish

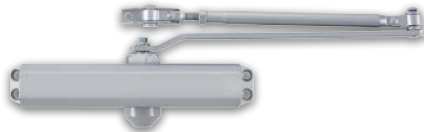

BC4032
Bronze Finish



BC4033
Matte Black Finish

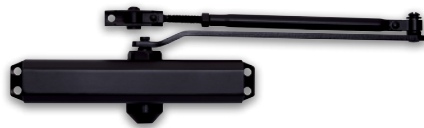

Specifications:

ANSI Grade 1

UL 3-Hour Fire Rated

Body: Aluminum

Finishes: Aluminum (BC4031), Bronze (BC4032), Matte Black (BC4033)

Closer Size: Adjustable 1 through 5

Opening Range: 180°

Exterior Door Size: Up to 42"

Interior Door Size: Up to 54"

Parallel Arm Installation

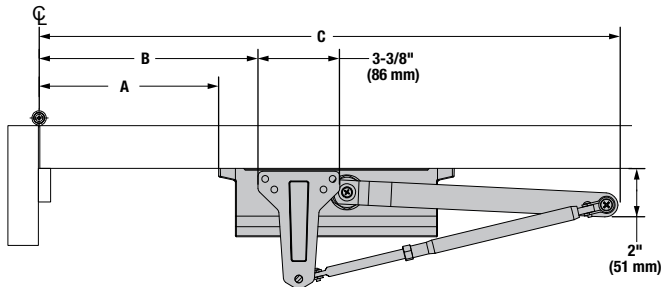

Opening Angle	A		B		C	
	in	mm	in	mm	in	mm
100°	7-5/16	186	8-15/16	227	23-11/16	602
120°	5-7/8	149	7-1/2	190	22-3/16	564
180°	3-13/16	97	5-7/16	138	20-3/16	513

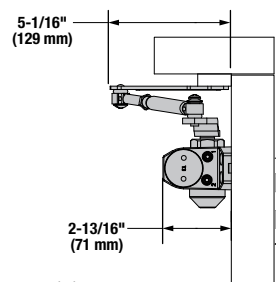
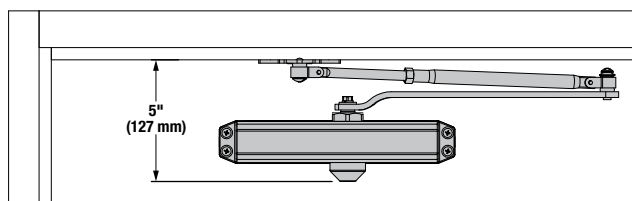

Dimensions for additional mounting options can be found at: www.brinkscommercial.com



Medium Duty Commercial Closer



**3 HOUR
FIRE
RATED**



**BC4051
Aluminum Finish**



**BC4052
Bronze Finish**



**BC4053
Matte Black Finish**



Specifications:

UL 3-Hour Fire Rated

Body: Aluminum

Finishes: Aluminum (BC4051), Bronze (BC4052), Matte Black (BC4053)

Closer Size: 3

Opening Range: 180°

Exterior Door Size: Up to 30"

Interior Door Size: Up to 38"

Parallel Arm Installation

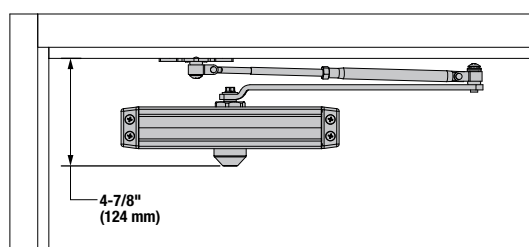
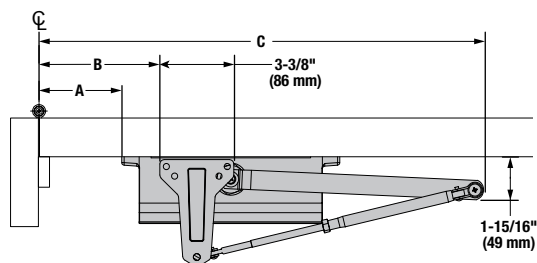

Opening Angle	A		B		C	
	in	mm	in	mm	in	mm
100°	7-1/4	184	8-15/16	227	23-9/16	559
130°	5-3/4	146	7-1/2	190	22-1/16	560
180°	3-3/4	95	5-7/16	138	20-1/16	510

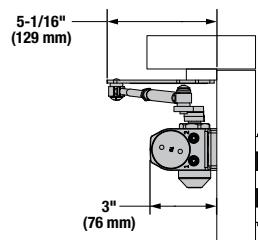



Heavy Duty Residential Closer



**3 HOUR
FIRE
RATED**



BC4007
White Finish



BC4008
Matte Black Finish



Specifications:

UL 3-Hour Fire Rated

Body: Aluminum

Finishes: White (BC4007), Matte Black (BC4008)

Closer Size: 3

Opening Range: 155°

Exterior Door Size: Up to 30"

Interior Door Size: Up to 38"

Standard (Pull Side) Mounting (Cover Not Shown)

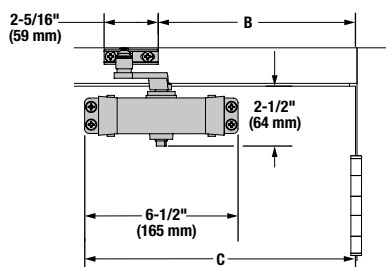
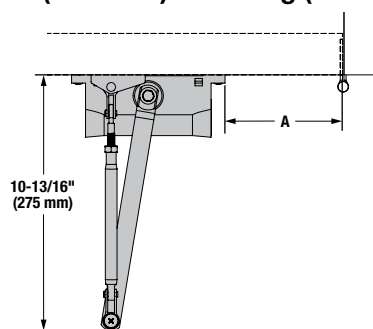

Opening Angle	A		B		C	
	in	mm	in	mm	in	mm
120°	4-15/16	125	8-5/16	211	11-1/2	292
155°	2-3/16	56	5-9/16	141	8-3/4	222

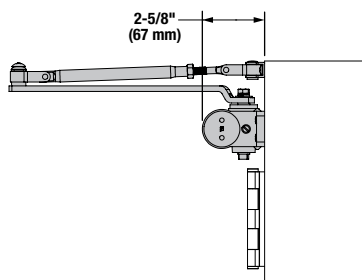

Dimensions for additional mounting options can be found at: www.brinkscommercial.com



Light Duty
Residential Closer



**HOLD
OPEN**



BC4009
White Finish



BC4010
Matte Black Finish



Specifications:

Body: Aluminum

Finishes: White (BC4009), Matte Black (BC4010)

Closer Size: 1

Opening Range: 180°

Hold Open Engagement: 80°

Exterior Door Size: N/A

Interior Door Size: Up to 30"

Parallel Arm (Push Side) Mounting (Cover Not Shown)

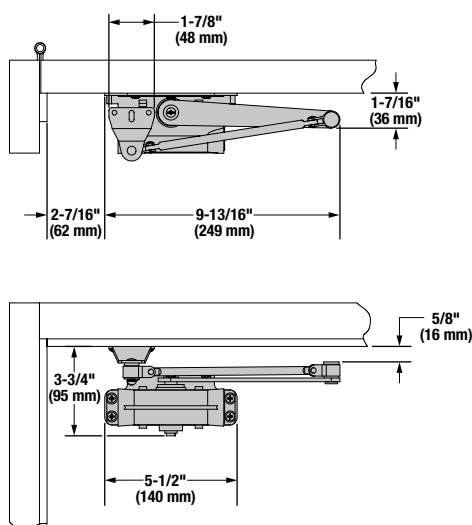

Opening Angle	A		B	
	in	mm	in	mm
120°	4-15/16	125	8-5/16	211
155°	2-3/16	56	5-9/16	141

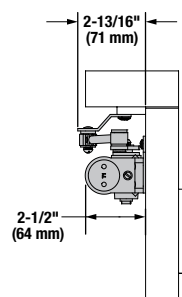

Locksets



Lever/Knob Functions

Passage

ANSI No. F75

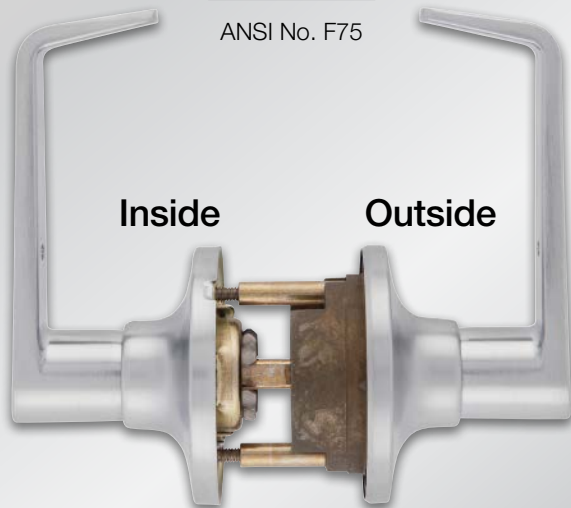

The Passage lever has a latchbolt that is operated by the lever from either side at all times. It does not have a lock function.

Privacy

ANSI No. F76B

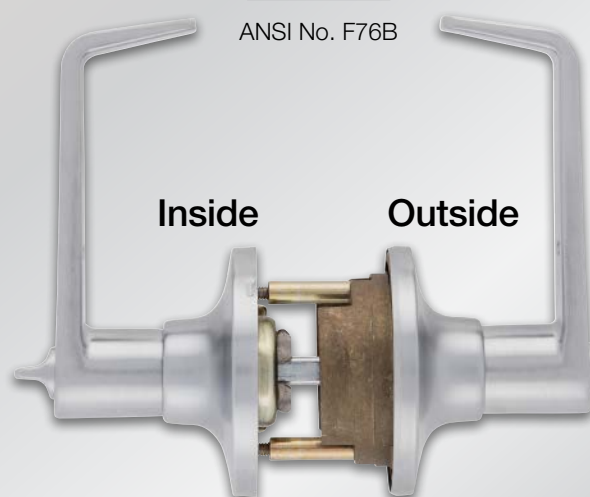

The Privacy lever has a latchbolt that is operated by the lever from either side, except when the outside lever is locked by the turn button inside. An emergency release on the outside unlocks the locking device. The turn button must be in the unlocked position for the outside or inside lever to operate.

Keyed Entry

ANSI No. F81

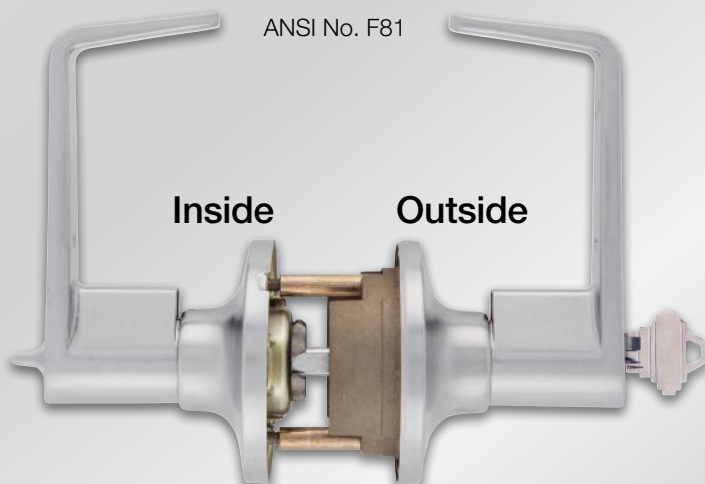

The Keyed Entry lever has a deadlocking latchbolt operated by the lever from either side, except when the outside lever is locked by the turn button inside. Operating the key in the outside lever locks or unlocks the locking device. The turn button must be in the unlocked position for the outside or inside lever to operate.

Keyed Entry – Storeroom

ANSI No. F86

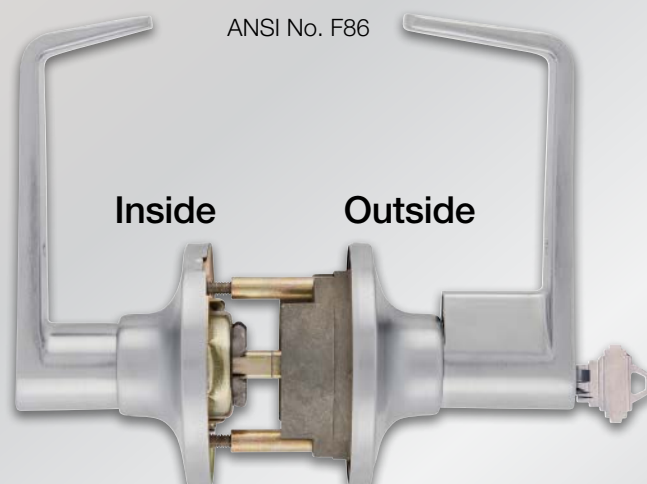

The Keyed Entry – Storeroom lever has a deadlocking latchbolt operated by a key in the outside lever or by rotating the inside lever. The outside lever is always locked.



**3 HOUR
FIRE
RATED**



BC40047 Satin Chrome
BC40101 Matte Black

Passage



BC40048 Satin Chrome
BC40100 Matte Black

Privacy



BC40049 Satin Chrome
BC40098 Matte Black

Keyed Entry



BC40050 Satin Chrome
BC40099 Matte Black

Storeroom



Specifications:

ANSI Grade 2

UL 3-Hour Fire Rated

Adjustable backset: 2-3/8" and 2-3/4"

Rosette Diameter: 2-5/8"

Finishes: Satin Chrome, Matte Black

Lever Handle Length: 3-3/4"

Chassis: Tubular

Door range: 1-3/8" to 2"

Keyway: SC1, 5 pin

Strikes: T-strike and full lip

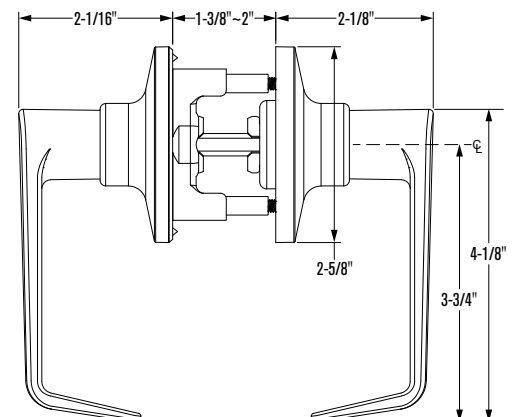



BC40107 Satin Chrome
Keypad Entry Lever



Specifications:

ANSI Grade 2

Adjustable backset: 2-3/8" and 2-3/4"

Finishes: Satin Chrome

Lever Handle Length: 3-3/4"

Door range: 1-3/8" to 2"

Keyway: SC4, 6 pin

Cylinder: Brass

Strikes: Full lip

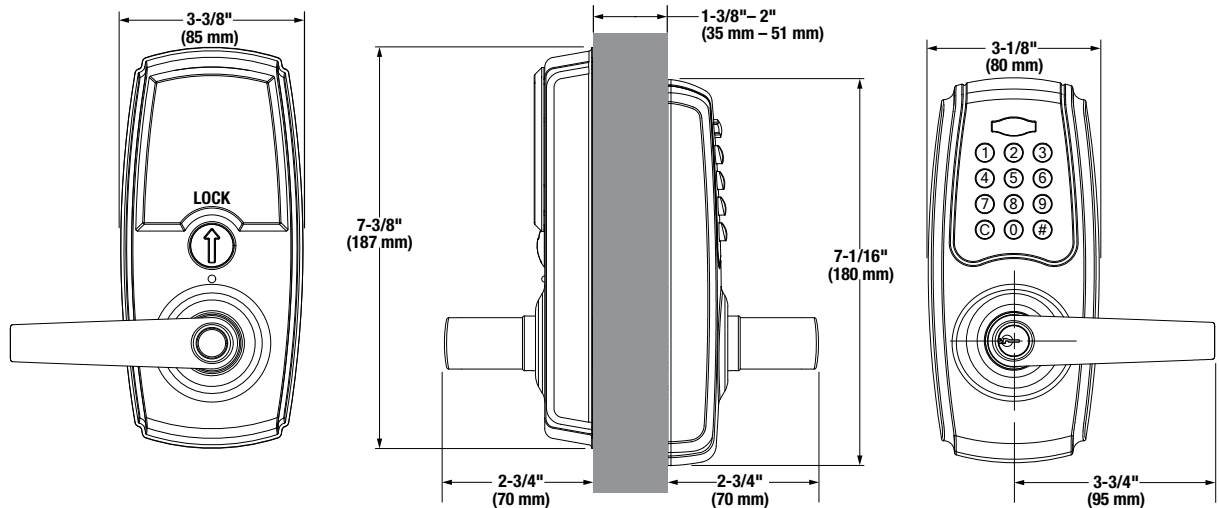



**3 HOUR
FIRE
RATED**



BC40051 Satin Chrome
Passage



BC40057 Satin Chrome
Privacy



BC40052 Satin Chrome
Keyed Entry



BC40053 Satin Chrome
Storeroom



Specifications:

ANSI Grade 2

UL 3-Hour Fire Rated

Adjustable backset: 2-3/8" and 2-3/4"

Rosette Diameter: 2-5/8"

Finishes: Satin Chrome

Chassis: Tubular

Door range: 1-3/8" to 2"

Keyway: SC1, 5 pin

Strikes: T-strike and full lip



**3 HOUR
FIRE
RATED**



Knob



Deadbolt



BC40054 Satin Chrome
BC40106 Matte Black

**Keyed Entry Knob and
Deadbolt Combo**



Specifications:

ANSI Grade 2

UL 3-Hour Fire Rated

Adjustable backset: 2-3/8" and 2-3/4"

Finishes: Satin Chrome, Matte Black

Rosette Diameter: (Knob) 2-5/8"

Knob Chassis: Tubular

Door range: 1-3/8" to 2"

Keyway: SC1, 5 pin

Strikes: T-strike and full lip (included)

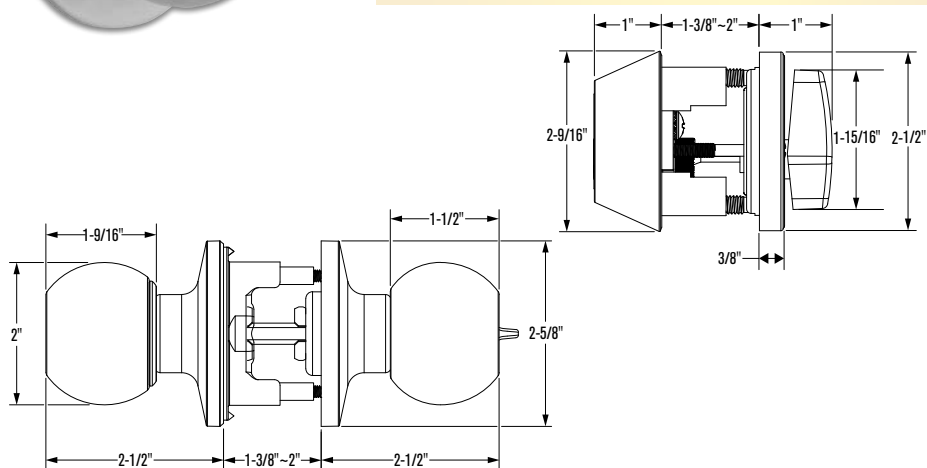



**3 HOUR
FIRE
RATED**



BC40055 Satin Chrome
BC40130 Matte Black

Single Cylinder Deadbolt



Specifications:

Grade 1

UL 3-Hour Fire Rated

Adjustable backset: 2-3/8" and 2-3/4"

Finishes: Satin Chrome, Matte Black

Door range: 1-3/8" to 2"

Keyway: SC4, 6 pin

Cylinder: Brass

Strikes: Strike and reinforcement

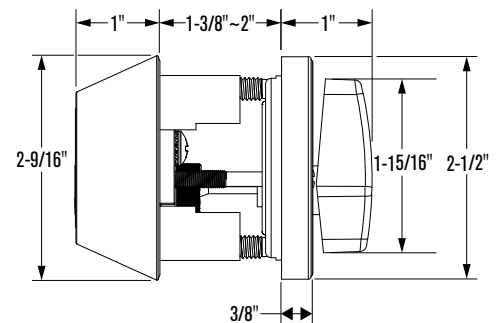

Exit Device (and accessories)





BC40010 Aluminum
BC41015 Matte Black

Exit Device



Applications

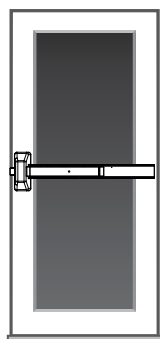

Single rim device

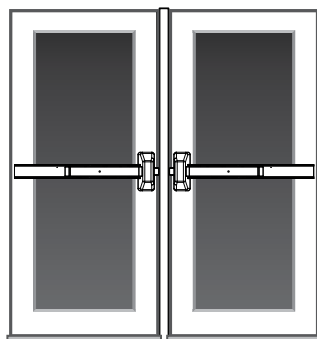

Two rim devices with mullion — same direction

Specifications:

ANSI Grade 1

Door width range: 28" to 42"**

*36" – 42" door width range without modification
28" – 35" door width range with cutting of the rail frame
30" minimum door width for a double door + mullion installation

Head Cover Dimensions:

8-1/2" x 2-3/4" x 2-1/2"

Push bar projection:

2-1/2" (push bar neutral)

1-15/16" (push bar depressed)

Door thickness range: 1-3/4" – 2"

Latch bolt: Deadlocking with 5/8" projection

Dogging device: Yes, hex key included

ADA Compliant: Yes, with lever trim

Cylinder keyway: SC4

Strikes: Surface mounted strike with 1/8" strike shim

Finishes: Aluminum, Matte Black

Included: Brass rim cylinder and steel pull



* Cylinder not included with pull handle. Cylinder included with BC40010 or BC41015.

BC40011 Satin Chrome
BC41016 Matte Black

Exit Device Trim

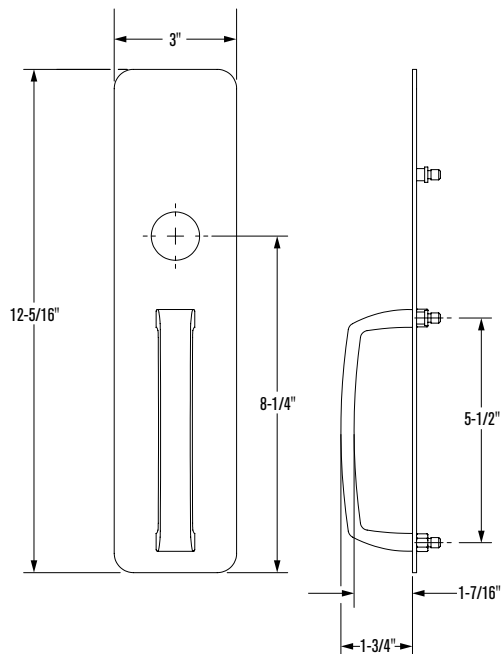

Specifications:

Trim function: Pull Handle

Function description: Key retracts bolt (cylinder included with BC40010 or BC41015); Cylinder sleeve included for 161 door prep

Escutcheon plate size: 12-5/16" x 3"

Pull center to center: 5-1/2"

Projection: 1-3/4"

Finishes: Satin Chrome, Matte Black

Handing: Reversible

Through-bolt design

Night latch function: Yes

Door thickness range: 1-3/4" to 2"

Flat Goods & Accessories



BC40074 Satin Chrome

BC41019 Matte Black

Floor Mount Door Stop



Specifications:

Base Material: Solid cast brass

Diameter: 1-3/4"

Height without riser: 1-1/8"

Height with riser: 1-1/2"

Fasteners: (1) #12 x 1-1/2" Wood Screw, (1) 1/4"-20 x 1" Machine Screw

Finishes: Satin Chrome, Matte Black

Bumper: Rubber

Mounting: Floor mounted



BC40076

Floor Mount Door Stop with Holder



Specifications:

Base Material: Solid cast brass

Diameter: 2-1/2"

Height: 3-5/8" 1-1/2"

Fasteners: (3) #12 x 1-1/2" Wood Screws, (1) 5/16"-18 Fully Threaded Rod

Finishes: Satin Chrome

Bumper: Rubber

Mounting: Floor mounted



BC41008 Satin Chrome

BC41009 Bronze

BC41020 Matte Black

Kick Down Floor Stop



Specifications:

Base Material: Solid cast brass

Height: 4"

Bumper Diameter: 1"

Fasteners: (4) #8 x 1" Wood Screws

Finishes: Satin Chrome, Bronze, Matte Black

Bumper: Rubber

Mounting: Door mounted



BC41004

Pull Plate

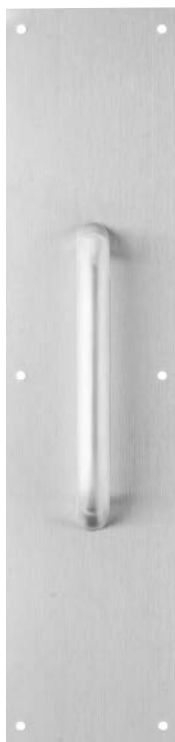

Specifications:

Material: Stainless Steel

Size: 4" x 16"

Finishes: Stainless Steel

Handle CTC: 6"

Fasteners: (6) #6 x 5/8" Wood Screws

BC41006 Aluminum, BC41021 Matte Black

Pull Plate



Specifications:

Material: Aluminum

Size: 3-1/2" x 15"

Finishes: Aluminum, Matte Black

Handle CTC: 5-1/8"

Fasteners: (6) #6 x 5/8" Wood Screws

BC41005, BC41007, BC41022

Push Plate



Specifications:

Material:
Stainless Steel (BC41005);
Aluminum (BC41007 &
BC41022)

Size: 3-1/2" x 15"

Finishes:
Stainless Steel (BC41005);
Satin Aluminum (BC41007);
Matte Black (BC41022)

Fasteners: (6) #6 x 5/8" Wood Screws

BC41003

Push Plate

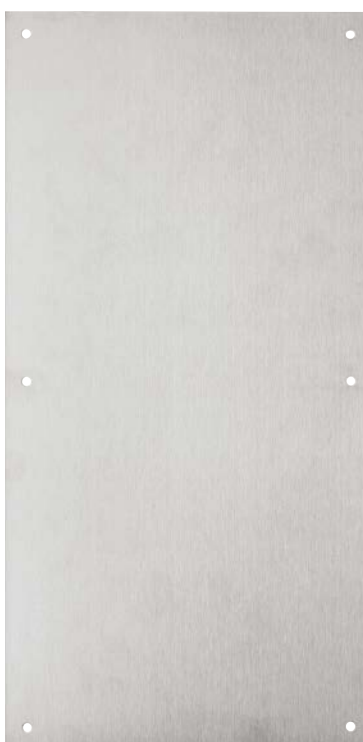

Specifications:

Material: Stainless Steel

Size: 8" x 16"

Finishes: Stainless Steel,
Matte Black

Fasteners: (6) #6 x 5/8" Wood Screws

BC40092 Satin Chrome, BC40093 Bronze Privacy Door Latch



Specifications:

Base Material: Zinc Alloy

Height: 2.75"

Fasteners: (3) #12 x 1-3/4"
Wood Screws

Finishes: Satin Chrome,
Bronze

Mounting: Frame Mounted



BC41012 Satin Chrome BC41014 Matte Black

ASA Strike



Specifications:

Base Material: Stainless Steel

Height: 4-7/8"

Width: 1-7/8"

Fasteners: (2) #8 x 3/4"
Combo Screws

Finishes: Satin Chrome Matte
Black



BC41010 Prime Coated, BC41011 Satin Chrome, BC41018 Matte Black

4 1/2" Ball Bearing Door Hinge



Specifications:

Material: Steel (ANSI A8111)

Gauge of Metal: .140"

Dimensions: 4.5" x 4.5"

Finishes: Prime Coated
(BC41010), Satin Chrome
(BC41011), BC41018 (Matte
Black)

Swaging: 1/16" Swage stan-
dard which provides 1/16" of
clearance between leaves



Hinges meet the requirements of NFPA 80
Section 6.4.3.1 for use on fire rated doors up
to 4 ft wide by 8 ft high and 1-3/4" thick.

BC41013 Door Silencers



Specifications:

Material: Rubber

Diameter: 1/2"

Height: 1/2"

Pack of 12



Door Handles



BC40094

"C" Style Pull Handle



Specifications:

Material: 304 Grade stainless steel

Application: Wood, glass, fiberglass and metal doors

Pull center to center: 11"

Tube Diameter: 1"

Projection: 2-3/4"

Door thickness range: 5/16" to 1-7/8"

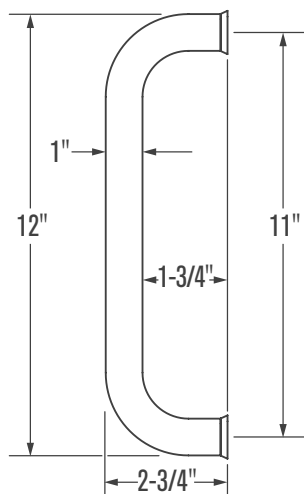

BC40095

"H" Style Pull Handle



Specifications:

Material: 304 Grade stainless steel

Application: Wood, glass, fiberglass and metal doors

Pull center to center: 6"

Tube Diameter: 1"

Projection: 3"

Door thickness range: 5/16" to 2"

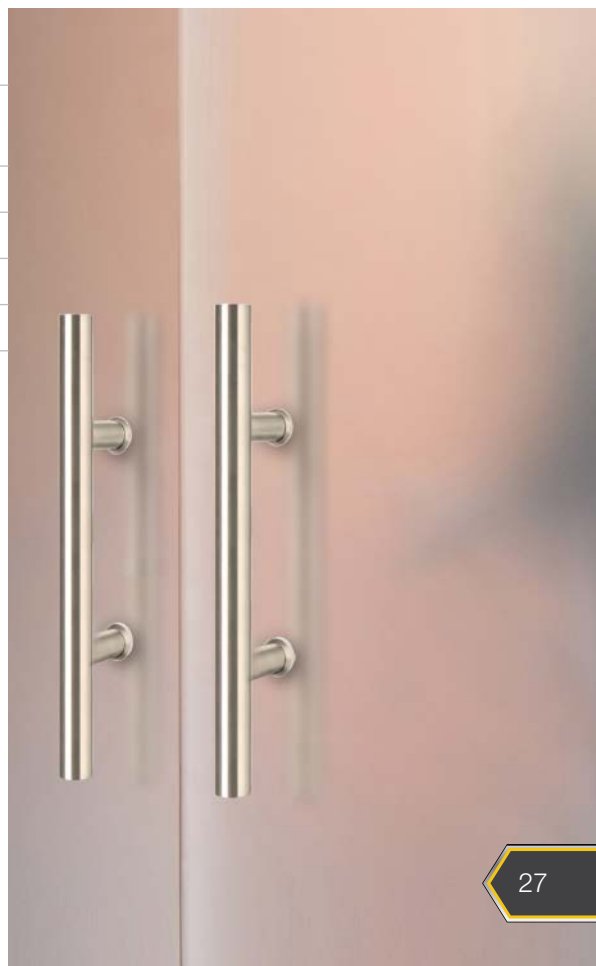
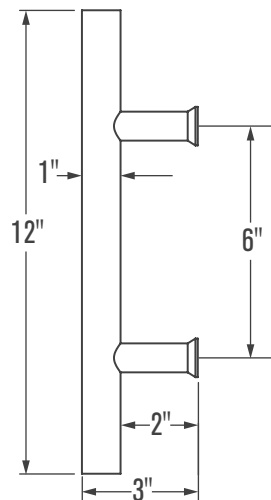



brinkscommercial.com
1-866-LOCK-PRO (1-866-562-5776)



50 Icon, Foothill Ranch, CA 92610-3000
©2023 Hampton Products International Corp.
84000-00022_REV8 01/23