

# **RETAIL EXTERIOR DOOR HARDWARE**

- **Storm Door**
- **Screen Door**
- **Patio Door**
- **Commercial Door Closers**

# New Packaging Benefits & Features

## PUSH BUTTON LATCHES

Lifetime Warranty  
New Hang Hole  
Product Hangs Straight

Easy to Install Icon  
Buyer's Guide Icon  
Door Thickness Statement

Product Positioned as if in Use  
Catalog Number Visible on Front of Card  
Installation Hole Spacing Statement

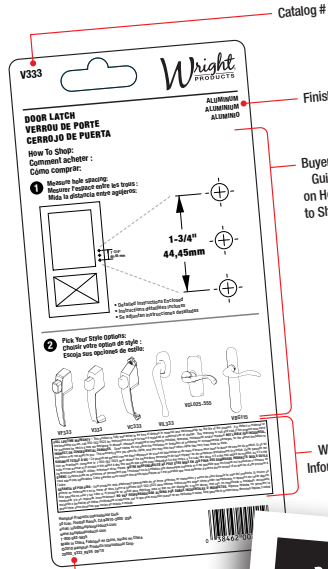
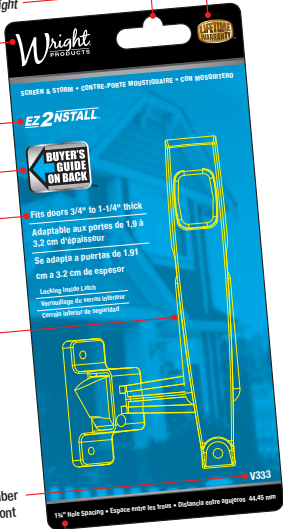

**IMPORTANT NOTE:**  
All Packaging is now Trilingual,  
English, Spanish & French Canadian

**IMPORTANT NOTE:**  
Trilingual Instruction Sheets are now  
included within the Packaging.

Hampton Products International Corp.  
50 East Northridge Ranch, CA 92610-3000 USA  
email: info@hamptonproducts.com • www.hamptonproducts.com • 1-800-562-5625  
50004000\_SS\_REVA

# New Packaging Benefits & Features

## CLOSERS

Lifetime Warranty  
New Hang Hole  
Product Hangs Straight

Easy to Install Icon  
Buyer's Guide Icon

Closer Classification  
Color coordinated for  
Each Classification

Energy Icon  
**IMPORTANT NOTE:**  
All Packaging is now Trilingual,  
English, Spanish & French Canadian

Catalog Number Visible  
on Front of Card  
Closer Classification  
Color coordinated for  
Each Classification

Hampton Products International Corp.  
50 East Northridge Ranch, CA 92610-3000 USA  
email: info@hamptonproducts.com • www.hamptonproducts.com • 1-800-562-5625  
50004000\_SS\_REVA

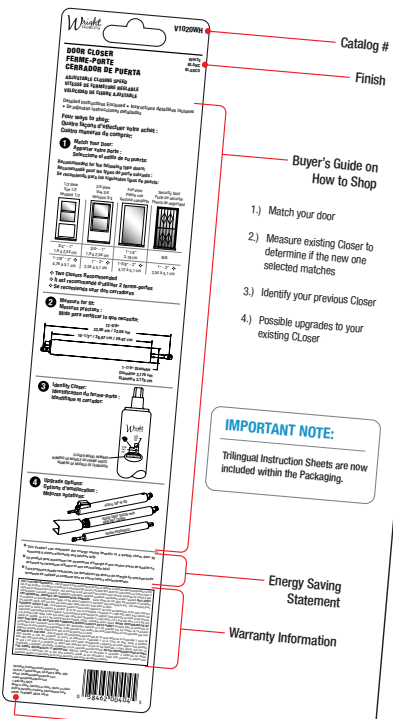
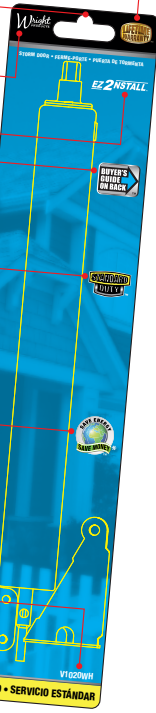

**IMPORTANT NOTE:**  
Trilingual Instruction Sheets are now  
included within the Packaging.

- Buyer's Guide on How to Shop
- 1.) Match your door
  - 2.) Measure existing Closer to determine if the new one selected matches
  - 3.) Identify your previous Closer
  - 4.) Possible upgrades to your existing Closer

Energy Saving Statement

Warranty Information

Hampton Phone Number for Warranty

# TABLE OF CONTENTS

## RETAIL EXTERIOR DOOR HARDWARE

Designer Series.....	4-5
Knob and Push Pull Latches.....	6-7
Latches.....	8-11
Strike Plates.....	12-13
Jamb Brackets and Storm Chain.....	14-15
Pneumatic & Hydraulic Closers.....	16-19
Performax®.....	20-21
Hardware Sets.....	22-23
Screen Door & Miscellaneous Hardware.....	24-31
Patio Hardware.....	32-34
Assortments & Displays.....	35-38



Denotes United States compliant packaging



Denotes Mexican-Spanish compliant packaging



Denotes Canadian compliant packaging

## **DESIGNER SERIES**

- **Serenade Brighton Surface Latch**
- **Georgian Lever Latch**
- **Villa Pull Lever**
- **Serenade Mortise Latch**



## Serenade Brighton Surface Latch



- Replaces most standard push button latches
- Matching interior and exterior finishes eliminates the need to match paint colors
- Includes a Night Latch with our "No Lock-Out Feature"
- Fits most 3/4" to 2" thick doors
- 1 3/4" mounting hole spacing

Catalog #	Color/Finish	Carton Qty.	UPC	I2of5	Packaging				Master Carton			
					Height (in.)	Width (in.)	Depth (in.)	Weight (lbs.)	Height (in.)	Width (in.)	Depth (in.)	Weight (lbs.)
VBG115PB	Brass	2	038462-650532	20038462-650536	9.75	5.125	4.1	1.6	5.75	10.375	6.25	3.59
VBG115SN	Satin Nickel	2	038462-650594	20038462-650598	9.75	5.125	4.1	1.6	5.75	10.375	6.25	3.59

## Georgian Lever Latch



- Replaces most standard push button latches
- Matching interior and exterior finishes eliminates the need to match paint colors
- Includes a Night Latch with our "No Lock-Out Feature"
- Fits most 3/4" to 2" thick doors
- 1 3/4" mounting hole spacing

Catalog #	Color/Finish	Carton Qty.	UPC	I2of5	Packaging				Master Carton			
					Height (in.)	Width (in.)	Depth (in.)	Weight (lbs.)	Height (in.)	Width (in.)	Depth (in.)	Weight (lbs.)
VGL025-555	Brass	2	038462-088250	20038462-088254	9.75	5.125	3.75	1.33	5.75	10.375	6.25	3.04

## Villa Pull Lever



- Replaces most standard push button latches
- Matching interior and exterior finishes eliminates the need to match paint colors
- Includes a Night Latch with our "No Lock-Out Feature"
- Fits most 3/4" to 2" thick doors
- 1 3/4" mounting hole spacing

Catalog #	Color/Finish	Carton Qty.	UPC	I2of5	Packaging				Master Carton			
					Height (in.)	Width (in.)	Depth (in.)	Weight (lbs.)	Height (in.)	Width (in.)	Depth (in.)	Weight (lbs.)
VIL333PB	Brass	2	038462-648836	20038462-648830	9.75	4.875	2.6	1.17	5.5	10.125	5.25	2.7
VIL333SN	Satin Nickel	2	038462-648898	20038462-648892	9.75	4.875	2.6	1.17	5.5	10.125	5.25	2.7

U.S. Patent D495,230

## Serenade Mortise Latch



- Fits doors 1 1/8" to 2" thick
- Includes built in keyed deadbolt
- Reversible levers for left and right hinged doors
- Matching interior and exterior finishes eliminates the need to match paint colors
- Includes adjustable backset for either 3/4" or 1" backsets

Catalog #	Color/Finish	Carton Qty.	UPC	I2of5	Packaging				Master Carton			
					Height (in.)	Width (in.)	Depth (in.)	Weight (lbs.)	Height (in.)	Width (in.)	Depth (in.)	Weight (lbs.)
VMT115PB	Brass	2	038462-651034	20038462-651038	9.75	5.125	4.5	2.73	10	9.5	6	5.92
VMT115SN	Satin Nickel	2	038462-651096	20038462-651090	9.75	5.125	4.5	2.73	10	9.5	6	5.92

Patent Pending

# **KNOB AND PUSH PULL LATCHES**

- **Push-Pull Latch**
- **Universal Knob Latch**
- **Keyed Universal Knob Latch**
- **Inswinging Door Latch**
- **Screen Door Mortise**



## Push-Pull Latch



- Ideal for outswinging wood or metal doors
- Fits doors  $\frac{7}{8}$ " -  $1\frac{1}{8}$ " thick
- Installs in 1" diameter hole
- All installation hardware included

Catalog #	Color/Finish	Carton Qty.	UPC	I2of5	Packaging				Master Carton			
					Height (in.)	Width (in.)	Depth (in.)	Weight (lbs.)	Height (in.)	Width (in.)	Depth (in.)	Weight (lbs.)
V1000	Aluminum	5	038462-002713	10038462-002710	6.75	5.875	2.5	0.5	8.7	7.3	6.7	3
V1000WH	White	5	039208-994729	50039208-994724	6.75	5.875	2.5	0.5	8.7	7.3	6.7	3

## Universal Knob Latch



- For outswinging wood or metal doors  $\frac{3}{4}$ " -  $1\frac{1}{8}$ " thick
- Replaces  $1\frac{1}{2}$ ",  $1\frac{3}{4}$ " and 3" hole spacing
- All installation hardware included

Catalog #	Color/Finish	Carton Qty.	UPC	I2of5	Packaging				Master Carton			
					Height (in.)	Width (in.)	Depth (in.)	Weight (lbs.)	Height (in.)	Width (in.)	Depth (in.)	Weight (lbs.)
V670	Aluminum	6	038462-759013	30038462-759014	6.75	5.75	2	0.55	7.125	8.75	6	3.4
V670BL	Black	6	038462-759020	30038462-759021	6.75	5.75	2	0.55	7.125	8.75	6	3.4
V670WH	White	6	039208-985840	60039208-985842	6.75	5.75	2	0.55	7.125	8.75	6	3.4

## Keyed Universal Knob Latch



- For outswinging wood or metal doors  $\frac{3}{4}$ " -  $1\frac{1}{8}$ " thick
- Replaces  $1\frac{1}{2}$ ",  $1\frac{3}{4}$ " and 3" hole spacing
- All installation hardware included

Catalog #	Color/Finish	Carton Qty.	UPC	I2of5	Packaging				Master Carton			
					Height (in.)	Width (in.)	Depth (in.)	Weight (lbs.)	Height (in.)	Width (in.)	Depth (in.)	Weight (lbs.)
VK670	Aluminum	6	039208-987813	60039208-987815	6.75	5.75	2	0.91	7.125	8.75	6	5.77

## Inswinging Door Latch



- For inswinging wood or metal doors  $\frac{5}{8}$ " -  $1\frac{3}{8}$ " thick
- $1\frac{3}{4}$ " installation hole spacing
- Installs in three  $\frac{5}{16}$ " diameter holes
- $\frac{7}{8}$ " backset

Catalog #	Color/Finish	Carton Qty.	UPC	I2of5	Packaging				Master Carton			
					Height (in.)	Width (in.)	Depth (in.)	Weight (lbs.)	Height (in.)	Width (in.)	Depth (in.)	Weight (lbs.)
V970WH	White	4	038462-027945	20038462-027949	6.75	6.75	2.75	1.07	11	7.5	7.5	4

## Screen Door Mortise



- For wood or metal doors  $\frac{7}{8}$ " to  $1\frac{3}{8}$ " thick
- Requires a  $\frac{5}{8}$ " edge bore hole be drilled for latch bolt installation
- All installation hardware included

Catalog #	Color/Finish	Carton Qty.	UPC	I2of5	Packaging				Master Carton			
					Height (in.)	Width (in.)	Depth (in.)	Weight (lbs.)	Height (in.)	Width (in.)	Depth (in.)	Weight (lbs.)
V2200BR	Brass	5	038462-042184	50038462-042189	6	5.25	2.05	0.58	5.75	6.75	6.5	3.1
V2200SN	Satin Nickel	5	039208-988704	50039208-988709	6	5.25	2.05	0.58	5.75	6.75	6.5	3.1

# LATCHES

- **Tie-Down Push Button Latch**
- **Push Button Latch**
- **Pull Handle**
- **Inside Latch**





## Tie-Down Push Button Latch



- For outswinging wood or metal doors 3/4" - 1 1/4" thick
- 1 3/4" mounting hole spacing
- Installs in three 5/16" holes
- "No Lock Out" feature prevents accidental lock out
- Contains two sizes of strike plates and shims to provide adjustment for varying backsets
- All installation hardware included

Catalog #	Color/Finish	Carton Qty.	UPC	I2of5	Packaging				Master Carton			
					Height (in.)	Width (in.)	Depth (in.)	Weight (lbs.)	Height (in.)	Width (in.)	Depth (in.)	Weight (lbs.)
V333	Aluminum	6	038462-002119	60038462-002111	9.75	4.875	2.12	0.62	5	10	9.75	4.31
V333BL	Black	6	038462-001525	60038462-001527	9.75	4.875	2.12	0.62	5	10	9.75	4.31
V333FB	Florida Brown	6	038462-002188	60038462-002180	9.75	4.875	2.12	0.62	5	10	9.75	4.31
V333WH	White	6	038462-002140	60038462-002142	9.75	4.875	2.12	0.62	5	10	9.75	4.31

## Colonial Push Button Latch



- For outswinging wood or metal doors 3/4" - 1 1/4" thick
- 1 3/4" mounting hole spacing
- Installs in three 5/16" holes
- "No Lock Out" feature prevents accidental lock out
- Contains two sizes of strike plates and shims to provide adjustment for varying backsets
- All installation hardware included

Catalog #	Color/Finish	Carton Qty.	UPC	I2of5	Packaging				Master Carton			
					Height (in.)	Width (in.)	Depth (in.)	Weight (lbs.)	Height (in.)	Width (in.)	Depth (in.)	Weight (lbs.)
VC333BL	Black	6	038462-002324	60038462-002326	9.75	4.875	2.12	0.75	5	10	9.75	5.09

## Heavy-Duty Colonial Push Button Latch



- For outswinging wood or metal doors 3/4" - 1 1/4" thick
- 1 3/4" mounting hole spacing
- Installs in three 5/16" holes
- "No Lock Out" feature prevents accidental lock out
- Contains two sizes of strike plates and shims to provide adjustment for varying backsets
- All installation hardware included

Catalog #	Color/Finish	Carton Qty.	UPC	I2of5	Packaging				Master Carton			
					Height (in.)	Width (in.)	Depth (in.)	Weight (lbs.)	Height (in.)	Width (in.)	Depth (in.)	Weight (lbs.)
VC444-2BL	Black	6	038462-045222	60038462-045224	9.75	4.875	2.12	0.77	5	10	9.75	5.21

## Free-Hanging Push Button Latch



- For outswinging wood or metal doors 3/4" - 1 1/4" thick
- 1 3/4" mounting hole spacing
- Installs in three 5/16" holes
- "No Lock Out" feature prevents accidental lock out
- Contains two sizes of strike plates and shims to provide adjustment for varying backsets
- All installation hardware included

Catalog #	Color/Finish	Carton Qty.	UPC	I2of5	Packaging				Master Carton			
					Height (in.)	Width (in.)	Depth (in.)	Weight (lbs.)	Height (in.)	Width (in.)	Depth (in.)	Weight (lbs.)
VF333	Aluminum	6	038462-001815	60038462-001817	9.75	4.875	2.12	0.66	5	10	9.75	4.54
VF333BL	Black	6	038462-001822	60038462-001824	9.75	4.875	2.12	0.66	5	10	9.75	4.54
VF333FB	Florida Brown	6	038462-001884	60038462-001886	9.75	4.875	2.12	0.66	5	10	9.75	4.54
VF333WH	White	6	038462-001846	60038462-001848	9.75	4.875	2.12	0.66	5	10	9.75	4.54

**Colonial Keyed Push Button Latch**



- For outswinging wood or metal doors 3/4" - 1 1/4" thick
- 1 3/4" mounting hole spacing
- Installs in three 5/16" holes
- "No Lock Out" feature prevents accidental lock out
- Contains two sizes of strike plates and shims to provide adjustment for varying backsets
- All installation hardware included

Catalog #	Color/Finish	Carton Qty.	UPC	I2of5	Packaging				Master Carton			
					Height (in.)	Width (in.)	Depth (in.)	Weight (lbs.)	Height (in.)	Width (in.)	Depth (in.)	Weight (lbs.)
VCK333X3BL	Black	6	038462-002423	60038462-002425	9.75	4.875	2.12	0.85	5	10	9.75	5.69

**Tie-Down Keyed Push Button Latch**



- For outswinging wood or metal doors 3/4" - 1 1/4" thick
- 1 3/4" mounting hole spacing
- Installs in three 5/16" holes
- "No Lock Out" feature prevents accidental lock out
- Contains two sizes of strike plates and shims to provide adjustment for varying backsets
- All installation hardware included

Catalog #	Color/Finish	Carton Qty.	UPC	I2of5	Packaging				Master Carton			
					Height (in.)	Width (in.)	Depth (in.)	Weight (lbs.)	Height (in.)	Width (in.)	Depth (in.)	Weight (lbs.)
VK333X3	Aluminum	6	038462-002010	60038462-002012	9.75	4.875	2.12	0.76	5	10	9.75	5.12
VK333X3BL	Black	6	038462-002027	60038462-002029	9.75	4.875	2.12	0.76	5	10	9.75	5.12
VK333X3WH	White	6	038462-002041	60038462-002043	9.75	4.875	2.12	0.76	5	10	9.75	5.12
VK333X3FB	Florida Brown	6	038462-002089	60038462-002081	9.75	4.875	2.12	0.76	5	10	9.75	5.12

**Tie-Down Push Button Latch — 1 1/2" Hole Spacing**



- For outswinging wood or metal doors 3/4" - 1 1/4" thick
- 1 1/2" mounting hole spacing
- Installs in three 5/16" holes
- "No Lock Out" feature prevents accidental lock out
- Contains two sizes of strike plates and shims to provide adjustment for varying backsets
- All installation hardware included

Catalog #	Color/Finish	Carton Qty.	UPC	I2of5	Packaging				Master Carton			
					Height (in.)	Width (in.)	Depth (in.)	Weight (lbs.)	Height (in.)	Width (in.)	Depth (in.)	Weight (lbs.)
V398	Aluminum	6	038462-038811	60038462-038813	9.75	4.875	2.12	0.66	5	10	9.75	4.54
V398BL	Black	6	038462-038828	60038462-038820	9.75	4.875	2.12	0.66	5	10	9.75	4.54
V398WH	White	6	039208-985833	60039208-985835	9.75	4.875	2.12	0.66	5	10	9.75	4.54

**Tie-Down Keyed Push Button Latch — 1 1/2" Hole Spacing**



- For outswinging wood or metal doors 3/4" - 1 1/4" thick
- 1 1/2" mounting hole spacing
- Installs in three 5/16" holes
- "No Lock Out" feature prevents accidental lock out
- Contains two sizes of strike plates and shims to provide adjustment for varying backsets
- All installation hardware included

Catalog #	Color/Finish	Carton Qty.	UPC	I2of5	Packaging				Master Carton			
					Height (in.)	Width (in.)	Depth (in.)	Weight (lbs.)	Height (in.)	Width (in.)	Depth (in.)	Weight (lbs.)
VK398X3	Aluminum	6	038462-039610	60038462-039612	9.75	4.875	2.12	0.76	5	10	9.75	5.14

## Dunmore Pull Handle



- For outswinging wood or metal doors 3/4" - 2" thick
- 1 3/4" mounting hole spacing
- Replaces most standard push button latches
- "No Lock Out" feature prevents accidental lock out
- All installation hardware included

Catalog #	Color/Finish	Carton Qty.	UPC	I2of5	Packaging				Master Carton			
					Height (in.)	Width (in.)	Depth (in.)	Weight (lbs.)	Height (in.)	Width (in.)	Depth (in.)	Weight (lbs.)
VDN333BL	Black	6	038462-647822	30038462-647823	9.75	4.875	2.02	0.91	9.5	9.5	5.25	4.92
VDN333WH	White	6	038462-647846	30038462-647847	9.75	4.875	2.02	0.91	9.5	9.5	5.25	4.92

## Villa Pull Handle



- For outswinging wood or metal doors 3/4" - 1 1/4" thick
- 1 3/4" mounting hole spacing
- Replaces most standard push button latches
- "No Lock Out" feature prevents accidental lock out
- All installation hardware included

Catalog #	Color/Finish	Carton Qty.	UPC	I2of5	Packaging				Master Carton			
					Height (in.)	Width (in.)	Depth (in.)	Weight (lbs.)	Height (in.)	Width (in.)	Depth (in.)	Weight (lbs.)
VIL333BL	Black	6	038462-778526	60038462-778528	9.75	4.875	2.6	1	5.5	14.375	10.25	6.73
VIL333WH	White	6	038462-778540	60038462-778542	9.75	4.875	2.6	1	5.5	14.375	10.25	6.73

U.S. Patent D495,230

## Heavy Duty Push Button Latch



- For outswinging wood or metal doors 3/4" - 2" thick
- 1 3/4" mounting hole spacing
- Installs in three 5/16" holes
- "No Lock Out" feature prevents accidental lock out
- Contains two sizes of strike plates and shims to provide adjustment for varying backsets
- All installation hardware included

Catalog #	Color/Finish	Carton Qty.	UPC	I2of5	Packaging				Master Carton			
					Height (in.)	Width (in.)	Depth (in.)	Weight (lbs.)	Height (in.)	Width (in.)	Depth (in.)	Weight (lbs.)
V444-2	Aluminum	6	038462-045215	60038462-045217	9.75	4.875	2.12	0.78	5	10	9.75	5.21
V444-2WH	White	6	038462-882049	60038462-882041	9.75	4.875	2.12	0.78	5	10	9.75	5.21
V444-2BN	Brown	6	038462-882087	60038462-882089	9.75	4.875	2.12	0.78	5	10	9.75	5.21

## Heavy Duty Inside Latch



- Replaces similar inside latch

Catalog #	Color/Finish	Carton Qty.	UPC	I2of5	Packaging				Master Carton			
					Height (in.)	Width (in.)	Depth (in.)	Weight (lbs.)	Height (in.)	Width (in.)	Depth (in.)	Weight (lbs.)
V444IS	Aluminum	6	038462-882117	60038462-882119	6.25	4.875	2	0.26	5	10	9.75	5.21
V444ISWH	White	6	038462-882148	60038462-882140	6.25	4.875	2	0.26	5	10	9.75	5.21
V444ISBN	Brown	6	038462-882186	60038462-882188	6.25	4.875	2	0.26	5	10	9.75	5.21

## Heavy Duty Keyed Push Button Latch



- For outswinging wood or metal doors 3/4" - 2" thick
- 1 3/4" mounting hole spacing
- Installs in three 5/16" holes
- "No Lock Out" feature prevents accidental lock out
- Contains two sizes of strike plates and shims to provide adjustment for varying backsets
- All installation hardware included

Catalog #	Color/Finish	Carton Qty.	UPC	I2of5	Packaging				Master Carton			
					Height (in.)	Width (in.)	Depth (in.)	Weight (lbs.)	Height (in.)	Width (in.)	Depth (in.)	Weight (lbs.)
VK444-2	Aluminum	6	038462-045314	60038462-045316	9.75	4.875	2.12	0.88	5	10	9.75	6.02
VK444-2WH	White	6	038462-882247	60038462-882249	9.75	4.875	2.12	0.88	5	10	9.75	6.02
VK444-2BN	Brown	6	038462-882285	60038462-882287	9.75	4.875	2.12	0.88	5	10	9.75	6.02

# STRIKE PLATES

- **Knob Latch  
Replacement Strike Plate**
- **Push Button Latch  
Replacement Strike Plate**



## Knob Latch Replacement Strike Plate

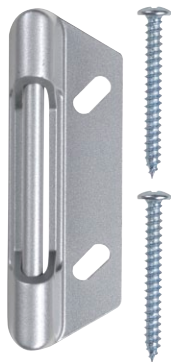

- Resilient Strike Plate
- Slotted holes for easy adjustment
- Installation screws included

Catalog #	Color/Finish	Carton Qty.	UPC	I2of5	Packaging				Master Carton			
					Height (in.)	Width (in.)	Depth (in.)	Weight (lbs.)	Height (in.)	Width (in.)	Depth (in.)	Weight (lbs.)
V777ST	Aluminum	10	038462-003413	20038462-003417	4.75	3.75	0.8	0.08	4.25	4.75	5	0.82
V777STBL	Black	10	038462-003420	20038462-003424	4.75	3.75	0.8	0.08	4.25	4.75	5	0.82
V777STWH	White	10	038462-003444	20038462-003448	4.75	3.75	0.8	0.08	4.25	4.75	5	0.82

## Push Button Latch Replacement Strike Plate

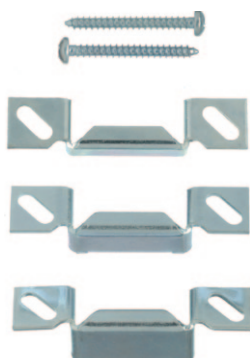

- 1/4", 3/8" and 1/2" solid strike plates provided
- Slotted holes for easy adjustment
- Installation screws included

Catalog #	Color/Finish	Carton Qty.	UPC	I2of5	Packaging				Master Carton			
					Height (in.)	Width (in.)	Depth (in.)	Weight (lbs.)	Height (in.)	Width (in.)	Depth (in.)	Weight (lbs.)
V333ST	Zinc Plated	10	038462-049305	20038462-049309	4.75	3.75	1.25	0.1	5	8	4	1.11



# JAMB BRACKETS AND STORM CHAIN

- **Florida Jamb Bracket**
- **Jamb Bracket**
- **Repair Jamb Bracket**
- **Spring and Chain Door Retainer**



## Florida Jamb Bracket



- Replacement jamb bracket for post mounted closers
- For use with V820, V920, V1020, V150 and VH440

Catalog #	Color/Finish	Carton Qty.	UPC	I2of5	Packaging				Master Carton			
					Height (in.)	Width (in.)	Depth (in.)	Weight (lbs.)	Height (in.)	Width (in.)	Depth (in.)	Weight (lbs.)
FJBBZ	Bronze	5	038462-077858	10038462-077855	6.75	3.75	2	0.1	4.25	7.25	6.5	0.72
FJBWH	White	5	038462-077841	10038462-077848	6.75	3.75	2	0.1	4.25	7.25	6.5	0.72

## Jamb Bracket



- Replacement jamb bracket for V820, V920, V1020, V150 and VH440 closers

Catalog #	Color/Finish	Carton Qty.	UPC	I2of5	Packaging				Master Carton			
					Height (in.)	Width (in.)	Depth (in.)	Weight (lbs.)	Height (in.)	Width (in.)	Depth (in.)	Weight (lbs.)
V1020JB	Aluminum	5	038462-005608	10038462-005605	5.75	3.875	1.59	0.16	7.37	6.87	3.75	1
V1020JBBL	Black	5	038462-005622	10038462-005629	5.75	3.875	1.59	0.16	7.37	6.87	3.75	1

## Repair Jamb Bracket



- Used as a replacement for brackets that have been pulled out by wind or over extension
- Larger mounting area to cover existing mounting holes
- More screw locations for added bracket strength
- Installation screws included

Catalog #	Color/Finish	Carton Qty.	UPC	I2of5	Packaging				Master Carton			
					Height (in.)	Width (in.)	Depth (in.)	Weight (lbs.)	Height (in.)	Width (in.)	Depth (in.)	Weight (lbs.)
V1020RJB	Aluminum	6	038462-778205	60038462-778207	5.75	4.75	2	0.24	6.5	7.25	6.5	1.8
V1020RJBBL	Black	6	038462-778229	60038462-778221	5.75	4.75	2	0.24	6.5	7.25	6.5	1.8
V1020RJBWH	White	6	038462-778243	60038462-778245	5.75	4.75	2	0.24	6.5	7.25	6.5	1.8

## Spring and Chain Door Retainer



- Helps prevent door closer damage
- Installation brackets and screws included

Catalog #	Color/Finish	Carton Qty.	UPC	I2of5	Packaging				Master Carton			
					Height (in.)	Width (in.)	Depth (in.)	Weight (lbs.)	Height (in.)	Width (in.)	Depth (in.)	Weight (lbs.)
V11	Zinc Plated	5	038462-005905	10038462-005902	8.625	3.75	1.188	0.4	4.125	8.75	6	2
V11BL	Black	5	038462-005929	10038462-005926	8.625	3.75	1.188	0.4	4.125	8.75	6	2

# **PNEUMATIC & HYDRAULIC CLOSERS**

- **Light Duty**
- **Standard Duty**
- **Medium Duty**
- **Heavy Duty**
- **Easy Touch**
- **TAP-N-GO**





## Standard Duty Pneumatic Door Closer



- For outswinging wood or metal doors
- Full 90 degree opening
- Adjustable closing speed
- Factory lubricated
- Two hole end plug for adjustable latching power
- Use alone for light and medium weight doors or in pairs for heavier full view storm doors
- All installation hardware included

Catalog #	Color/Finish	Carton Qty.	UPC	I2of5	Packaging				Master Carton			
					Height (in.)	Width (in.)	Depth (in.)	Weight (lbs.)	Height (in.)	Width (in.)	Depth (in.)	Weight (lbs.)
V1020	Aluminum	6	038462-004014	60038462-004016	15.75	3.875	1.5	0.89	4.5	16.25	8.5	5.95
V1020BL	Black	6	038462-004021	60038462-004023	15.75	3.875	1.5	0.89	4.5	16.25	8.5	5.95
V1020WH	White	6	038462-004045	60038462-004047	15.75	3.875	1.5	0.89	4.5	16.25	8.5	5.95
V920	Aluminum	6	038462-004311	60038462-004313	15.75	3.875	1.5	0.89	4.5	16.25	8.5	5.95
V920BL	Black	6	038462-004328	60038462-004320	15.75	3.875	1.5	0.89	4.5	16.25	8.5	5.95
V920WH	White	6	038462-004342	60038462-004344	15.75	3.875	1.5	0.89	4.5	16.25	8.5	5.95

## Heavy Duty Pneumatic Door Closer



- For outswinging wood or metal doors
- Full 90 degree opening
- Adjustable closing speed
- Factory lubricated
- Two hole end plug for adjustable latching power
- Use alone for heavier full view storm and security doors
- All installation hardware included

Catalog #	Color/Finish	Carton Qty.	UPC	I2of5	Packaging				Master Carton			
					Height (in.)	Width (in.)	Depth (in.)	Weight (lbs.)	Height (in.)	Width (in.)	Depth (in.)	Weight (lbs.)
V150	Aluminum	6	038462-003710	60038462-003712	15.75	3.875	1.84	1.09	4.5	16.25	9.75	7.23
V150BL	Black	6	038462-003727	60038462-003729	15.75	3.875	1.84	1.09	4.5	16.25	9.75	7.23
V150WH	White	6	038462-003741	60038462-003743	15.75	3.875	1.84	1.09	4.5	16.25	9.75	7.23
V150BN	Brown	6	038462-882988	60038462-882980	15.75	3.875	1.84	1.09	4.5	16.25	9.75	7.23

## Heavy Duty Pneumatic Door Closer



- Leaf spring provides a smoother, more positive action
- For outswinging wood or metal doors
- Full 90 degree opening
- Adjustable closing speed
- Factory lubricated
- Two hole end plug for adjustable latching power
- Use alone for heavier full view storm and security doors
- All installation hardware included

Catalog #	Color/Finish	Carton Qty.	UPC	I2of5	Packaging				Master Carton			
					Height (in.)	Width (in.)	Depth (in.)	Weight (lbs.)	Height (in.)	Width (in.)	Depth (in.)	Weight (lbs.)
V170BL	Black	6	038462-048926	60038462-048928	16.625	4.75	1.75	1.38	16.93	6.44	6.31	8.75
V170	Aluminum	6	038462-883015	60038462-883017	16.625	4.75	1.75	1.38	16.93	6.44	6.31	8.75
V170WH	White	6	038462-646146	60038462-883048	16.625	4.75	1.75	1.38	16.93	6.44	6.31	8.75
V170BN	Brown	6	038462-883084	60038462-883086	16.625	4.75	1.75	1.38	16.93	6.44	6.31	8.75

## Easy Touch Standard Duty Pneumatic Door Closer



- For outswinging wood or metal doors
- Full 90 degree opening
- Easy dial speed adjuster
- Dial hold open
- Custom jamb bracket cover
- Factory lubricated
- Use alone for light and medium weight doors or in pairs for heavier full view storm doors
- All installation hardware included

Catalog #	Color/Finish	Carton Qty.	UPC	I2of5	Packaging				Master Carton			
					Height (in.)	Width (in.)	Depth (in.)	Weight (lbs.)	Height (in.)	Width (in.)	Depth (in.)	Weight (lbs.)
V2000BL	Black	6	038462-075823	60038462-075825	15.75	3.875	2.05	0.97	4.5	16.25	11	6.57
V2000WH	White	6	038462-075847	60038462-075849	15.75	3.875	2.05	0.97	4.5	16.25	11	6.57
V2000BN	Brown	6	038462-883183	60038462-883185	15.75	3.875	2.05	0.97	4.5	16.25	11	6.57

U.S. Patent 6,317,922

## Medium Duty Pneumatic Door Closer



- External spring for prevention of rod overextension
- For outswinging wood or metal doors
- Full 90 degree opening
- Adjustable closing speed
- Factory lubricated
- Two hole end plug for adjustable latching power
- Use alone for heavier full view storm and security doors
- Installation hardware, wide and narrow door brackets included

Catalog #	Color/Finish	Carton Qty.	UPC	I2of5	Packaging				Master Carton			
					Height (in.)	Width (in.)	Depth (in.)	Weight (lbs.)	Height (in.)	Width (in.)	Depth (in.)	Weight (lbs.)
V2105	Aluminum	6	38462-041415	60038462-041417	16.75	4	2.1	1.22	5.25	18	9.125	8.07
V2105BL	Black	6	38462-041422	60038462-041424	16.75	4	2.1	1.22	5.25	18	9.125	8.07

## Heavy Duty Torsion Spring Door Closer



- For outswinging and inswinging heavy storm doors and light exterior doors
- Full 90 degree opening
- Adjustable closing speed
- Factory lubricated
- Two hole end plug for adjustable latching power
- All installation hardware included

Catalog #	Color/Finish	Carton Qty.	UPC	I2of5	Packaging				Master Carton			
					Height (in.)	Width (in.)	Depth (in.)	Weight (lbs.)	Height (in.)	Width (in.)	Depth (in.)	Weight (lbs.)
V660	Aluminum	5	038462-041514	10038462-041511	18	4.5	2.4	2.3	18.5	13.25	6.75	19.4
V660BL	Black	5	038462-041521	10038462-041528	18	4.5	2.4	2.3	18.5	13.25	6.75	19.4

## Light Duty Pneumatic Door Closer



- For outswinging wood or metal doors
- Full 90 degree opening
- Adjustable closing speed
- Factory lubricated
- Two hole end plug for adjustable latching power
- Use alone for light doors
- All installation hardware included

Catalog #	Color/Finish	Carton Qty.	UPC	I2of5	Packaging				Master Carton			
					Height (in.)	Width (in.)	Depth (in.)	Weight (lbs.)	Height (in.)	Width (in.)	Depth (in.)	Weight (lbs.)
V820	Aluminum	6	038462-042313	60038462-042315	15.75	3.875	1.55	0.88	4.5	16	8.5	5.87
V820AFB	Florida Brown	6	038462-041989	60038462-041981	15.75	3.875	1.55	0.88	4.5	16	8.5	5.87
V820AWH	White	6	038462-041941	60038462-041943	15.75	3.875	1.55	0.88	4.5	16	8.5	5.87
V820BL	Black	6	038462-042320	60038462-042322	15.75	3.875	1.55	0.88	4.5	16	8.5	5.87

## Light Duty Pneumatic Door Closer



- For head jamb applications on outswinging wood or metal doors
- Full 90 degree opening
- Adjustable closing speed
- Factory lubricated
- Two hole end plug for adjustable latching power
- Use alone for light doors
- All installation hardware included

Catalog #	Color/Finish	Carton Qty.	UPC	I2of5	Packaging				Master Carton			
					Height (in.)	Width (in.)	Depth (in.)	Weight (lbs.)	Height (in.)	Width (in.)	Depth (in.)	Weight (lbs.)
VJ1020CAL	Aluminum	6	038462-019315	60038462-019317	15.75	3.875	1.55	0.85	8.75	16.25	4.5	7.2
VJ1020CALBL	Black	6	038462-019322	60038462-019324	15.75	3.875	1.55	0.85	8.75	16.25	4.5	7.2
VJ1020CALWH	White	6	038462-019346	60038462-019348	15.75	3.875	1.55	0.85	8.75	16.25	4.5	7.2

## TAP-N-GO™ Designer Standard Duty Pneumatic Door Closer



- For outswinging wood or metal doors
- Full 90 degree opening
- Push button hold open feature
- Tool free adjusting screw to adjust the closing speed
- Factory lubricated
- Use alone for light and medium weight doors or with either a V920 or V1020 for heavier full view storm doors
- All installation hardware included

Catalog #	Color/Finish	Carton Qty.	UPC	I2of5	Packaging				Master Carton			
					Height (in.)	Width (in.)	Depth (in.)	Weight (lbs.)	Height (in.)	Width (in.)	Depth (in.)	Weight (lbs.)
V2010WH	White	6	039208-988735	60039208-988737	15.75	3.875	2.44	1.2	4.625	16.25	11	8.2
V2010BL	Black	6	039208-988728	60039208-988720	15.75	3.875	2.44	1.2	4.625	16.25	11	8.2

# HYDRAULIC CLOSERS

## Medium Duty Hydraulic Door Closer



- For outswinging wood or metal doors
- Full 90 degree opening
- Provides smooth "no bounce" action
- Rotate tube to adjust closing speed
- Two hole end plug for adjustable latching power
- Use alone for light and medium weight doors or in pairs for heavier full view storm doors
- All installation hardware included

Catalog #	Color/Finish	Carton Qty.	UPC	I2of5	Packaging				Master Carton			
					Height (in.)	Width (in.)	Depth (in.)	Weight (lbs.)	Height (in.)	Width (in.)	Depth (in.)	Weight (lbs.)
VH440	Aluminum	6	038462-004717	60038462-004719	15.75	3.875	1.5	1.09	4.25	16.25	8.5	7.18
VH440BL	Black	6	038462-004724	60038462-004726	15.75	3.875	1.5	1.09	4.25	16.25	8.5	7.18

# **PERFORMAX**®

- **Residential**
- **Light Commercial**
- **Commercial**



**Residential Door Closer**



- For residential and business doors to 85 Lbs., 36" wide
- Installs in three applications (Standard, Parallel and Top Jamb)
- Adjustable closing speed
- Automatic hold open feature, parallel application 115 degrees and standard or top applications 90 degrees
- Size 1

Catalog #	Color/Finish	Carton Qty.	UPC	I2of5	Packaging				Master Carton			
					Height (in.)	Width (in.)	Depth (in.)	Weight (lbs.)	Height (in.)	Width (in.)	Depth (in.)	Weight (lbs.)
VWC85BG	Beige	6	038462-096644	60038462-096646	5	10.75	3.25	3.21	13.5	8.5	17	22.3
VWC85BN	Brown	6	038462-096682	60038462-096684	5	10.75	3.25	3.21	13.5	8.5	17	22.3

**Residential & Light Commercial Door Closer**



- For residential and light commercial doors to 140 Lbs., 38" wide
- Installs in three applications (Standard, Parallel and Top Jamb)
- Variable closing and latching speeds
- Size 3

Catalog #	Color/Finish	Carton Qty.	UPC	I2of5	Packaging				Master Carton			
					Height (in.)	Width (in.)	Depth (in.)	Weight (lbs.)	Height (in.)	Width (in.)	Depth (in.)	Weight (lbs.)
VWC140BG	Beige	6	038462-096743	60038462-096745	5	10.75	3.25	3.95	13.5	8.75	17.25	25.3
VWC140BN	Brown	6	038462-096781	60038462-096783	5	10.75	3.25	3.95	13.5	8.75	17.25	25.3

**Commercial Door Closer**



- For heavy doors to 200 Lbs., 48" wide interior or 36" wide exterior
- Installs in three applications (Standard, Parallel and Top Jamb)
- Variable closing and latching speeds
- Adjustable backcheck
- Size 5

Catalog #	Color/Finish	Carton Qty.	UPC	I2of5	Packaging				Master Carton			
					Height (in.)	Width (in.)	Depth (in.)	Weight (lbs.)	Height (in.)	Width (in.)	Depth (in.)	Weight (lbs.)
WC200BG	Beige	6	038462-096842	60038462-096844	3.75	12.875	3.25	4.9	13.25	8	12	36.3
WC200BN	Brown	6	038462-096880	60038462-096882	3.75	12.875	3.25	4.9	13.25	8	12	36.3

# HARDWARE SETS



## Lanai Corrosion Resistant Door Hardware Set



- For outswinging wood or metal doors, 3/4" to 1 1/4" thick
- Includes V333 push button latch, V1020 pneumatic closer and FJBWH Florida jamb bracket
- All installation hardware included

Catalog #	Color/Finish	Carton Qty.	UPC	I2of5	Packaging				Master Carton			
					Height (in.)	Width (in.)	Depth (in.)	Weight (lbs.)	Height (in.)	Width (in.)	Depth (in.)	Weight (lbs.)
VLANBZ	Bronze	5	038462-041088	10038462-041085	13.75	5	3.5	1.41	11	14.25	5.5	7.67
VLANWH	White	5	038462-041040	10038462-041047	13.75	5	3.5	1.41	11	14.25	5.5	7.67



# SCREEN DOOR HARDWARE





## Wood Screen Door Hardware Set



- Recommended for light screen doors
- Includes: (2) 3" hinges, #5 door spring, pull-handle, and hook & eye
- All mounting hardware included

Catalog #	Color/Finish	Carton Qty.	UPC	I2of5	Packaging				Master Carton			
					Height (in.)	Width (in.)	Depth (in.)	Weight (lbs.)	Height (in.)	Width (in.)	Depth (in.)	Weight (lbs.)
VS10	Zinc Plated	5	039208-985857	50039208-985852	9.5	4.5	0.85	0.79	9.25	7.25	4.75	4.5
VS10GAL	Galvanized	5	039208-985864	50039208-985869	9.5	4.5	0.85	0.79	9.25	7.25	4.75	4.5
VS10BL	Black	5	039208-993432	50039208-993437	9.5	4.5	0.85	0.79	9.25	7.25	4.75	4.5
VS10BR	Brass Plated	5	039208-993425	50039208-993420	9.5	4.5	0.85	0.79	9.25	7.25	4.75	4.5

## Full Turn Buttons

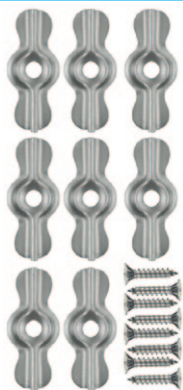

- Full Turn Buttons
- For holding storm sash, screens and combination door panels in place
- 8 per card
- 1 3/4" length

Catalog #	Color/Finish	Carton Qty.	UPC	I2of5	Packaging				Master Carton			
					Height (in.)	Width (in.)	Depth (in.)	Weight (lbs.)	Height (in.)	Width (in.)	Depth (in.)	Weight (lbs.)
V20A-8	Aluminum	10	038462-012217	10038462-012214	4.75	3.625	1.06	0.13	4	10.75	5.25	1.61

## Half Turn Buttons

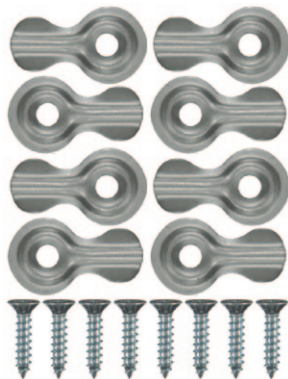

- For holding storm sash, screens and combination door panels in place
- 8 per card
- 1 1/4" length

Catalog #	Color/Finish	Carton Qty.	UPC	I2of5	Packaging				Master Carton			
					Height (in.)	Width (in.)	Depth (in.)	Weight (lbs.)	Height (in.)	Width (in.)	Depth (in.)	Weight (lbs.)
V20A-1/2	Aluminum	5	039208-993548	10039208-993545	4.75	3.625	1.06	0.12	4	10.75	5.25	1.61

## Snap Fastener

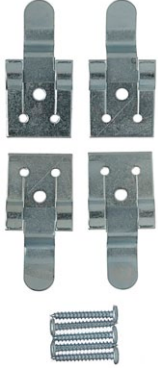

- Holds storm windows, screens and combination door panels firmly in frames
- Snap plate is made of tempered spring steel
- Snap action of fastener allows easy installation and removal of panels
- 4 per card

Catalog #	Color/Finish	Carton Qty.	UPC	I2of5	Packaging				Master Carton			
					Height (in.)	Width (in.)	Depth (in.)	Weight (lbs.)	Height (in.)	Width (in.)	Depth (in.)	Weight (lbs.)
V29	Zinc Plated	10	038462-011302	10038462-011309	4.75	3.75	0.87	0.14	8.125	4.875	5.75	2

## V35 3" Steel Hinges

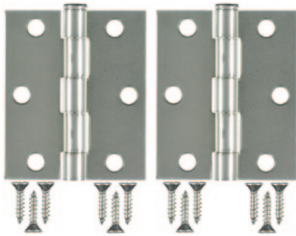

- 3" x 2.5" x .08" steel zinc
- 2 hinges per card
- All mounting screws included

Catalog #	Color/Finish	Carton Qty.	UPC	I2of5	Packaging				Master Carton			
					Height (in.)	Width (in.)	Depth (in.)	Weight (lbs.)	Height (in.)	Width (in.)	Depth (in.)	Weight (lbs.)
V35	Zinc Plated	5	039208-988742	50039208-988747	5.5	3.875	0.85	0.62	6	4.375	4.375	2.9
V35BL	Black	5	039208-993333	50039208-993338	5.5	3.875	0.85	0.62	6	4.375	4.375	2.9
V35GAL	Galvanized	5	039208-993340	50039208-993345	5.5	3.875	0.85	0.62	6	4.375	4.375	2.9
V35BR	Brass Plated	5	039208-993326	50039208-993321	5.5	3.875	0.85	0.62	6	4.375	4.375	2.9

## Door Catch



- Smooth rocking action allows you to engage your door with minimal resistance, providing a secure shut while reducing slamming of the door.
- All installation hardware included

Catalog #	Color/Finish	Carton Qty.	UPC	I2of5	Packaging				Master Carton			
					Height (in.)	Width (in.)	Depth (in.)	Weight (lbs.)	Height (in.)	Width (in.)	Depth (in.)	Weight (lbs.)
V12	Zinc Plated	5	038462-013207	50038462-013202	5.75	3.75	2	0.18	7.375	6.875	3.75	1

## Panel Clips & Knurled Screws



- Heavy extruded aluminum clips fit most screen or storm door panels
- Aluminum knurled screws
- Corrosion resistant
- 8 per card

Catalog #	Color/Finish	Carton Qty.	UPC	I2of5	Packaging				Master Carton			
					Height (in.)	Width (in.)	Depth (in.)	Weight (lbs.)	Height (in.)	Width (in.)	Depth (in.)	Weight (lbs.)
V832CS	Aluminum	10	038462-012309	10038462-012306	4.75	3.625	1.16	0.08	6.625	5.5	4.25	1

## Screen & Storm Sash Hangers



- Interchangeable with most hangers of this type
- Contains two hangers and two eyes per card

Catalog #	Color/Finish	Carton Qty.	UPC	I2of5	Packaging				Master Carton			
					Height (in.)	Width (in.)	Depth (in.)	Weight (lbs.)	Height (in.)	Width (in.)	Depth (in.)	Weight (lbs.)
V99	Zinc Plated	10	038462-011005	10038462-011002	4.75	3.75	0.89	0.2	8.125	4.875	5.75	2
V99GAL	Galvanized	5	039208-993319	10039208-993316	4.75	3.75	0.89	0.2	8.125	4.875	5.75	2

## Screen Door Set



- Recommended for light screen doors
- Kit contains (2) 3" Spring loaded hinges, (1) pull handle, and hook & eye
- All installation hardware included

Catalog #	Color/Finish	Carton Qty.	UPC	I2of5	Packaging				Master Carton			
					Height (in.)	Width (in.)	Depth (in.)	Weight (lbs.)	Height (in.)	Width (in.)	Depth (in.)	Weight (lbs.)
V29H	Brass Plated	5	039208-985871	50039208-985876	8.875	4.5	1.2	0.58	5.25	9.63	7	3.23
V29HZP	Zinc Plated	5	039208-993449	50039208-993444	8.875	4.5	1.2	0.58	5.25	9.63	7	3.23

## 42" Turnbuckle



- Installs on wood screen or storm doors to help prevent warping
- All installation hardware included

Catalog #	Color/Finish	Carton Qty.	UPC	I2of5	Packaging				Master Carton			
					Height (in.)	Width (in.)	Depth (in.)	Weight (lbs.)	Height (in.)	Width (in.)	Depth (in.)	Weight (lbs.)
V591	Zinc Plated	5	039208-993470	50039208-993475	24	2	0.41	0.315	2.125	25.2	3.1	1.76

## 50" Turnbuckle



- Installs on wood screen or storm doors to help prevent warping
- All installation hardware included

Catalog #	Color/Finish	Carton Qty.	UPC	I2of5	Packaging				Master Carton			
					Height (in.)	Width (in.)	Depth (in.)	Weight (lbs.)	Height (in.)	Width (in.)	Depth (in.)	Weight (lbs.)
V691	Zinc Plated	5	039208-985901	50039208-985906	26.875	2	0.55	0.59	2.125	27.88	3.1	3.3

## 2 3/4" Adjustable Self Closing Hinges

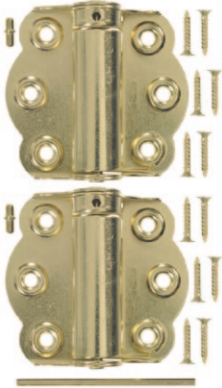

- (2) 2 3/4" Adjustable Self Closing Hinges
- Includes adjusting pins & tool
- All installation hardware included

Catalog #	Color/Finish	Carton Qty.	UPC	I2of5	Packaging				Master Carton			
					Height (in.)	Width (in.)	Depth (in.)	Weight (lbs.)	Height (in.)	Width (in.)	Depth (in.)	Weight (lbs.)
V650	Brass Plated	5	039208-985918	50039208-985913	8.875	4.5	1.03	0.55	7	9.63	5.25	3.13
V650ZP	Zinc Plated	5	039208-993487	50039208-993482	8.875	4.5	1.03	0.55	7	9.63	5.25	3.13
V650BL	Black Painted	5	039208-993494	50039208-993499	8.875	4.5	1.03	0.55	7	9.63	5.25	3.13
V650GAL	Galvanized	5	039208-993500	50039208-993505	8.875	4.5	1.03	0.55	7	9.63	5.25	3.13

## 2 3/4" Self Closing Hinges

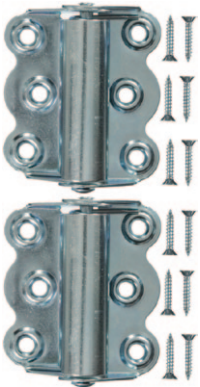

- (2) 2 3/4" Self Closing Hinges
- All installation hardware included

Catalog #	Color/Finish	Carton Qty.	UPC	I2of5	Packaging				Master Carton			
					Height (in.)	Width (in.)	Depth (in.)	Weight (lbs.)	Height (in.)	Width (in.)	Depth (in.)	Weight (lbs.)
V221	Zinc Plated	5	039208-985888	50039208-985883	8.875	4.5	1.11	0.46	5.875	9.625	5.25	2.69
V221GAL	Galvanized	5	039208-985895	50039208-985890	8.875	4.5	1.11	0.46	5.875	9.625	5.25	2.69
V221BR	Brass Plated	5	039208-993456	50039208-993451	8.875	4.5	1.11	0.46	5.875	9.625	5.25	2.69
V221BL	Black	5	039208-993463	50039208-993468	8.875	4.5	1.11	0.46	5.875	9.625	5.25	2.69

## Adjustable Door Spring



- Recommended for light screen doors
- At rest length is adjustable from 13" to 17"
- All installation hardware included

Catalog #	Color/Finish	Carton Qty.	UPC	I2of5	Packaging				Master Carton			
					Height (in.)	Width (in.)	Depth (in.)	Weight (lbs.)	Height (in.)	Width (in.)	Depth (in.)	Weight (lbs.)
V16	Aluminum	10	038462-015102	20038462-015106	15.75	1.75	0.65	0.29	3.25	16	3.75	3.1

## V6 Door Spring



- Recommended for medium screen doors
- At rest length measures 16"x $\frac{1}{2}$ "
- (2)  $\frac{3}{8}$ "x1" J Hooks included

Catalog #	Color/Finish	Carton Qty.	UPC	I2of5	Packaging				Master Carton			
					Height (in.)	Width (in.)	Depth (in.)	Weight (lbs.)	Height (in.)	Width (in.)	Depth (in.)	Weight (lbs.)
V6	Zinc Plated	5	039208-993357	10039208-993354	18.375	1.75	0.69	0.38	2.8	18.5	2.4	1.9

## V4 Door Spring



- Recommended for light screen doors
- At rest length measures 16"x $\frac{3}{8}$ "
- (2)  $\frac{3}{8}$ "x1" J Hooks included

Catalog #	Color/Finish	Carton Qty.	UPC	I2of5	Packaging				Master Carton			
					Height (in.)	Width (in.)	Depth (in.)	Weight (lbs.)	Height (in.)	Width (in.)	Depth (in.)	Weight (lbs.)
V4	Zinc Plated	5	039208-993364	10039208-993361	18.375	1.75	0.69	0.25	2.8	18.5	2.4	1.5

## #4 Door Spring



- Bulk Packed
- Recommended for light screen doors
- At rest length measures 16"x $\frac{3}{8}$ "
- No hooks included

Catalog #	Color/Finish	Carton Qty.	UPC	I2of5	Packaging				Master Carton			
					Height (in.)	Width (in.)	Depth (in.)	Weight (lbs.)	Height (in.)	Width (in.)	Depth (in.)	Weight (lbs.)
#4	Zinc Plated	5	039208-993371	50039208-993376	16	0.316	0.316	0.14	2	16.5	1.8	1.1

## #5 Door Spring



- Bulk Packed
- Recommended for light screen doors
- At rest length measures 16"x $\frac{7}{16}$ "
- No hooks included

Catalog #	Color/Finish	Carton Qty.	UPC	I2of5	Packaging				Master Carton			
					Height (in.)	Width (in.)	Depth (in.)	Weight (lbs.)	Height (in.)	Width (in.)	Depth (in.)	Weight (lbs.)
#5	Zinc Plated	5	039208-993388	50039208-993383	16	0.404	0.404	0.234	2	16.5	1.8	1.5

## #6 Door Spring



- Bulk Packed
- Recommended for medium screen doors
- At rest length measures 16"x $\frac{1}{2}$ "
- No hooks included

Catalog #	Color/Finish	Carton Qty.	UPC	I2of5	Packaging				Master Carton			
					Height (in.)	Width (in.)	Depth (in.)	Weight (lbs.)	Height (in.)	Width (in.)	Depth (in.)	Weight (lbs.)
#6	Zinc Plated	5	039208-993395	50039208-993390	16	0.497	0.497	0.313	2	16.5	1.8	1.8

## #7 Door Spring



- Bulk Packed
- Recommended for medium screen doors
- At rest length measures 16"x<sup>9</sup>/<sub>16</sub>"
- No hooks included

Catalog #	Color/Finish	Carton Qty.	UPC	I2of5	Packaging				Master Carton			
					Height (in.)	Width (in.)	Depth (in.)	Weight (lbs.)	Height (in.)	Width (in.)	Depth (in.)	Weight (lbs.)
#7	Zinc Plated	5	039208-993401	50039208-993406	16	0.561	0.561	0.37	2	16.5	1.8	2.2

## #8 Door Spring



- Bulk Packed
- Recommended screen doors
- At rest length measures 16"x1"
- No hooks included

Catalog #	Color/Finish	Carton Qty.	UPC	I2of5	Packaging				Master Carton			
					Height (in.)	Width (in.)	Depth (in.)	Weight (lbs.)	Height (in.)	Width (in.)	Depth (in.)	Weight (lbs.)
#8	Zinc Plated	5	039208-993418	50039208-993413	16	1.074	1.074	0.98	3.9	17.1	2	5.5

## Vinyl/Wood Screen Door Kit



- For doors 1/2" to 1 3/4" thick
- Kit contains: (3) Spring load hinges, (1) Knobs, (1) Lever, Rosettes and Hook & eye
- All installation hardware

Catalog #	Color/Finish	Carton Qty.	UPC	I2of5	Packaging				Master Carton			
					Height (in.)	Width (in.)	Depth (in.)	Weight (lbs.)	Height (in.)	Width (in.)	Depth (in.)	Weight (lbs.)
V321BR	Brass	5	039208-993517	50039208-993512	12.125	5.375	2.25	1.1	10.2	12	5.3	7
V321SN	Satin Nickel	5	039208-993524	50039208-993529	12.125	5.375	2.25	1.1	10.2	12	5.3	7
V321WH	White	5	039208-993531	50039208-993536	12.125	5.375	2.25	1.1	10.2	12	5.3	7

## 4 3/4" Pull Handles



- Pull handles for use on Screen Doors, drawers or other light weight doors
- Installation screws included

Catalog #	Color/Finish	Carton Qty.	UPC	I2of5	Packaging				Master Carton			
					Height (in.)	Width (in.)	Depth (in.)	Weight (lbs.)	Height (in.)	Width (in.)	Depth (in.)	Weight (lbs.)
V434	Zinc Plated	5	039208-993562	50039208-993567	6.875	2.25	1.02	0.06	5.6	7.2	2.4	0.5
V434BR	Brass	5	039208-993555	50039208-993550	6.875	2.25	1.02	0.06	5.6	7.2	2.4	0.5
V434BL	Black	5	039208-993579	50039208-993574	6.875	2.25	1.02	0.06	5.6	7.2	2.4	0.5
V434GAL	Galvanized	5	039208-993586	50039208-993581	6.875	2.25	1.02	0.06	5.6	7.2	2.4	0.5

## Key Locking Deadbolt



- For wood or metal doors  $\frac{5}{8}$ " -  $1\frac{1}{2}$ " thick
- Key operated outside and thumb turn inside
- $1\frac{3}{4}$ " mounting hole spacing
- All installation hardware included

Catalog #	Color/Finish	Carton Qty.	UPC	I2of5	Packaging				Master Carton			
					Height (in.)	Width (in.)	Depth (in.)	Weight (lbs.)	Height (in.)	Width (in.)	Depth (in.)	Weight (lbs.)
V114BL	Black	5	038462-045123	10038462-045120	6.75	5.75	1.7	0.7	9.37	7.12	4.62	3



# PATIO HARDWARE





## Surface Mounted Patio Door Latch



- For right or left hand application on doors 1" to 1 1/4" thick
- 3<sup>15</sup>/<sub>16</sub>" installation hole spacing
- "No Lock Out" feature
- All installation hardware included

Catalog #	Color/Finish	Carton Qty.	UPC	I2of5	Packaging				Master Carton			
					Height (in.)	Width (in.)	Depth (in.)	Weight (lbs.)	Height (in.)	Width (in.)	Depth (in.)	Weight (lbs.)
V1104	Aluminum	6	038462-028812	60038462-028814	11.625	5.625	2.5	0.91	17.5	13.5	4	6.5

## Patio Door Handle



- For use with V1195 and VK1195 patio door latches
- Oak Handle

Catalog #	Color/Finish	Carton Qty.	UPC	I2of5	Packaging				Master Carton			
					Height (in.)	Width (in.)	Depth (in.)	Weight (lbs.)	Height (in.)	Width (in.)	Depth (in.)	Weight (lbs.)
V1147H	Aluminum	6	038462-029116	60038462-029118	11.625	5.625	1.3	0.43	17.5	13.5	4	3.6

## Keyed Surface Mounted Patio Door Latch



- For right or left hand application on doors 1" to 1 1/4" thick
- 3<sup>15</sup>/<sub>16</sub>" installation hole spacing
- Key lock for extra security
- "No Lock Out" feature
- All installation hardware included

Catalog #	Color/Finish	Carton Qty.	UPC	I2of5	Packaging				Master Carton			
					Height (in.)	Width (in.)	Depth (in.)	Weight (lbs.)	Height (in.)	Width (in.)	Depth (in.)	Weight (lbs.)
VK1104	Aluminum	6	038462-028614	60038462-028616	11.625	5.625	2.5	0.71	17.5	13.5	4	5.2

**Flush Mounted Patio Door Latch**



- For right or left hand application on doors 1" to 1 1/4" thick
- 1/16" projection on inside and outside of patio door
- Includes four different latch hooks for different applications
- 6 1/2" installation hole spacing
- All installation hardware included

Catalog #	Color/Finish	Carton Qty.	UPC	I2of5	Packaging				Master Carton			
					Height (in.)	Width (in.)	Depth (in.)	Weight (lbs.)	Height (in.)	Width (in.)	Depth (in.)	Weight (lbs.)
V1195	Aluminum	6	038462-029017	60038462-029019	9.75	4.625	1.33	0.64	18.25	11.37	3.75	4.7

**Keyed Flush Mounted Patio Door Latch**



- For right or left hand application on doors 1" to 1 1/4" thick
- 1/16" projection on inside and outside of patio door
- Key lock for extra security
- Includes four different latch hooks for different applications
- 6 1/2" installation hole spacing
- All installation hardware included

Catalog #	Color/Finish	Carton Qty.	UPC	I2of5	Packaging				Master Carton			
					Height (in.)	Width (in.)	Depth (in.)	Weight (lbs.)	Height (in.)	Width (in.)	Depth (in.)	Weight (lbs.)
VK1195	Aluminum	6	038462-028713	60038462-028715	9.5	4.625	1.33	1	18.25	11.37	3.75	7

**Patio Door Pin Lock**



- Locks sliding door or window to opposite panel
- No key required.
- Installs in 1/4" hole
- Pin holder included for storage when not in use
- All installation hardware included

Catalog #	Color/Finish	Carton Qty.	UPC	I2of5	Packaging				Master Carton			
					Height (in.)	Width (in.)	Depth (in.)	Weight (lbs.)	Height (in.)	Width (in.)	Depth (in.)	Weight (lbs.)
V108	Zinc Plated	10	038462-028508	10038462-028505	4.75	3.75	0.65	0.09	6.6	5.5	4.25	1

# ASSORTMENTS & DISPLAYS

**Top Seller POG with Screen Door Hardware**

Order Assortment by Part#: 91007000



Seq. No.	Part Number	Wright Products Catalog #	Product Description	Ship Pk Quantity	Qty. Per Assort.	UPC
1	97176123	V150WH	Heavy Duty Pneumatic Closer, White	6	2	038462-003741
2	97176070	V150BL	Heavy Duty Pneumatic Closer, Black	6	2	038462-003727
3	97178123	V1020WH	Pneumatic Closer, White	6	2	038462-004045
4	97178070	V1020BL	Pneumatic Closer, Black	6	2	038462-004021
5	97100007	V11	Spring & Chain Door Retainer, Zinc Plated	5	2	038462-005905
6	97100003	V11BL	Spring & Chain Door Retainer, Black	5	2	038462-005929
7	97782123	V1020RJBWH	Replacement Repair Jamb Bracket, White	6	2	038462-778243
8	97782070	V1020RJBBL	Replacement Repair Jamb Bracket, Black	6	2	038462-778229
9	97179123	V333WH	Push Button Latch, White	6	2	038462-002140
10	97180070	VC333BL	Colonial Push Button Latch, Black	6	2	038462-002324
11	97666123	VK333X3WH	Keyed Push Button Latch, White	6	2	038462-002041
12	97175070	VCK333X3BL	Keyed Colonial Push Button Latch, Black	6	2	038462-002423
13	97280120	V16	Adjustable Door Spring, Zinc Plated	10	2	038462-015102
14	98004007	V691	50" Turnbuckles, Zinc Plated	5	2	039208-985901
15	97590120	V670	Universal Knob Latch, Aluminum	6	2	038462-759013
16	97590070	V670BL	Universal Knob Latch, Black	6	2	038462-759020
17	96475002	V20A-8	Full Turn Buttons, Aluminum	10	2	038462-012217
18	98054007	V12	Door Catch, Zinc Plated	5	2	038462-013207
19	98000007	V510	Wood Screen Door Hardware Set, Zinc Plated	5	2	039208-985857
20	98002007	V221	2-3/4" Spring Loaded Hinges, Zinc Plated	5	2	039208-985888
21	98006004	V650	2-3/4" Adjustable Spring Loaded Hinges, Brass Plate	5	2	039208-985918
22	98001004	V29H	Self-Closing Hinge & Latch Kit, Brass Plate	5	2	039208-985871

Note: POG measures 4' tall x 2-1/2' wide

**Top Seller POG**

Order Assortment by Part#: 91009000

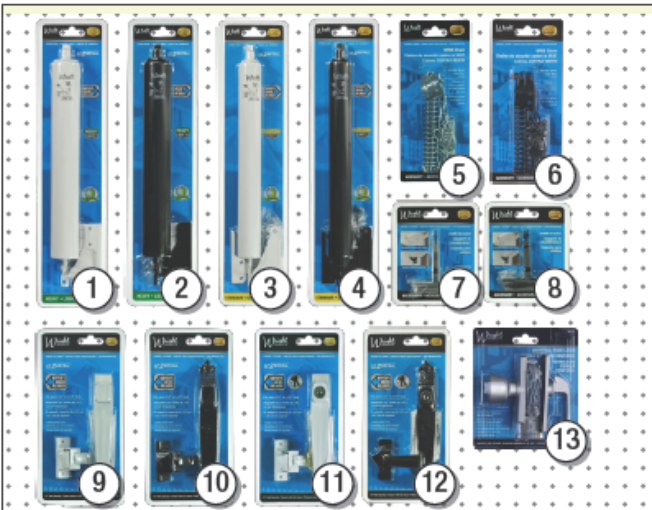

Seq. No.	Part Number	Wright Products Catalog #	Product Description	Ship Pk Quantity	Qty. Per Assort.	UPC
1	97176123	V150WH	Heavy Duty Pneumatic Closer, White	6	2	038462-003741
2	97176070	V150BL	Heavy Duty Pneumatic Closer, Black	6	2	038462-003727
3	97178123	V1020WH	Pneumatic Closer, White	6	2	038462-004045
4	97178070	V1020BL	Pneumatic Closer, Black	6	2	038462-004021
5	97100007	V11	Spring & Chain Door Retainer, Zinc Plated	5	2	038462-005905
6	97100003	V11BL	Spring & Chain Door Retainer, Black	5	2	038462-005929
7	97782123	V1020RJBWH	Replacement Repair Jamb Bracket, White	6	2	038462-778243
8	97782070	V1020RJBBL	Replacement Repair Jamb Bracket, Black	6	2	038462-778229
9	97179123	V333WH	Push Button Latch, White	6	2	038462-002140
10	97180070	VC333BL	Colonial Push Button Latch, Black	6	2	038462-002324
11	97666123	VK333X3WH	Keyed Push Button Latch, White	6	2	038462-002041
12	97175070	VCK333X3BL	Keyed Colonial Push Button Latch, Black	6	2	038462-002423
13	97590120	V670	Universal Knob Latch, Aluminum	6	2	038462-759013

Note: POG measures 2-1/4' tall x 2-1/2' wide

## All Inclusive Screen Door Assortment

Order Assortment by Part#: 91018000

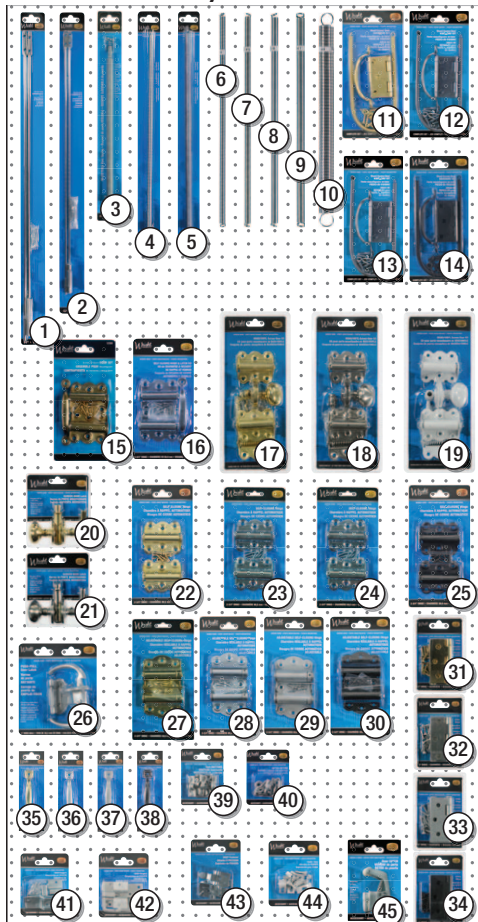

Seq. No.	Part Number	Wright Products Catalog #	Product Description	Ship Pk Quantity	Qty. Per Assort.	UPC
1	98004007	V691	50" Turnbuckle	5	2	039208-985901
2	98003007	V591	42" Turnbuckle	5	2	039208-993470
3	97280120	V16	Adjustable Door Spring	10	2	038462-015102
4	97501007	V4	#4 Door Spring w/hooks 16" x 3/8"	5	2	039208-993364
5	97500007	V6	#6 Door Spring w/hooks 16" x 1/2"	5	2	039208-993357
6	97504007	#4	#4 Door Spring 16" x 3/8" (Bulk)	5	2	039208-993371
7	97505007	#5	#5 Door Spring 16" x 7/16" (Bulk)	5	2	039208-993388
8	97506007	#6	#6 Door Spring 16" x 1/2" (Bulk)	5	2	039208-993395
9	97507007	#7	#7 Door Spring 16" x 9/16" (Bulk)	5	2	039208-993401
10	97508007	#8	#8 Door Spring 1" (Bulk)	5	2	039208-993418
11	98000004	VS10BR	Screen/Storm Door Set w/Spring	5	2	039208-993425
12	98000007	VS10	Screen/Storm Door Set w/Spring	5	2	039208-985857
13	98000188	VS10GAL	Screen/Storm Door Set w/Spring	5	2	039208-985864
14	98000070	VS10BL	Screen/Storm Door Set w/Spring	5	2	039208-993432
15	98001004	V29H	Screen & Storm Door Set	5	2	039208-985871
16	98001007	V29H2P	Screen & Storm Door Set	5	2	039208-993449
17	98053004	V321BR	Vinyl Screen Door Kit	5	2	039208-993517
18	98053009	V321SN	Vinyl Screen Door Kit	5	2	039208-993524
19	98053123	V321WH	Vinyl Screen Door Kit	5	2	039208-993531
20	98667010	V2200BR	Screen Door Mortise Latch	5	2	038462-042184
21	98667009	V2200SN	Screen Door Mortise Latch	5	2	039208-988704
22	98002004	V221BR	Hinge, Self Closing 2-3/4"	5	2	039208-993456
23	98002007	V221	Hinge, Self Closing 2-3/4"	5	2	039208-985888
24	98002188	V221GAL	Hinge, Self Closing 2-3/4"	5	2	039208-985895
25	98002070	V221BL	Hinge, Self Closing 2-3/4"	5	2	039208-993463
26	97272120	V1000	Push Pull Latch	5	2	038462-002713
27	98006004	V650	Hinge, Adjustable Self-Closing 2-3/4"	5	2	039208-985918
28	98006007	V6502P	Hinge, Adjustable Self-Closing 2-3/4"	5	2	039208-993487
29	98006188	V650GAL	Hinge, Adjustable Self-Closing 2-3/4"	5	2	039208-993500
30	98006070	V650BL	Hinge, Adjustable Self-Closing 2-3/4"	5	2	039208-993494
31	97043004	V35BR	Hinge, Steel 3" x 25" x 008"	5	2	039208-993326
32	97043007	V35	Hinge, Steel 3" x 25" x 008"	5	2	039208-988742
33	97043188	V35GAL	Hinge, Steel 3" x 25" x 008"	5	2	039208-993340
34	97043070	V35BL	Hinge, Steel 3" x 25" x 008"	5	2	039208-993333
35	98056004	V434BR	4-3/4" Screen Door Pull	5	2	039208-993555
36	98056007	V434	4-3/4" Screen Door Pull	5	2	039208-993562
37	98056188	V434GAL	4-3/4" Screen Door Pull	5	2	039208-993586
38	98056070	V434BL	4-3/4" Screen Door Pull	5	2	039208-993579
39	96475002	V20A-8	Full Turn Buttons	10	2	038462-012217
40	98055002	V20A-1/2	Half Turn Buttons	10	2	039208-993548
41	96474007	V99	Sash Hanger	10	2	038462-011005
42	96474188	V99GAL	Sash Hanger	10	2	039208-993319
43	97269007	V29	Snap Fasteners	10	2	038462-011302
44	97271013	V832CS	Storm Door Clips	10	2	038462-012309
45	98054007	V12	Door Catch	5	2	038462-013207

Note: POG measures 4' tall x 2-1/2' wide

## Small Screen Door Assortment

Order Assortment by Part#: 91019000

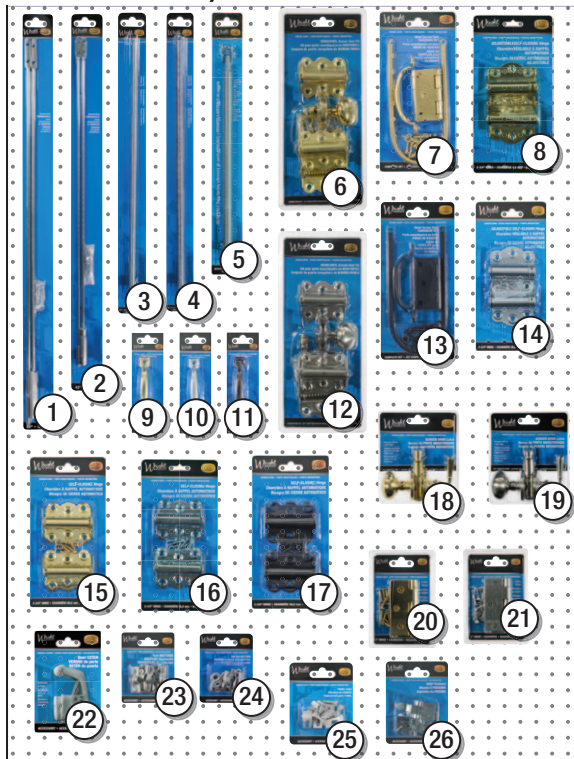

Seq. No.	Part Number	Wright Products Catalog #	Product Description	Ship Pk Quantity	Qty. Per Assort.	UPC
1	98004007	V691	50" Turnbuckle	5	2	039208-985901
2	98003007	V591	42" Turnbuckle	5	2	039208-993470
3	97501007	V4	#4 Door Spring w/hooks 16" x 3/8"	5	2	039208-993364
4	97500007	V6	#6 Door Spring w/hooks 16" x 1/2"	5	2	039208-993357
5	97280120	V16	Adjustable Door Spring	10	2	038462-015102
6	98053004	V321BR	Vinyl Screen Door Kit	5	2	039208-993517
7	98000004	VS10BR	Screen/Storm Door Set w/Spring	5	2	039208-993425
8	98006004	V650	Hinge, Adjustable Self-Closing 2-3/4"	5	2	039208-985918
9	98056004	V434BR	4-3/4" Screen Door Pull	5	2	039208-993555
10	98056007	V434	4-3/4" Screen Door Pull	5	2	039208-993562
11	98056188	V434GAL	4-3/4" Screen Door Pull	5	2	039208-993586
12	98053009	V321SN	Vinyl Screen Door Kit	5	2	039208-993524
13	98000070	VS10BL	Screen/Storm Door Set w/Spring	5	2	039208-993432
14	98006007	V6502P	Hinge, Adjustable Self-Closing 2-3/4"	5	2	039208-993487
15	98002004	V221BR	Hinge, Self Closing 2-3/4"	5	2	039208-993456
16	98002007	V221	Hinge, Self Closing 2-3/4"	5	2	039208-985888
17	98002070	V221BL	Hinge, Self Closing 2-3/4"	5	2	039208-993463
18	98667010	V2200BR	Screen Door Mortise Latch	5	2	038462-042184
19	98667009	V2200SN	Screen Door Mortise Latch	5	2	039208-988704
20	97043004	V35BR	Hinge, Steel 3" x 25" x 008"	5	2	039208-993326
21	97043007	V35	Hinge, Steel 3" x 25" x 008"	5	2	039208-988742
22	98054007	V12	Door Catch	5	2	038462-013207
23	96475002	V20A-8	Turn Buttons	10	2	038462-012217
24	98055002	V20A-1/2	Half Turn Buttons	10	2	039208-993548
25	97271013	V832CS	Storm Door Clips	10	2	038462-012309
26	97269007	V29	Snap Fasteners	10	2	038462-011302

Note: POG measures 4' tall x 3' wide

## #276 Standard Floor Display



**Order Display by Part #: 91020000**

#276 Standard Floor Display includes:

Part Number	Wright Product Catalog #	Description	Qty. Per Display
97179123	V333WH	Tie-Down Push Btn Ltch, Wht	6
97179070	V333BL	Tie-Down Push Btn Ltch, Blk	6
97180070	VC333BL	Colonial Tie-Down Push Btn Ltch, Blk	6
97178123	V1020WH	Standard Duty Pneumatic Closer, Wht	6
97178070	V1020BL	Standard Duty Pneumatic Closer, Alum	6
97178120	V1020	Standard Duty Pneumatic Closer, Blk	6
97176123	V150WH	Heavy Dty Pneumatic Closer, Wht	6
97176070	V150BL	Heavy Dty Pneumatic Closer, Blk	6

## Quarter Pallet Display



Fall Header

**Order Display by Part #: 91015000**

Quarter Pallet Display includes:

Part Number	Wright Product Catalog #	Description	Qty. Per Display
97180070	VC333BL	Colonial Tie-Down Push Btn Hdl, Blk	12
97179123	V333WH	Tie-Down Push Btn Hdl, Wht	12
97178070	V1020BL	Standard Dty Pneumatic Closer, Blk	12
97178123	V1020WH	Standard Dty Pneumatic Closer, Wht	12

**Note:**

Quarter pallet will contain a double-sided header for both Fall and Spring offerings.



Spring Header

## Quarter Pallet Display



Fall Header

**Order Display by Part #: 91025000**

Quarter Pallet Display includes:

Part Number	Wright Product Catalog #	Description	Qty. Per Display
97180070	VC333BL	Colonial Tie-Down Push Btn Hdl, Blk	12
97179123	V333WH	Tie-Down Push Btn Hdl, Wht	12
97177070	V920BL	Standard Dty Pneumatic Closer, Blk	12
97177123	V920WH	Standard Dty Pneumatic Closer, Wht	12

**Note:**

Quarter pallet will contain a double-sided header for both Fall and Spring offerings.



Spring Header

## Hampton Products International Corp.

50 Icon  
Foothill Ranch, CA 92610  
www.hamptonproducts.com

### To place orders, check order status or product information:

Customer Care Department  
Hours: 8:00 am to 5:00 pm Pacific Time  
Toll free: (800) 562-5625  
Fax: (949) 472-9657

**PAYMENT TERMS:**      **Net 30 Days**

**MINIMUM ORDER:**      **\$250.00**      Assorted product shipping to one location within the continental United States. FOB Factory.

**PRE-PAID FREIGHT:**      **\$750.00**      Assorted product shipping to one location within the continental United States. FOB Factory.

---

**Pricing:**      All pricing is based on full carton quantities where quantity is indicated in the "Carton Qty." column. Discrepancies should be made in writing within 15 days from the receipt of invoice and include all documents that support your claim. All pricing is subject to change without notice. To reduce errors, please include the pricing on your purchase orders.

**Standard Packs:**      Orders for less than Carton Quantities will be increased to meet the full carton quantities.

**Returned Goods:**      All returned goods require prior approval by our authorized representative and a RGA (Returned Goods Authorization) number prior to their return. Only current catalog part numbers, in their original factory condition, are eligible for credit. Authorization will be considered if request is made within 90 days of shipment and only if credit can be applied to a specific invoice. To obtain an RGA, please contact our Customer Service Department and specify the reason for the return.

A credit memo will be issued upon final inspection of returned goods. To expedite the process, place RGA number on all cartons, bills of lading and debit memos. Returned goods must be shipped freight pre-paid and are subject to a 15% handling charge.



**Hampton Products International Corporation - Corporate Office**  
50 Icon, Foothill Ranch, California 92610

**Our Mission:**

Based in southern California, Hampton Products International Corporation has been in operation since the early 1990's. In late 2008, Wright Products joined the family, adding to Hampton's portfolio of high quality products that include: residential locksets, lighting, timers, builder's hardware, exterior door hardware, cargo management, winches, electronics and portable security.

Hampton's business philosophy is based on providing high quality, innovative products, delivered on time, every time at competitive pricing. This is the same philosophy that Wright Products historically embraced to become the dominant supplier in the S&SD category. Our commitment to you is that we will continue to provide innovative functions, coupled with exciting new designs and finishes to enhance your revenues and maximize your margins. We realize that we succeed only when you succeed.