

ADJUSTABLE SIZE 1 THRU 6 — NON HOLD OPEN DOOR CLOSER

CAUTION! An incorrectly installed or improperly adjusted door closer can cause property damage or personal injury. These instructions should be followed to avoid the possibility of misapplication or misadjustment.

REGULAR ARM INSTALLATION

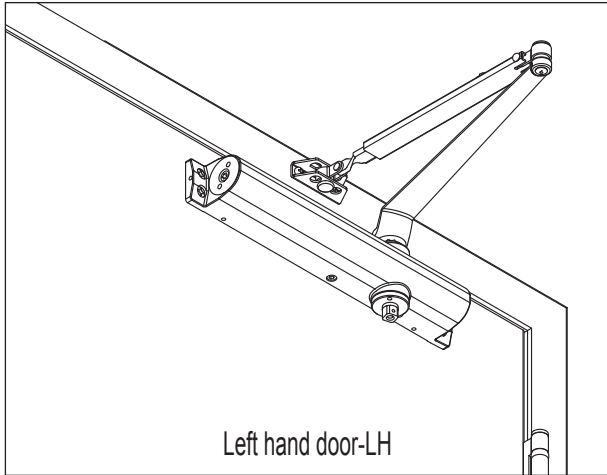

Closer mounts on hinge side of door (pull side).
See Page 3
(Closer cover not shown)

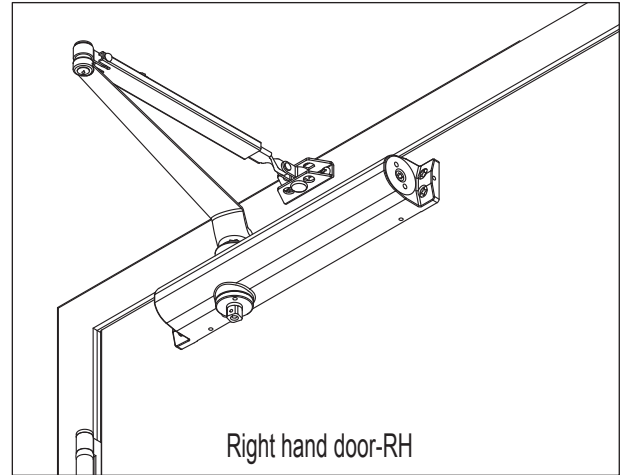

TOP JAMB INSTALLATION

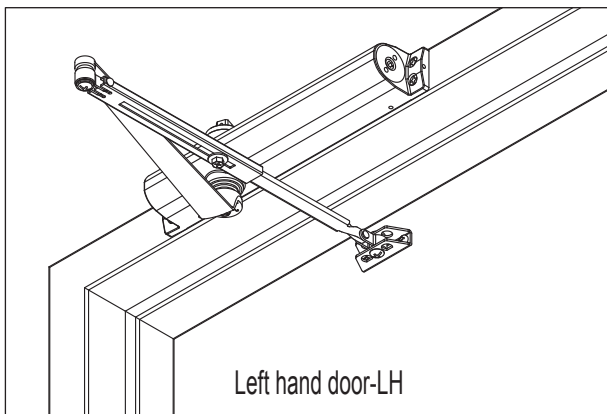

Closer mounts on frame, opposite hinge side of door (push side).
See Page 4
(Closer cover not shown)

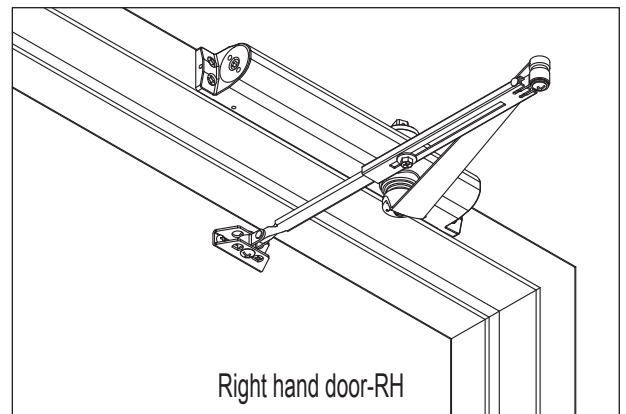

PARALLEL ARM INSTALLATION

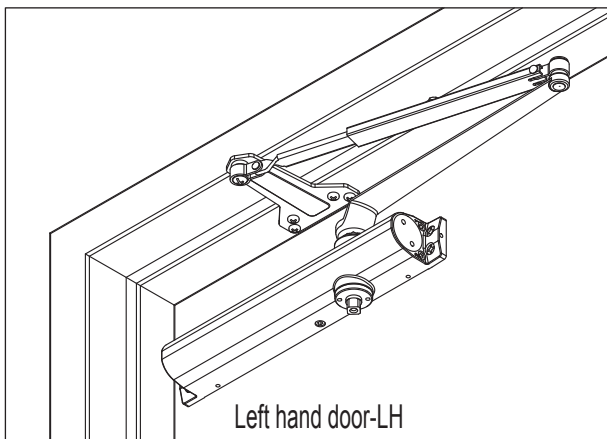

Closer mounts on door, opposite hinge side of door (push side).
See Page 5
(Closer cover not shown)

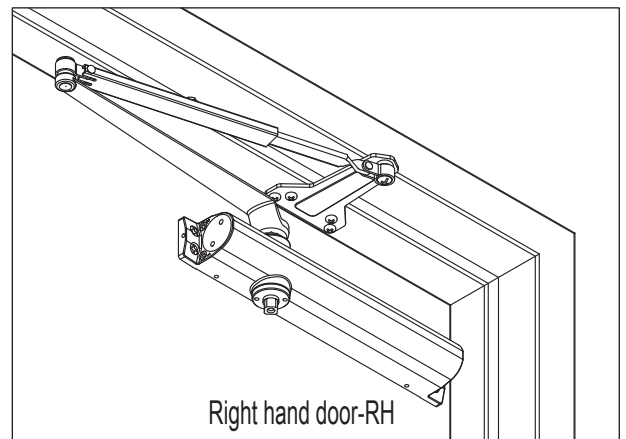
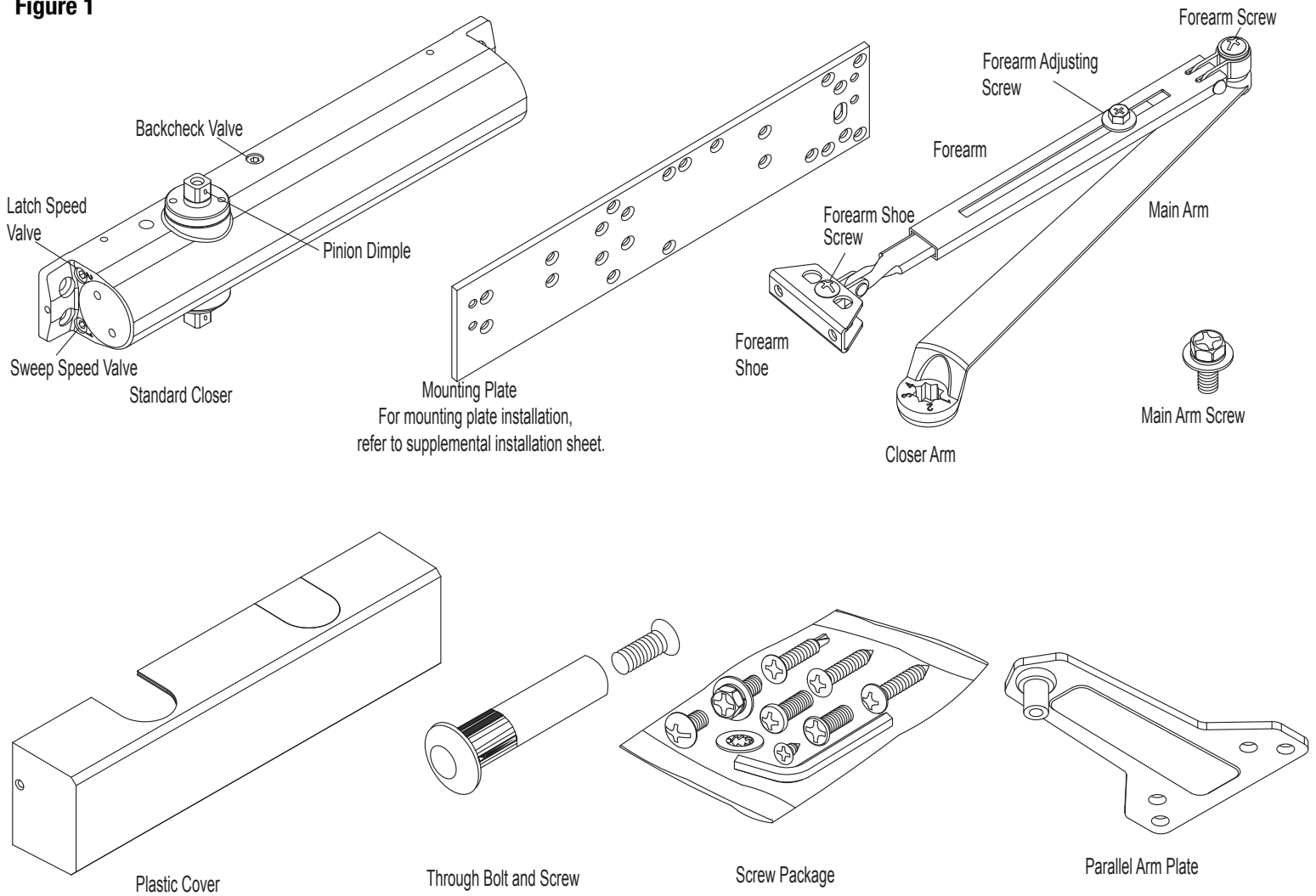

Figure 1



- It is recommended that the door be hung on ball bearing type hinges so door swings freely.
- A separate door stop is recommended (www.universalhardware.com/home/order) to prevent damage to the door closer, closer arm, the door, frame or adjacent walls.
- Door and frame must be properly reinforced or through bolts used to prevent the mounting screws from pulling out.

Figure 2

PREPARATION FOR FASTENERS

Fasteners	Door or Frame	Drill Sizes	Where Used	*Drill Depth
Self Drilling/Tapping Machine Screw	Hollow Metal or Aluminum	3/16"	Closer & Parallel Arm (PA) Plate / Foot	Through one side
1/4"-20 Machine Screw	Hollow Metal or Aluminum	#7 (.201") Drill bit & 1/4"-20 Tap	Closer & Parallel Arm (PA) Plate / Foot	Through one side
1/4"-20 Machine Screw used with Through Bolt	Hollow Metal or Aluminum	9/32" Drill Bit Closer Side & 3/8" Drill Bit Opposite Side	Closer	9/32" - Through Door 3/8" - 1-5/8"
	Wood			
Wood Screw	Wood	1/8" Drill Bit - Softwood	Closer & Parallel Arm (PA) Plate / Foot	1-1/4"
		3/16" Drill Bit - Hardwood		

Notes: Pan head screws are to be used for Parallel Arm (PA) Plate / Foot Measure door thickness before drilling pilot holes to prevent drilling through opposite side.

REGULAR ARM INSTALLATION

999-30027

MODEL UH4061 or UH4062 INSTALLATION INSTRUCTIONS

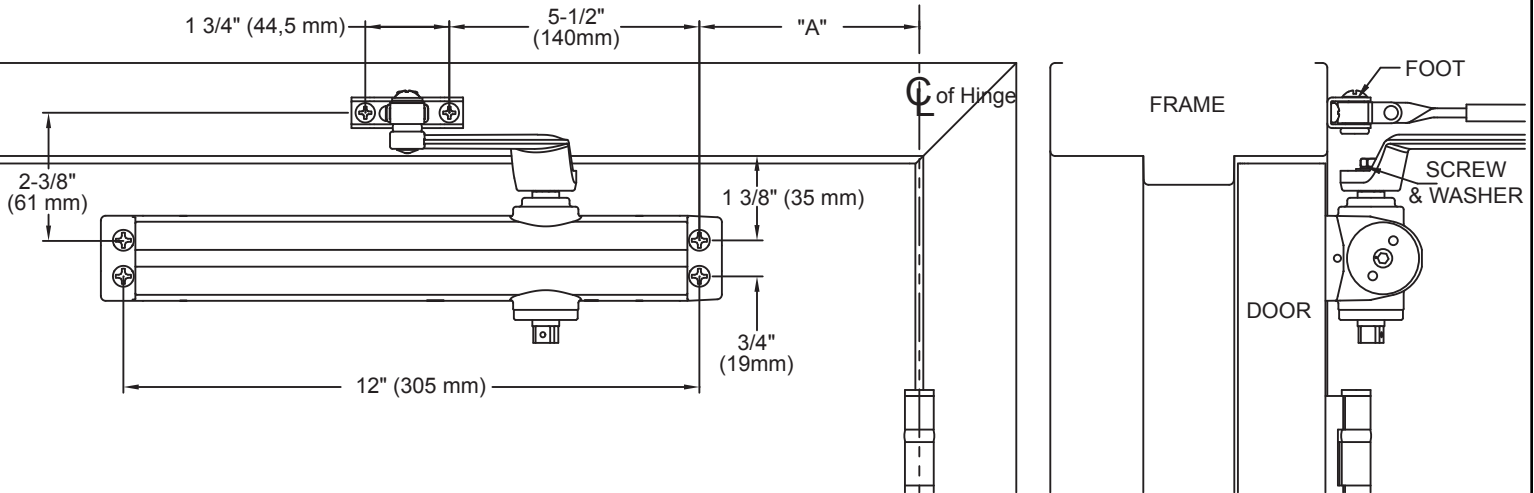

MODEL	DIMENSION "A"		OPENING	DOOR WIDTH		CLOSER SIZE	# OF TURNS OF POWER ADJUSTMENT SCREW	CLOSER SIZE	# OF TURNS OF POWER ADJUSTMENT SCREW
	INCHES	[mm]		INTERIOR	EXTERIOR				
UH4061 UH4062	7-1/2"	191	TO 100°	UP TO 60"	UP TO 48"	6	+12	3	0
						5	+9	2	-5
						4	+4	1	-9
	6"	152	TO 130°	UP TO 60"	UP TO 48"	6	+14	3	0
						5	+10	2	-4
						4	+5	1	-9
4-1/2"	114	TO 180°	UP TO 54"	UP TO 42"	5	+10	3	0	
							2	-5	
					4	+5	♿	-10/-11	

Notes: Closer is shipped at 11 turns. Maximum of 26 turns of power adjustment screw. Refer to Page 6, Fig. 5 to determine proper closer size.

INSTALLATION SEQUENCE

1. Select degree of opening and use dimensions shown to locate 4 holes on door for closer body and 2 holes on frame face for forearm shoe.
2. Prepare door and frame for fasteners (See Preparation for Fasteners, Page 2, Figure 2).
3. Before installing closer body, set spring power for closer using Power Adjustment Chart below.
4. Install closer on pull side of door with speed regulating valves towards the hinge.
5. Disassemble forearm from main arm by removing forearm screw (See Page 2, Figure 1). Fasten forearm shoe and forearm to frame face.
6. Mount main arm onto closer pinion shaft, as illustrated. Secure with main arm screw.
7. Reassemble arm. Adjust forearm length so that it will be perpendicular (at a 90° angle) to the door face. Secure with forearm screw.
8. Adjust closer (See page 6) and install cover.

MAIN ARM INSTALLATION INSTRUCTIONS

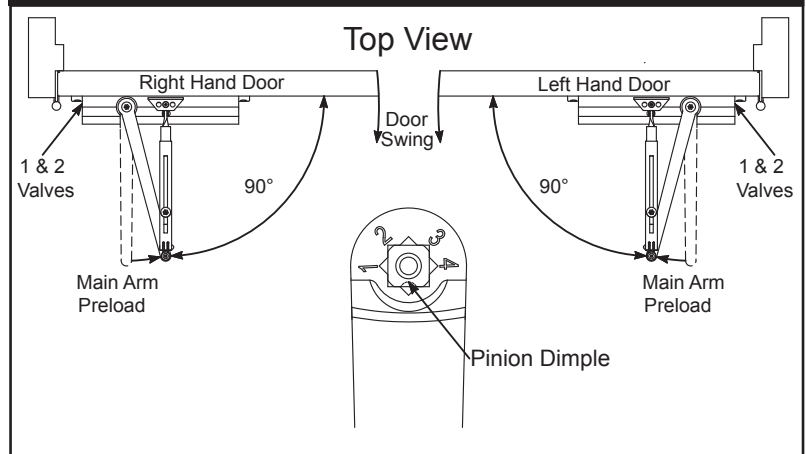

TOP JAMB INSTALLATION

MODEL UH4061 or UH4062 INSTALLATION INSTRUCTIONS

999-30027

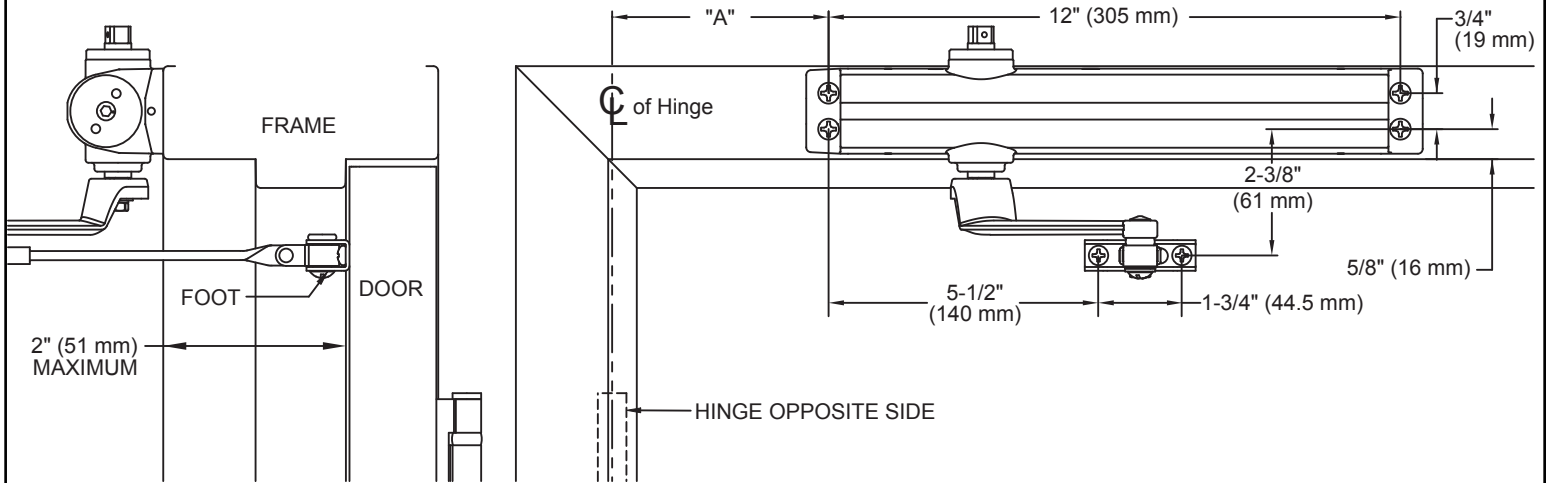

MODEL	DIMENSION "A"		OPENING	DOOR WIDTH		CLOSER SIZE	# OF TURNS OF POWER ADJUSTMENT SCREW	CLOSER SIZE	# OF TURNS OF POWER ADJUSTMENT SCREW
	INCHES	[mm]		INTERIOR	EXTERIOR				
UH4061 UH4062	7-1/2"	191	TO 100°	UP TO 60"	UP TO 48"	6	+12	3	0
						5	+9	2	-5
						4	+4	1	-9
	6"	152	TO 130°	UP TO 60"	UP TO 48"	6	+14	3	0
						5	+10	2	-4
						4	+5	1	-9
4-1/2"	114	TO 180°	UP TO 54"	UP TO 42"	5	+10	3	0	
					4	+5	2	-5	
							♿	-10/-11	

Notes: Closer is shipped at 11 turns. Maximum of 26 turns of power adjustment screw. Refer to Page 6, Fig. 5 to determine proper closer size.

INSTALLATION SEQUENCE

1. Select degree of opening and use dimensions shown to locate 4 holes on frame face for closer body and 2 holes on door for forearm shoe.
2. Prepare door and frame for fasteners (See Preparation for Fasteners, Page 2, Figure 2).
3. Before installing closer body, set spring power for closer using Power Adjustment Chart above.
4. Install closer on frame (outside of door) with speed regulating valves towards the hinge.
5. Disassemble forearm from main arm by removing forearm screw (See Page 2, Figure 1). Fasten forearm shoe and forearm to door face.
6. Mount main arm onto closer pinion shaft, as illustrated. Secure with main arm screw.
7. Reassemble arm. Adjust forearm length so that it will be perpendicular (at a 90° angle) to the door face. Secure with forearm screw.
8. Adjust closer (See page 6) and install cover.

MAIN ARM INSTALLATION INSTRUCTIONS

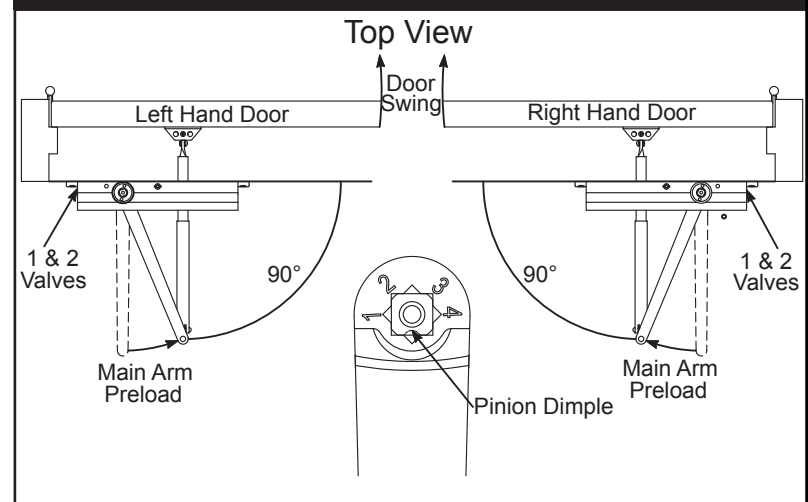

PARALLEL ARM INSTALLATION

999-30027

MODEL UH4061 or UH4062 INSTALLATION INSTRUCTIONS

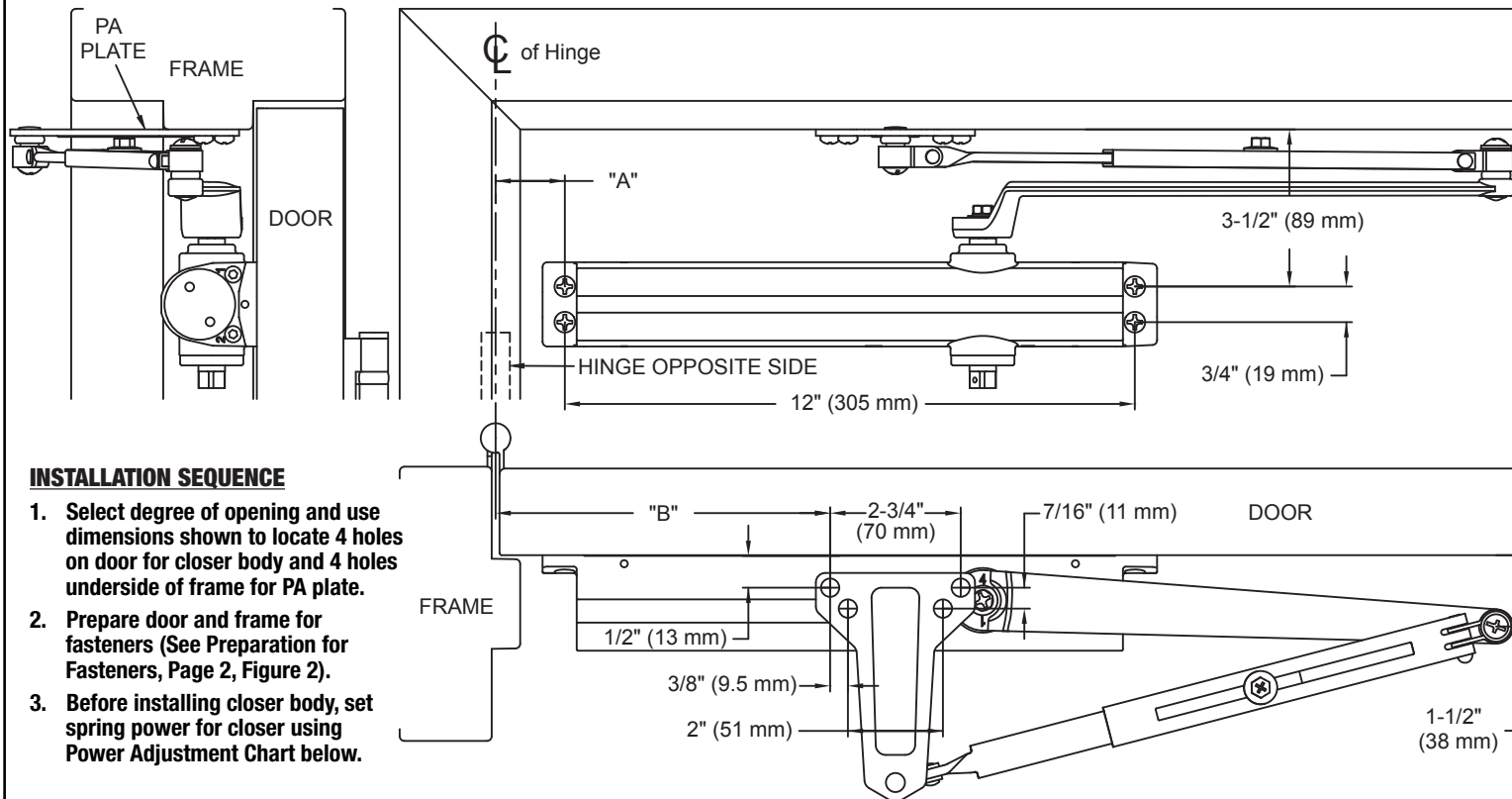

INSTALLATION SEQUENCE

1. Select degree of opening and use dimensions shown to locate 4 holes on door for closer body and 4 holes underside of frame for PA plate.
2. Prepare door and frame for fasteners (See Preparation for Fasteners, Page 2, Figure 2).
3. Before installing closer body, set spring power for closer using Power Adjustment Chart below.

MODEL	DIMENSION "A"		DIMENSION "B"		OPENING	DOOR WIDTH		CLOSER SIZE	# OF TURNS OF POWER ADJUSTMENT SCREW
	INCHES	[mm]	INCHES	[mm]		INTERIOR	EXTERIOR		
UH4061 UH4062	3-3/4"	95	9-1/2"	241	TO 120°	UP TO 54"	UP TO 42"	5	+13
								4	+6
								3	0
								2	-5
UH4061 UH4062	1-1/4"	32	7"	178	TO 180°	UP TO 54"	UP TO 42"	5	+13
								4	+7
								3	0
								2	-4
								♿	-10

Notes: Closer is shipped at 11 turns. Maximum of 26 turns of power adjustment screw. Refer to Page 6, Fig. 5 to determine proper closer size.

4. Install closer on push side of door with power adjustment valve towards the hinge.
5. Mount parallel arm plate to frame. Disassemble forearm from main arm by removing forearm screw. Remove forearm shoe from forearm and attach forearm to parallel plate with forearm screw (See Page 2, Figure 1).
6. Mount main arm onto closer pinion shaft (See Main Arm Installation Instructions) by preloading pinion 45° and align pinion dimple with main arm marking. Secure with main arm screw.
7. Reassemble arm. Adjust forearm length so that main arm pivot is 1-1/2" (38mm) from closed door face.
8. Adjust closer (See page 6) and install cover.

MAIN ARM INSTALLATION INSTRUCTIONS

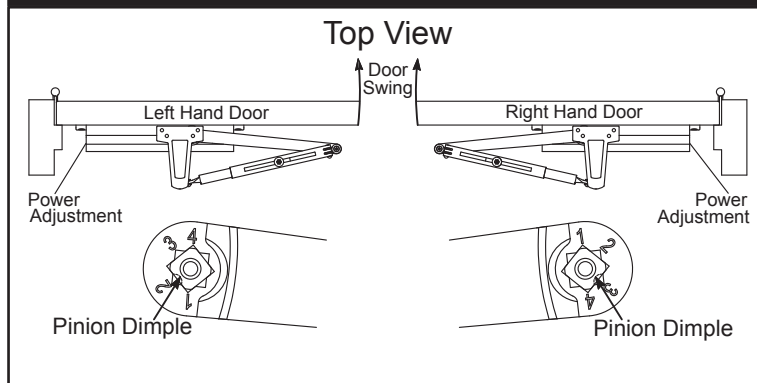

Closing Speed Controls (Figures 1 and 2)

- Valve "1" controls sweep range
- Valve "2" controls latch range

Figure 1

CLOSING SPEED - CONTROLS

Figure 2

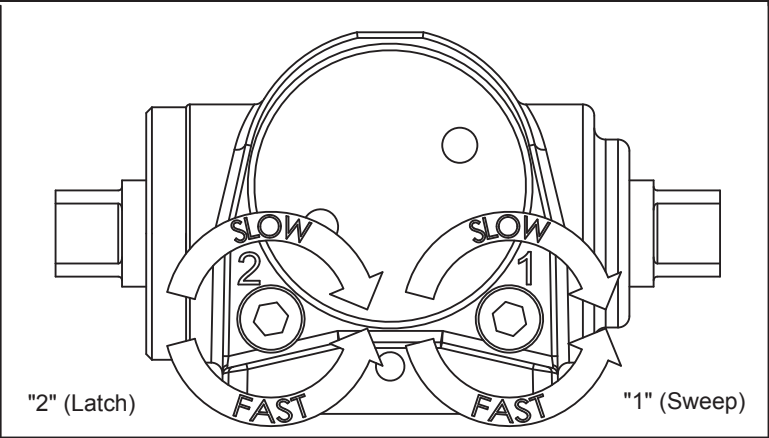
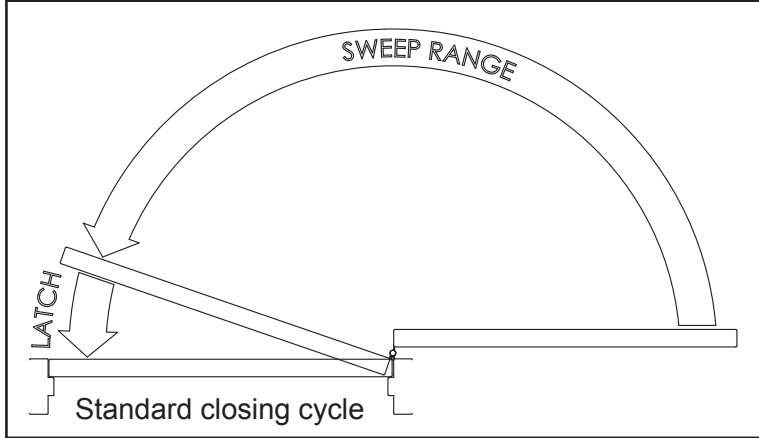

Opening Door Control (Figures 3 and 4)

Backcheck Valve controls the hydraulic resistance to door opening. It is not to provide a position stop.

Figure 3

OPENING DOOR - CONTROL

Figure 4

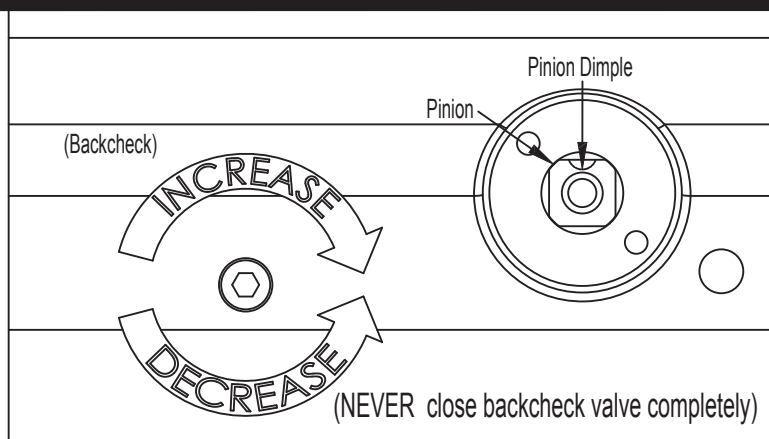
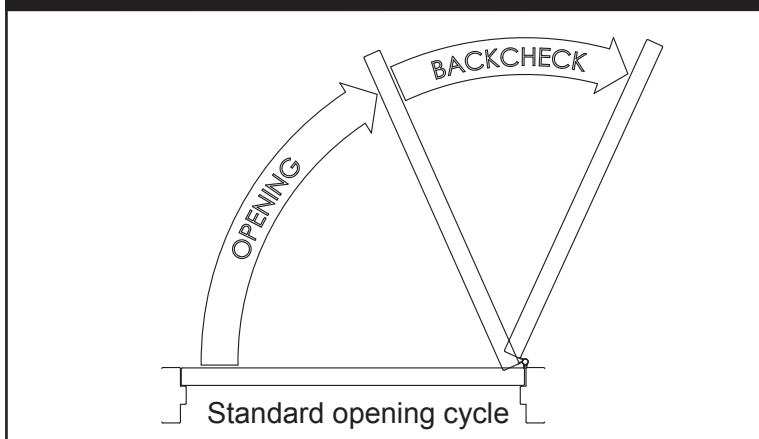

Closing Power Control (Figures 5 and 6)

Adjusted as required (see charts on pages 3, 4, & 5)

BEFORE INSTALLATION, ADJUST THE SPRING POWER BY REFERENCING BELOW AND CHECKING CHARTS ON PAGE 3, 4 OR 5 (DEPENDING ON INSTALLATION). DO NOT EXCEED THE MAXIMUM OF 26 TOTAL TURNS. THE SPRING POWER IS PRESET AT 11 TURNS

Figure 5

POWER ADJUSTMENT - CONTROL

Figure 6

EXTERIOR (and VESTIBULE) DOOR WIDTH MINIMUM DOOR WIDTH (24")						
24" (610mm)	30" (762mm)	36" (914mm)	42" (1087mm)	48" (1219mm)		
REGULAR ARM & TOP JAMB	SIZE 3	SIZE 4	SIZE 5	SIZE 6		
PARALLEL ARM	SIZE 3	SIZE 4	SIZE 5			
INTERIOR DOOR WIDTH MINIMUM DOOR WIDTH (24")						
24" (610mm)	30" (762mm)	34" (865mm)	38" (965mm)	48" (1219mm)	54" (1372mm)	60" (1524mm)
REGULAR ARM & TOP JAMB	SIZE 1	SIZE 2	SIZE 3	SIZE 4	SIZE 5	SIZE 6
PARALLEL ARM	SIZE 1	SIZE 2	SIZE 3	SIZE 4	SIZE 5	

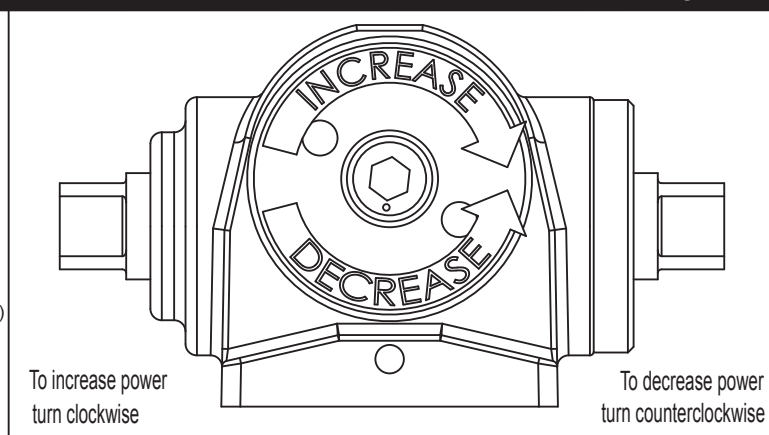

50 Icon, Foothill Ranch, CA 92610-3000
 www.hamptonproducts.com • 1-800-562-5625
 ©2020 Hampton Products International Corp.
 999-30027_UH4061-62_Eng REVC 12/20

FOR CUSTOMER CARE CALL TOLL FREE 800-562-5625 or info@hamptonproducts.com